



ENGLISH  
*Instructions*

# USE AND MAINTENANCE MANUAL

## TE130

MDB005AEN

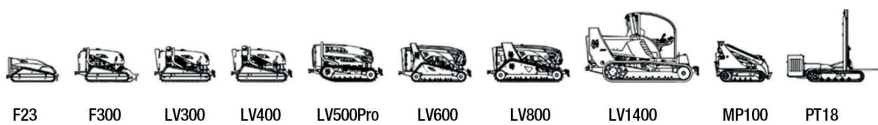
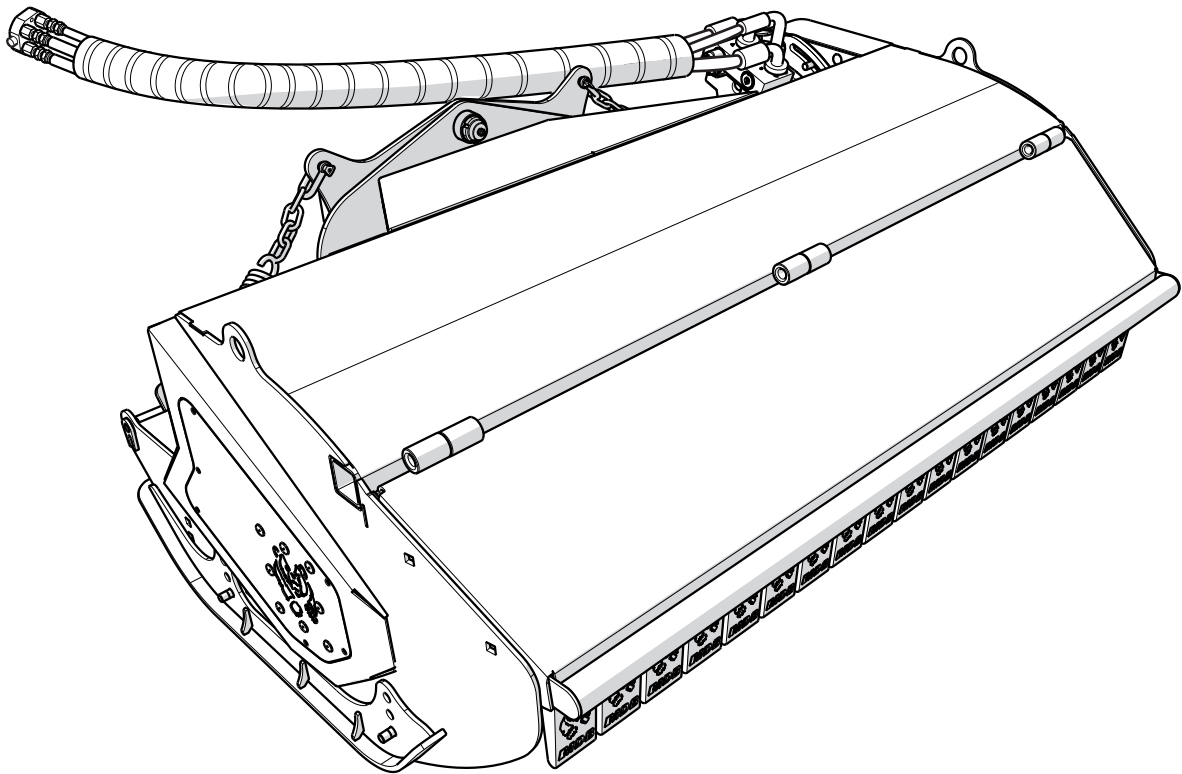

COMPANY WITH QUALITY MANAGEMENT SYSTEM CERTIFIED BY DNV GL ISO 9001:2015

## NOTICE

The device covered by this manual is defined as a "Tool".

## NOTICE

The tool only works if installed exclusively on machines supplied by MDB.  
Any other type of installation or use will void the warranty terms.

## NOTICE

This manual only covers the distinctive parts of the tool.  
For an explanation of the other parts, see the manual of the machine on which the tool is installed.

To be filled out with the specific details of the machine concerned.

	
<b>MADE IN ITALY - <a href="http://www.mdb srl.com">www.mdb srl.com</a></b>	
C.da S. Onofrio, 6/A - 66034 Lanciano (CH) ITALY Tel. (+39) 0872 50221 - 508566 - Fax (+39) 0872 50231	
<input type="radio"/> <b>Designazione:</b>	<input type="radio"/>
<b>Modello:</b>	<b>Anno:</b>
<b>Potenza:</b>	<b>Matricola:</b>
<b>Portata:</b>	<b>Peso:</b>
Conforme alle Direttive comunitarie CEE/2006/42/CE e successive implementazioni In conformity with ECC rules 2006/42/CE and subsequent implementation	
	

## NOTICE

See chapter 3 for an explanation of the fields shown on the nameplate.

## INTRODUCTION

- › Before carrying out any operation on the tool and/or on the packaging of the various parts, read the entire instruction manual carefully.
- › The instruction manual contains important information for the safety of the persons who work on the tool and for the tool itself.
- › The company that uses the tool is responsible for ensuring that all operators have fully understood the instructions for use.
- › Although the tool is equipped with active and passive safety devices, not all risks due to incorrect use can be avoided.
- › MDB assumes no responsibility whatsoever for failure to follow the safety and prevention rules described in the various sections of this manual or for damage caused by improper use of the tool. Any changes to the tool must be authorised in advance by MDB.
- › All work on the tool (maintenance, adjustments, repairs, cleaning) must be carried out by suitably trained personnel and as indicated in this manual.

**MDB reserves the right to make any technical changes to this manual and to the tool without prior notice.**

**Requests for further copies of this manual should be sent to MDB's customer service.**

**All rights reserved; reproduction prohibited.**

**This publication or parts thereof may not be reproduced, stored, transmitted, transcribed or translated into any language, common or computerised, in any form or by any means without the express written permission of MDB.**

**MDB protects its rights regarding drawings and technical documentation, in accordance with the law.**

**MDB guarantees the contents of this publication, with the express prohibition of using the publication for other purposes, of any kind, unrelated to the operation of the tool to which it refers and for which this publication was written.**

**The accuracy of the information contained herein is guaranteed provided that all the requirements stated in this documentation are strictly observed by the user.**

## NOTICE





# CONTENTS

<b>1 SAFETY</b>	<b>1-1</b>
<b>2 GENERAL INFORMATION</b>	<b>2-1</b>
<b>3 TOOL CHARACTERISTICS</b>	<b>3-1</b>
3.1 NAMEPLATE .....	3-1
3.2 DESCRIPTION .....	3-2
3.2.1 <i>List of units</i> .....	3-3
3.3 TECHNICAL SPECIFICATIONS .....	3-4
3.3.1 <i>Dimensions</i> .....	3-4
3.3.2 <i>Weight</i> .....	3-4
3.3.3 <i>Other technical specifications</i> .....	3-4
3.4 WORK AREA .....	3-5
3.4.1 <i>Operator position</i> .....	3-6
3.4.2 <i>Tool direction points</i> .....	3-7
3.5 RUNNING IN .....	3-7
3.6 SAFETY SIGNS .....	3-8
3.7 SAFETY DEVICES .....	3-9
3.8 PROFESSIONAL USER PROFILES .....	3-10
3.8.1 <i>Operator</i> .....	3-10
3.8.2 <i>Maintenance technician</i> .....	3-11
3.9 PERMITTED USES .....	3-11
3.10 NON-INTENDED USES .....	3-11
3.11 NOISE LEVEL .....	3-11
3.12 PERSONAL PROTECTIVE EQUIPMENT .....	3-12
3.13 DOCUMENTATION .....	3-12
3.14 ANNEXES .....	3-12
3.15 RESIDUAL RISKS .....	3-13
<b>4 UNPACKING, LIFTING AND TRANSPORT</b>	<b>4-1</b>
4.1 UNPACKING .....	4-2
4.2 LIFTING .....	4-4
4.2.1 <i>Lifting with a crane, hoist or bridge crane</i> .....	4-5
4.3 TRANSPORT .....	4-6
<b>5 OPERATION AND USE</b>	<b>5-1</b>
5.1 CONTROL PANEL .....	5-1
5.2 REMOTE CONTROL .....	5-2
5.2.1 <i>Description of the remote control</i> .....	5-2
5.3 PRE-START CHECKS .....	5-3



5.4	START-UP .....	5-3
5.5	USE .....	5-4
5.5.1	<i>Main controls</i> .....	5-4
5.5.2	<i>Safety guidelines for use</i> .....	5-6
5.5.3	<i>Cutting</i> .....	5-7
5.5.4	<i>Adjustments</i> .....	5-8
5.6	PARKING .....	5-10
5.7	ATTACHING/DETACHING THE TOOL .....	5-11
5.7.1	<i>Attaching the tool</i> .....	5-11
5.7.2	<i>Detaching the tool</i> .....	5-14
5.8	SHUTDOWN .....	5-16

## 6 MAINTENANCE 6-1

6.1	PREPARING FOR MAINTENANCE .....	6-1
6.1.1	<i>Front casing</i> .....	6-2
6.2	EQUIPMENT SUPPLIED .....	6-2
6.3	SCHEDULED MAINTENANCE TABLE .....	6-3
6.3.1	<i>Checklist</i> .....	6-4
6.4	ROUTINE MAINTENANCE .....	6-6
6.4.1	<i>General checks</i> .....	6-6
6.4.2	<i>General tool cleaning</i> .....	6-6
6.4.3	<i>Checking wear on the connection plate spacer</i> .....	6-7
6.4.4	<i>Checking transmission belt tension</i> .....	6-8
6.4.5	<i>Adjusting transmission belt tension</i> .....	6-9
6.4.6	<i>Replacing the transmission belts</i> .....	6-10
6.4.7	<i>Checking the knives for wear</i> .....	6-11
6.4.8	<i>Replacing the knives</i> .....	6-12
6.4.9	<i>General periodic lubrication</i> .....	6-13
6.4.10	<i>Periodic rotor lubrication</i> .....	6-14
6.4.11	<i>Checking tightening elements</i> .....	6-15
6.4.12	<i>Checking the hydraulic system</i> .....	6-15
6.5	SPECIAL MAINTENANCE .....	6-16
6.6	PERIODIC CHECK AND INSPECTION LOG .....	6-17

## 7 TROUBLESHOOTING 7-1

7.1	TROUBLESHOOTING GUIDE .....	7-1
7.1.1	<i>Rotor</i> .....	7-1
7.1.2	<i>Hydraulic system</i> .....	7-2
7.1.3	<i>Transmission</i> .....	7-2
7.1.4	<i>Work devices</i> .....	7-2

## 8 DISMANTLING 8-1

8.1	TEMPORARY DECOMMISSIONING .....	8-1
8.2	PERMANENT DECOMMISSIONING - DISMANTLING .....	8-1



# 1 SAFETY

## NOTICE

For the information regarding this chapter, see the manual of the machine on which the tool is installed.





## **2** GENERAL INFORMATION

### **NOTICE**

For the information regarding this chapter, see the manual of the machine on which the tool is installed.



### 3 TOOL CHARACTERISTICS

#### 3.1 NAMEPLATE

The nameplate is affixed to the tool in the area shown in the figure.

The nameplate displays the following details:

Description	Tool type
Model	Tool model
Power	Engine power (kW)
Capacity	Maximum tool capacity (Kg)
Year:	Year of tool manufacture
Serial number	Tool identification serial number
Weight	Tool weight (Kg)

#### NOTICE

For the specific data of the tool concerned, see the figures shown on the inside front cover of this manual.

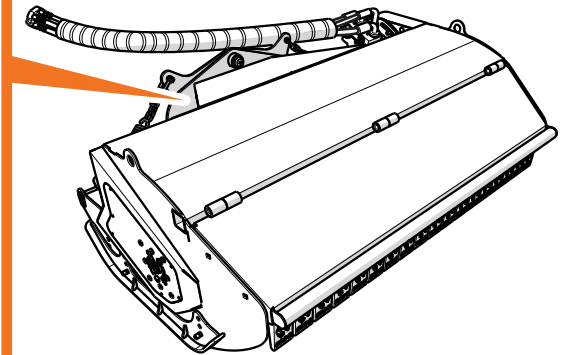

#### NOTICE

The CE marking is affixed only within the European Community or in cases where it is required.



### 3.2 DESCRIPTION

The tool is designed for cutting vegetation with the characteristics described in paragraph "3.9 Permitted uses" and paragraph "3.3 Technical specifications".

The tool control operations are performed by means of a remote control device (forming part of the machine on which the tool is installed) that allows the operator to operate it from a distance.

The remote control allows the operator to work with complete peace of mind, by following the indications on the operator's position given in paragraph "3.4.1 Operator position".

## NOTICE

**For an explanation and use of the remote control, see the manual of the machine on which the tool is installed.**

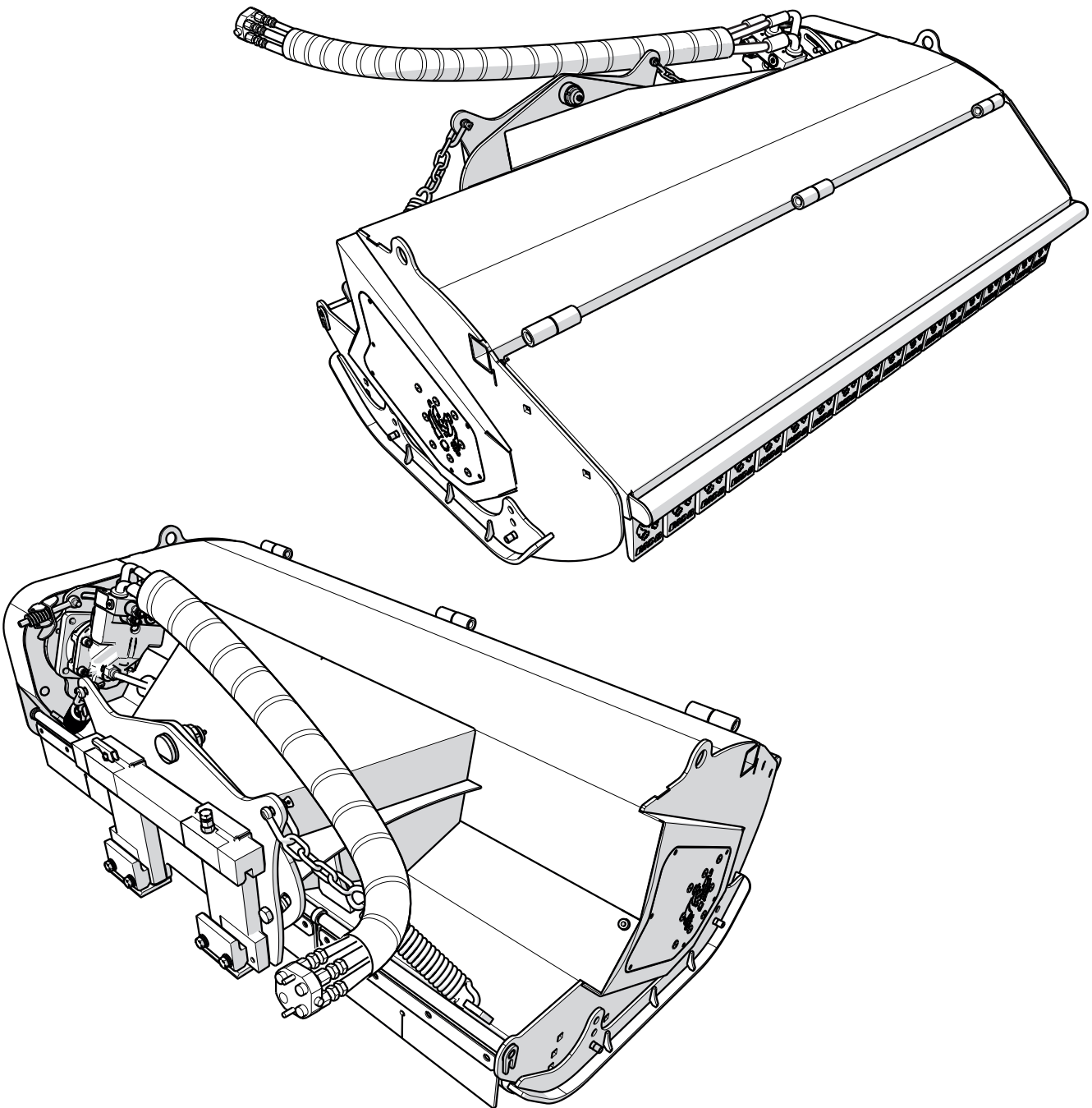

3.2.1 LIST OF UNITS

- |                        |                             |
|------------------------|-----------------------------|
| 1 Engine               | 8 Front guards              |
| 2 Connection tubes     | 9 Rear guards               |
| 3 Transmission belts   | 10 Front casing             |
| 4 Transmission pulleys | 11 Support runners          |
| 5 Rotor                | 12 Connection plate         |
| 6 Knives               | 13 Connection plate springs |
| 7 Compactor roller     | 14 Parking feet             |

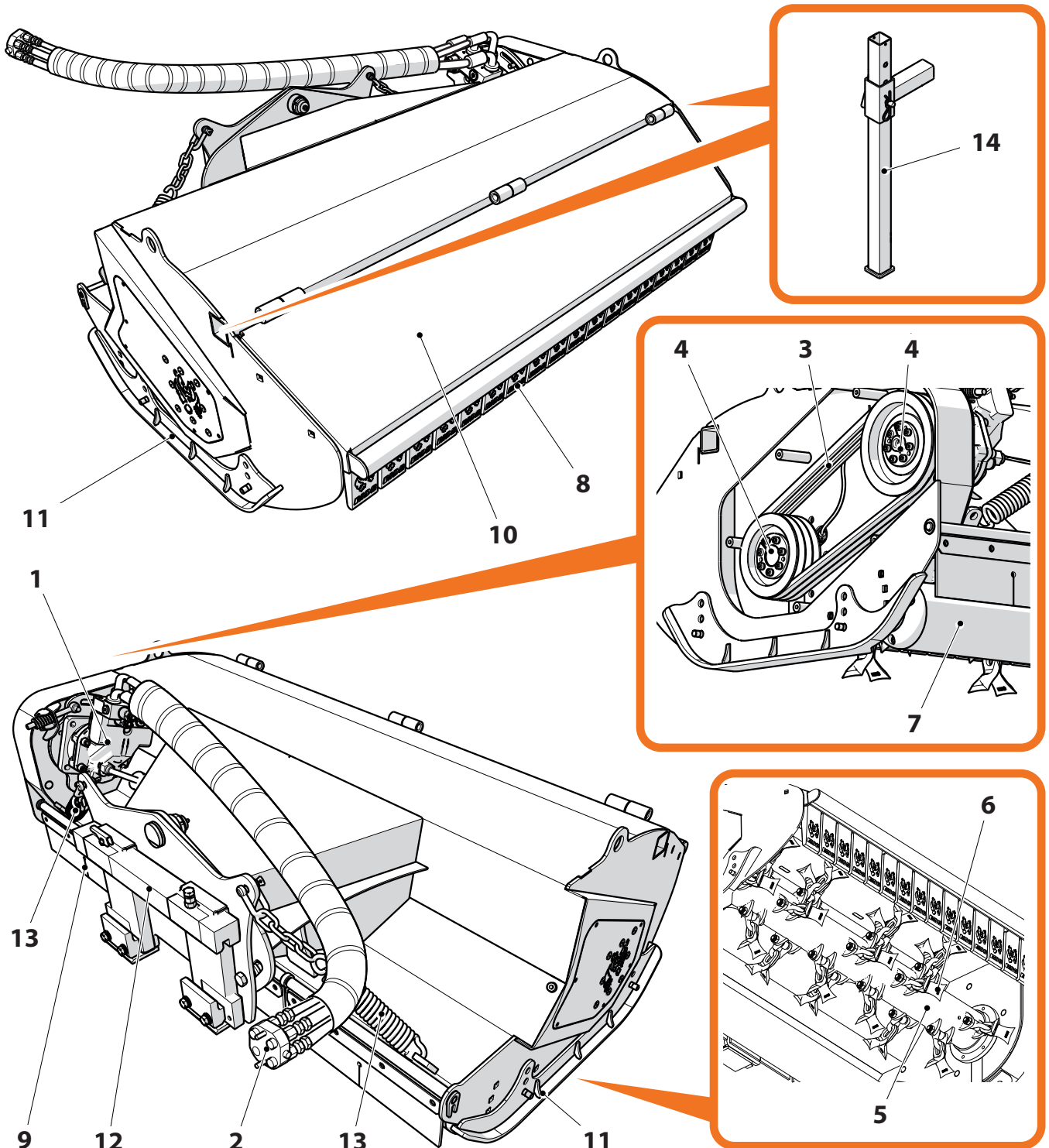



### 3.3 TECHNICAL SPECIFICATIONS

#### 3.3.1 DIMENSIONS

The dimensions of the tool are shown in the figure.

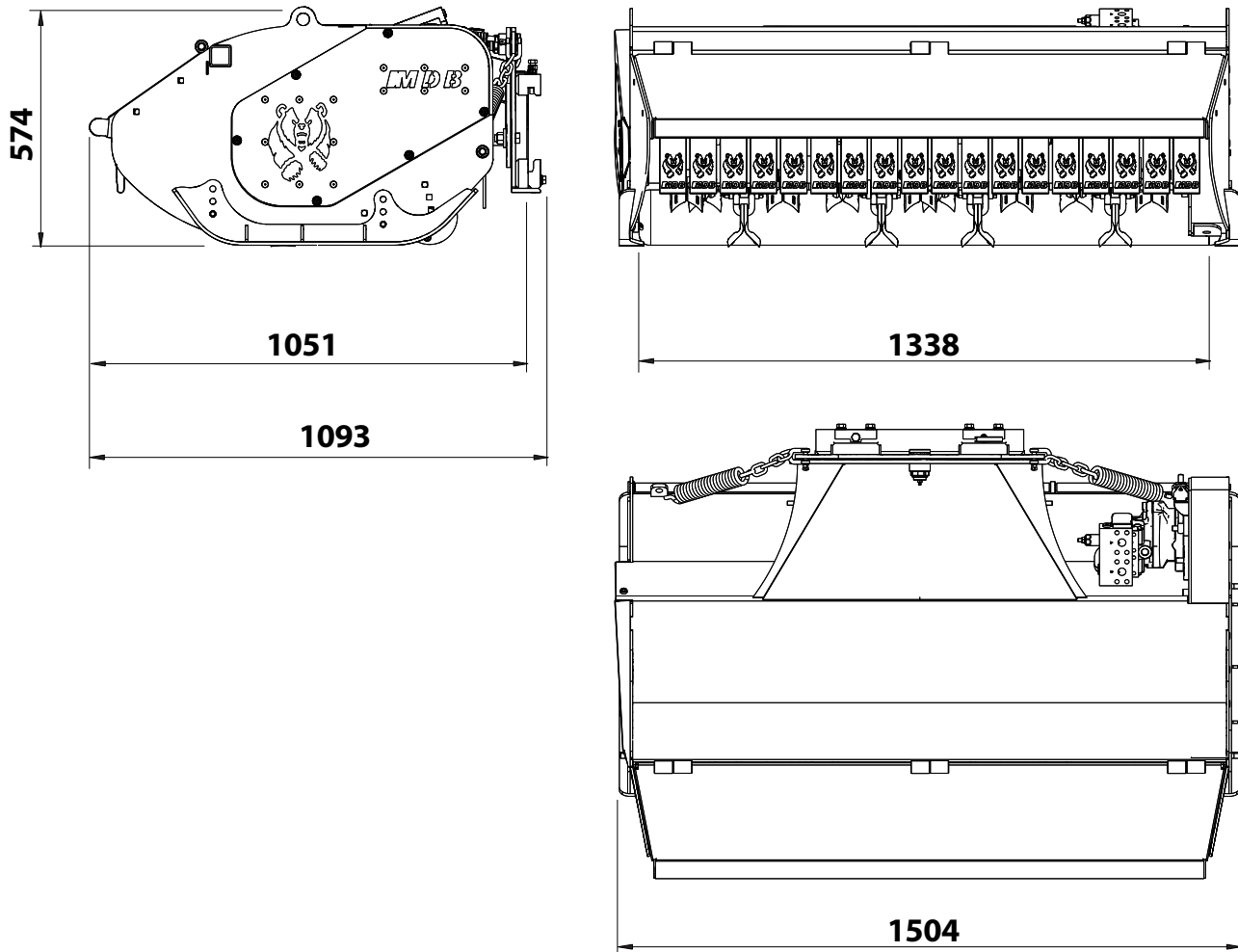

#### 3.3.2 WEIGHT

For this information, see the figures given on the inside front cover of this manual.

#### 3.3.3 OTHER TECHNICAL SPECIFICATIONS

Knives	52
Rpm	2800 - 3300
Hydraulic oil type	For this information, see the manual of the machine on which the tool is installed.
Type of grease for periodic lubrication	PRESSOL NLG1 2



### 3.4 WORK AREA

The work area **A**, where the tool and the machine on which it is installed operate, must be cordoned off by appropriate signalling devices before the start of the work.



**DANGER**

During use, the work area **A** is out-of-bounds to all people.

The minimum distance (**Y**) from the tool to the end of the work area, in the area in front of the tool (**V**), is 50 metres.

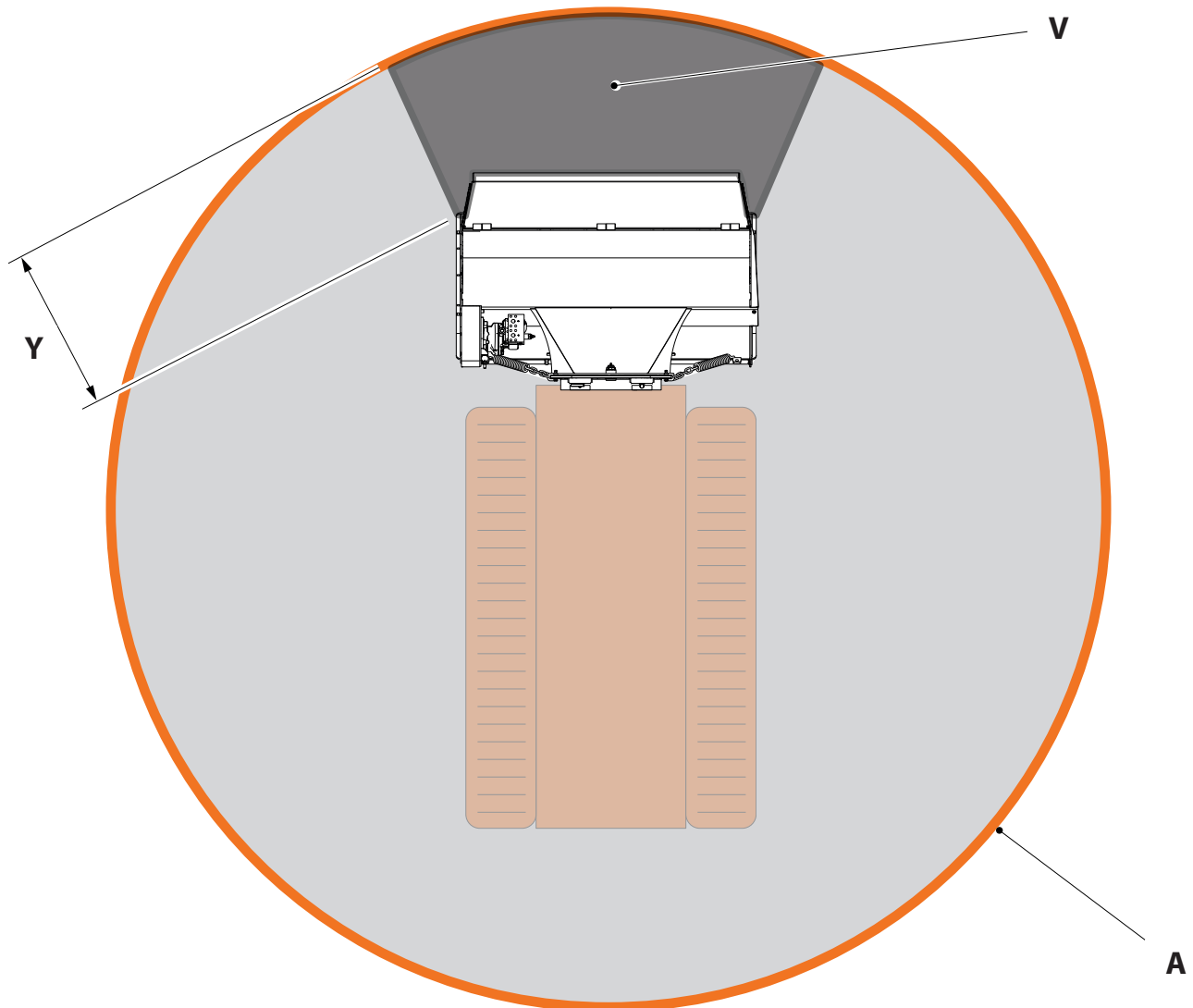



### 3.4.1 OPERATOR POSITION

The operator controls the tool and the machine on which it is installed with the remote control unit, and must remain at a minimum required distance **X** of **3 metres** from it, positioned as shown in the figure.

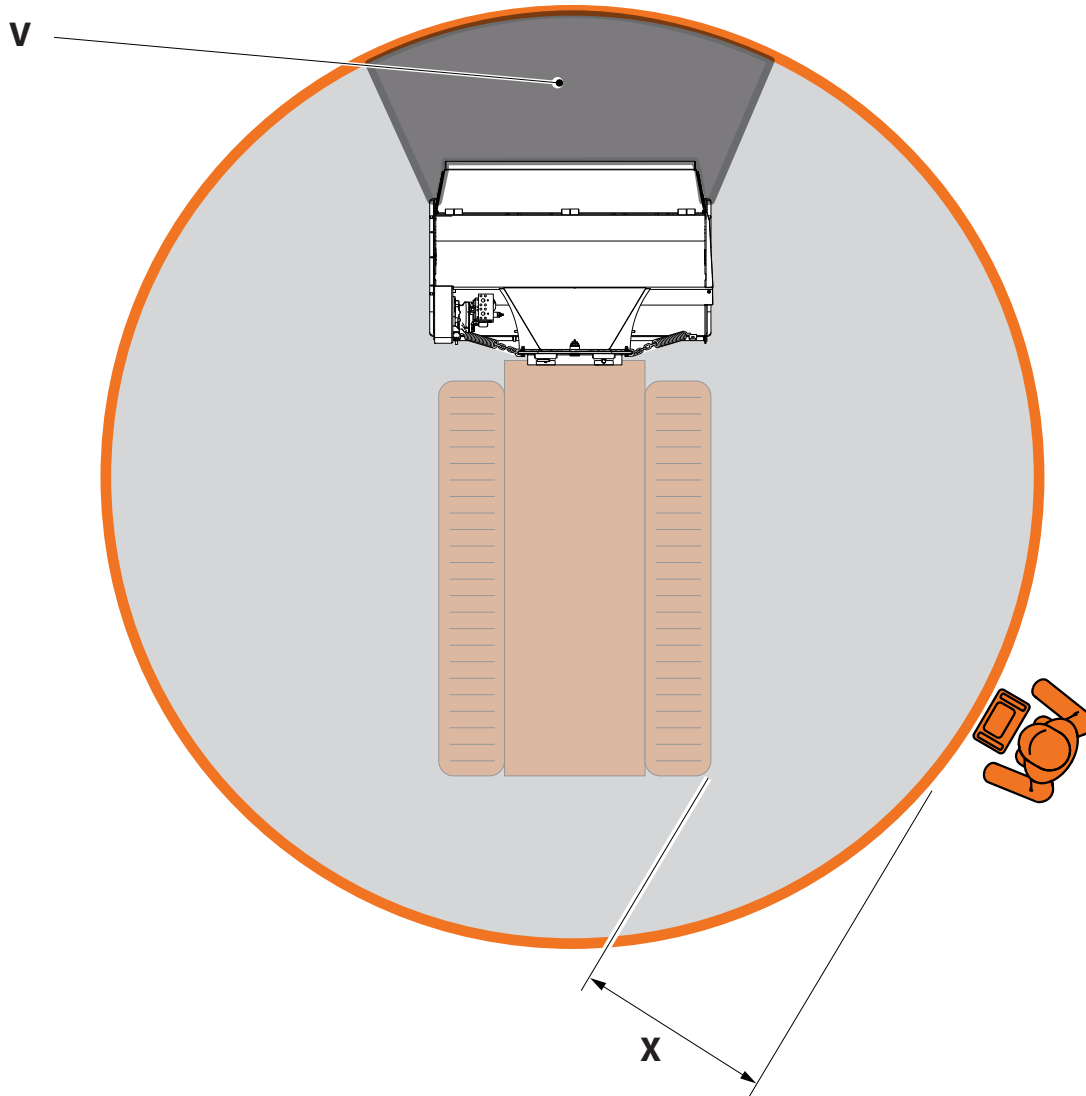

**DANGER**

The area in front of the tool (V) poses a thrown-object hazard due to the rotation of the rotor. For this reason, the operator must always be positioned as shown in the figure.



Wear the required personal protective equipment, as indicated in paragraph "3.12 Personal protective equipment".

**NOTICE**

For the remaining information on the operator's position, see the manual of the machine on which the tool is installed.

### 3.4.2 TOOL DIRECTION POINTS

In this manual, the terms **Forward/Front (1)**, **Back/Rear (2)**, **Left (3)** and **Right (4)** refer to the tool's travel directions, as shown in the figure

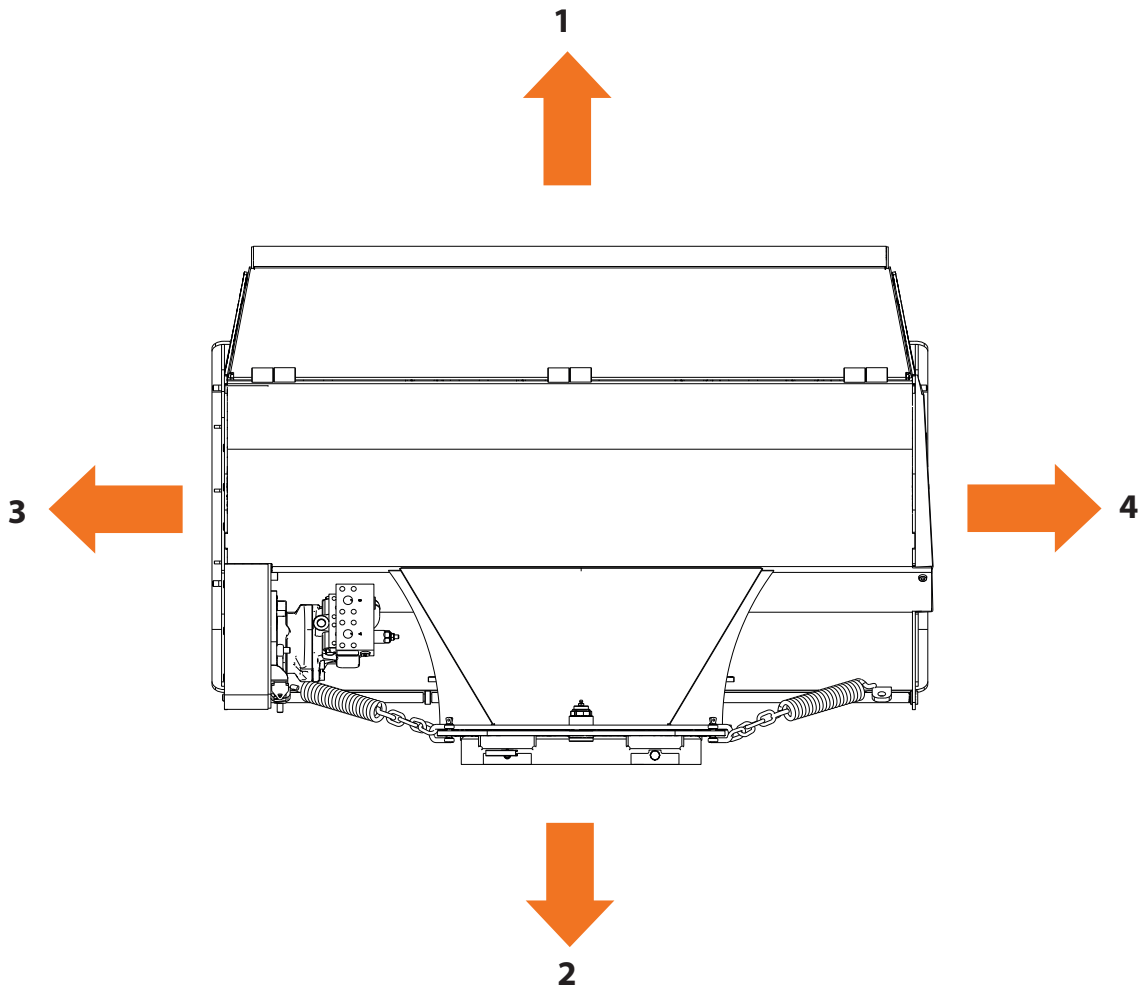

### 3.5 RUNNING IN

#### NOTICE

**Each tool is carefully adjusted and tested before delivery.**

**A new tool must be used with caution for the first hours of operation.**

Each new tool must be used carefully, particularly with regard to the following points:

- › After starting, let the engine run at idle speed for a few minutes in order to allow it to gradually warm up (see chapter 5 of this manual and chapter 5 of the manual of the machine on which the tool is installed).
- › Avoid operating the tool at the limit of the permitted loads or at high speed (see chapter 5 of this manual and chapter 5 of the manual of the machine on which the tool is installed).



3.6 SAFETY SIGNS

<p>1</p>	<p>2</p>	<p>3</p>	<p>4</p>
<p>5</p> <p>⚠ ATTENZIONE ⚠          APRIRE ESCLUSIVAMENTE PER INTERVENTI DI RIPARAZIONE E MANUTENZIONE A MACCHINA FERMA E TASSATIVAMENTE A MOTORE SPENTO. L'AZIENDA DECLINA OGNI RESPONSABILITÀ PER EVENTUALI DANNI O CONSEGUENZE DERIVANTI DA UN UTILIZZO IMPROPRIO.</p> <p>⚠ CAUTION ⚠          OPEN ONLY FOR REPAIRS AND MAINTENANCE WITH MACHINE IN STATIONARY POSITION AND STRICTLY WITH ENGINE OFF. THE MANUFACTURER DECLINES ANY LIABILITY FOR ANY DAMAGES OR CONSEQUENCES RESULTING FROM IMPROPER USE.</p> <p>⚠ ACHTUNG ⚠          NUR ZUR REPARATUR UND INSTANDHALTUNG, MIT MASCHINE IM RUHEZUSTAND UND UNBEDINGT MIT ABGESTELLTEM MOTOR, ÖFFNEN. DAS UNTERNEHMEN LEHNT JEGLICHE HAFTUNG FÜR SCHADEN ODER FOLGEN DURCH UNSACHGEMESSENEN GEBRAUCH.</p>	<p>6</p> <p>⚠ ATTENZIONE ⚠  <b>ATTENZIONE          ACHTUNG</b></p> <p>NON SOSTARE O PASSARE NEL          RAGGIO DI AZIONE DELLA MACCHINA</p> <p>DO NOT STAY NEAR OR PASS BY THE          WORKING AREA OF THE MACHINE</p> <p>NICHT IM ARBEITSBEREICH          DER MASCHINE AUFHALTEN</p>	<p>7</p> <p><b>WARNING</b></p> <p><b>HIGH-PRESSURE FLUID HAZARD</b>          To prevent serious injury or death:          - Relieve pressure on system before repairing or adjusting or disconnecting.          - Wear proper hand and eye protection when searching for leaks. Use wood or cardboard instead of hands.          - Keep all components in good repair.</p>	
<p>8</p>			<p>9</p>

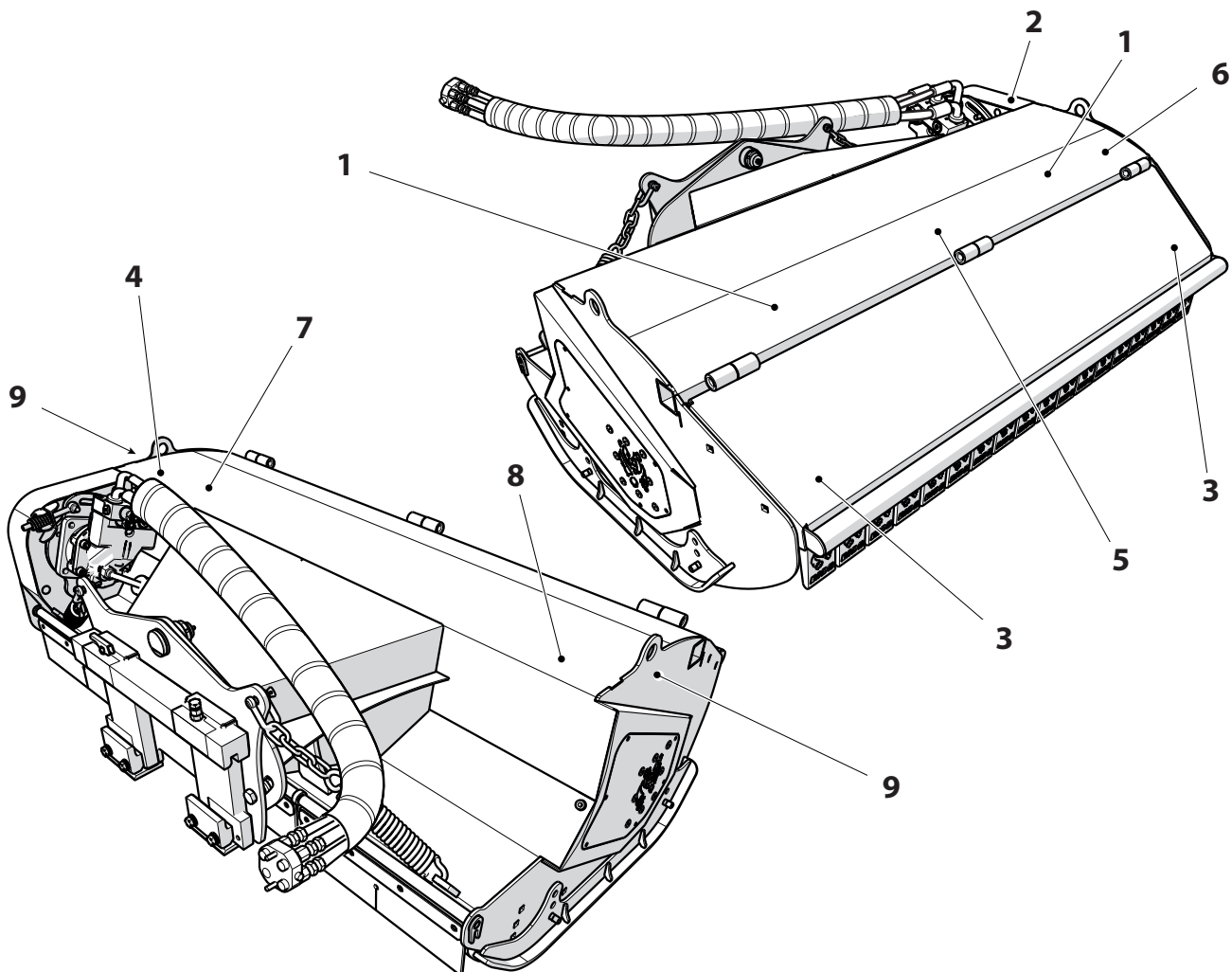

### 3.7 SAFETY DEVICES

- 1 Front guards
- 2 Rear guards
- 3 Front casing
- 4 Transmission casing
- 5 Connection plate locking latch
- 6 Connecting plate locking screw
- 7 Motor safety lung

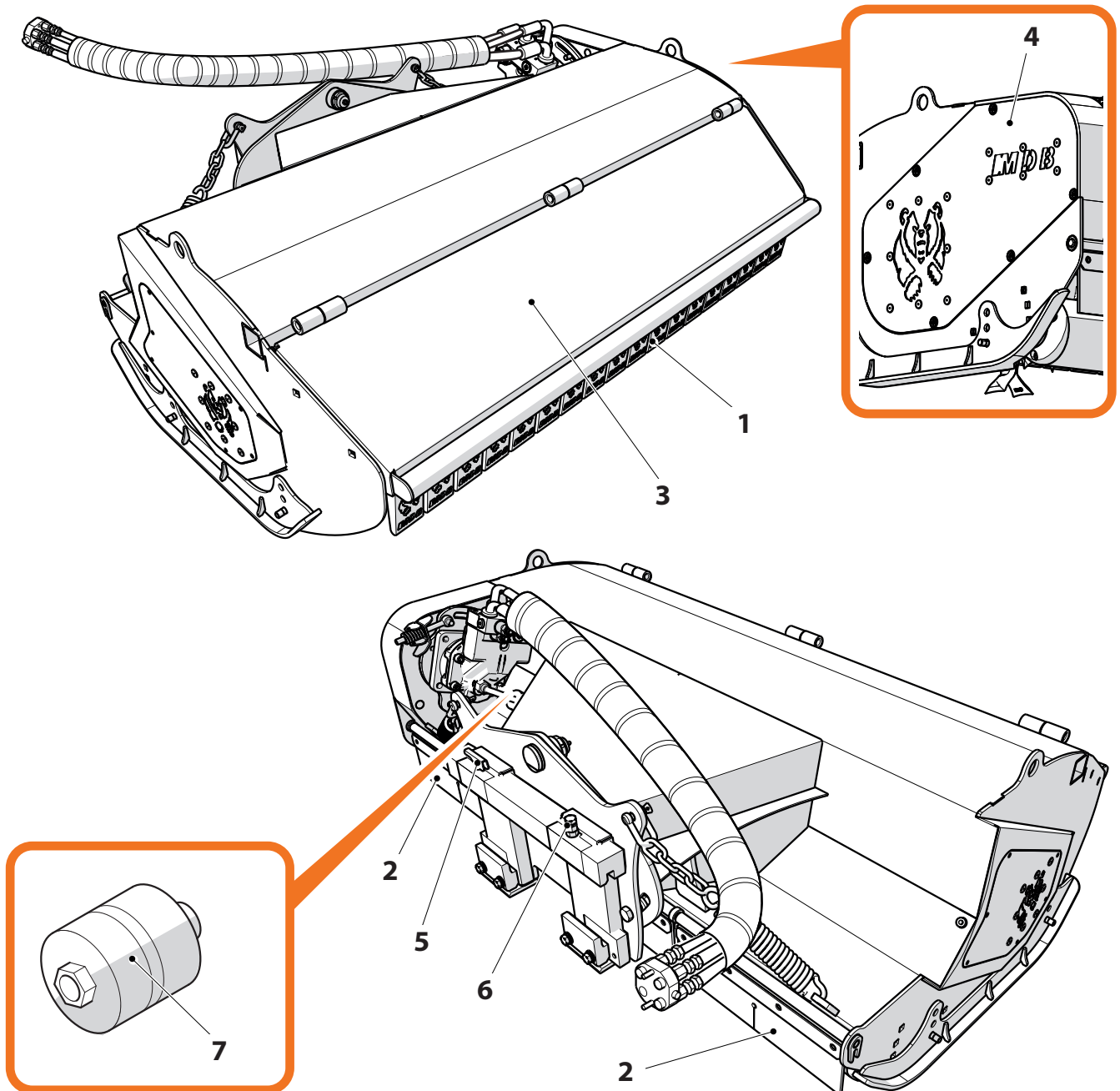



### 3.8 PROFESSIONAL USER PROFILES

The tool is designed for professional use.

The End customer is responsible for ensuring that the persons assigned to the various tasks:

- › Read and understand the manual.
- › Receive adequate instruction and training for their assigned tasks, in order to perform them safely.
- › Receive specific training for correct use of the tool.
- › Use all the accident prevention equipment necessary for their safety, as required by current laws on health and safety in the workplace.
- › Receive specific training to deal with any emergencies due to injuries to personnel.

#### 3.8.1 OPERATOR

This type of tool can only be used by an experienced person (referred to as an operator) trained with regard to the limits of use and residual risks.

For the operating specifications, follow the national provisions of the country where the tool is used.



**DANGER**

**Use of drugs, alcohol or medicines that affect the reflexes undermine the ability to use the tool!**

**Persons under the influence of these substances are not authorised to perform any work or to use the tool.**

The operator must have:

- › Knowledge of the tool's technology and specific experience of its operation.
- › Sufficient basic general and technical knowledge to read and understand the contents of the manual, including correct interpretation of the drawings.
- › Knowledge of the accident prevention regulations in force in the country where the tool is used:
  - › General regulations (occupational health and safety, prevention of work accidents).
  - › Specific regulations (for the type of tool).

#### OPERATOR'S AREA OF COMPETENCE

**NOTICE**

**The operator is responsible for the tool during working hours. He cannot allow unauthorised persons to operate the tool.**

The operator is only allowed to use the controls and instrumentation provided on the control panel and on the remote control of the machine on which the tool is installed (see the manual of the machine on which the tool is installed).

The operator's working position is indicated in paragraph "3.4.1 Operator position".



### 3.8.2 MAINTENANCE TECHNICIAN

The maintenance technician must have:

- › The necessary specific and specialised technical knowledge (mechanical, electrical, pneumatic, etc.) to safely carry out the operations for which he is responsible, as specified in this instruction manual, using suitable devices.
- › Sufficient basic general and technical knowledge to read and understand the contents of the manual, including correct interpretation of the drawings.
- › Knowledge of the accident prevention regulations in force in the country where the tool is used:
  - › General regulations (occupational health and safety, prevention of work accidents).
  - › Specific regulations (for the type of tool).

### MAINTENANCE TECHNICIAN SKILLS

The maintenance technician is permitted to perform the routine maintenance operations indicated in this instruction manual, within the limits of his competence in mechanical, electrical, pneumatic and other fields.

### 3.9 PERMITTED USES

The tool is designed for cutting grass and/or brambles.  
The tool must only be used in a ventilated environment.

### 3.10 NON-INTENDED USES

No other use is envisaged (other than those specified in the preceding paragraph), unless expressly authorised by MDB.  
MDB disclaims any and all liability for malfunctions or damage to persons or property due to uses other than those indicated in this manual.

### 3.11 NOISE LEVEL



## WARNING



**The operator must wear the required personal protective equipment (hearing protection), in accordance with the legislation in force in the country where the tool is used.**



### 3.12 PERSONAL PROTECTIVE EQUIPMENT

#### NOTICE

The employer is obliged to provide personal protective equipment and to instruct the personnel on its correct use and maintenance.

The operator and/or maintenance technician must use the following personal protective equipment for all tool use and maintenance operations.



**PROTECTIVE GLOVES**



**PROTECTIVE VISOR**



**PROTECTIVE CLOTHING**



**SAFETY FOOTWEAR**



**HEARING PROTECTION**



**SAFETY HELMET**

#### NOTICE

Avoid wearing loose clothing, jewellery or other objects that could get caught in parts of the tool during use and maintenance.

### 3.13 DOCUMENTATION

The tool's technical documentation and annexes are kept in a provided folder placed inside the packaging.

### 3.14 ANNEXES

The following documents complete this instruction manual:

Annex A - Declaration of conformity

Annex D - Tool parts catalogue



### 3.15 RESIDUAL RISKS



#### CAUTION

Pay attention to the operating range of the tool.

Avoid sudden manoeuvres (acceleration, deceleration or steering).

Do not use in adverse weather conditions.

Removal of nameplates and labels from the tool is prohibited.

The user is required to keep clean initials, nameplates and labels clean and restore them if they become illegible.



#### WARNING

Do not use for towing operations.

During manoeuvres, keep away from other obstacles.

Take the appropriate precautions when working on the engine.

The knives pose a cutting hazard: keep limbs away from the working area of the knives.

Do not lift people.

Performing any kind of control, repair or maintenance operations on moving parts is prohibited.

When running, the engine and hydraulic system components can reach temperatures capable of causing slight burns. Wait for the machine to cool down or take appropriate precautions (gripping tools, gloves, etc.) before carrying out work.



#### DANGER

Many lubricants are flammable. Check for flammability and toxicity before use. Follow the supplier's instructions, particularly with regard to storage, disposal and emergency procedures.

Store flammable fluids away from any contact with fire.

Do not burn or puncture pressurised containers.

Do not store rags soaked in flammable material, as they may ignite and/or burn spontaneously.

Some areas in the vicinity of the tool pose a thrown-object hazard, as indicated in paragraph "3.4.1 Operator position". For this reason, strictly observe the permitted operator position.





## 4 UNPACKING, LIFTING AND TRANSPORT

Unpacking, lifting and transport operations must only be carried out by specialised personnel authorised for these types of manoeuvres.

There must be no people in the vicinity of the suspended load and/or within the range of movement of the lifting device during the unpacking, lifting and transport of the load.



### CAUTION

Manual handling of loads must be carried out by personnel trained in the proper lifting methods and following the safety provisions laid down in the laws in force in the country where the tool is used.

MDB declines all liability for damage to persons or property due to failure to comply with current safety regulations with regard to the lifting and handling of the load inside the user's factory.



## 4.1 UNPACKING

### NOTICE

The package, upon arrival at the user's premises, must be handled with the utmost care and moved, both outdoors and indoors, with lifting devices of adequate capacity, in accordance with the indications given on the packaging and/or on the documents accompanying the package.

### CAUTION



The operator must wear the following personal protective equipment:

- › Safety footwear
- › Protective gloves
- › Safety helmet
- › Protective clothing
- › Safety goggles

The tool is shipped packaged, in the following conditions:

- › Tool secured to a pallet **1** by means of straps **2**.
- › Tool wrapped in protective material **3** for small accidental impacts.
- › Tool also wrapped in clear film to protect it from dust, moisture and water.

### NOTICE

The folder containing the tool's technical documentation and various annexes is placed inside the packaging.

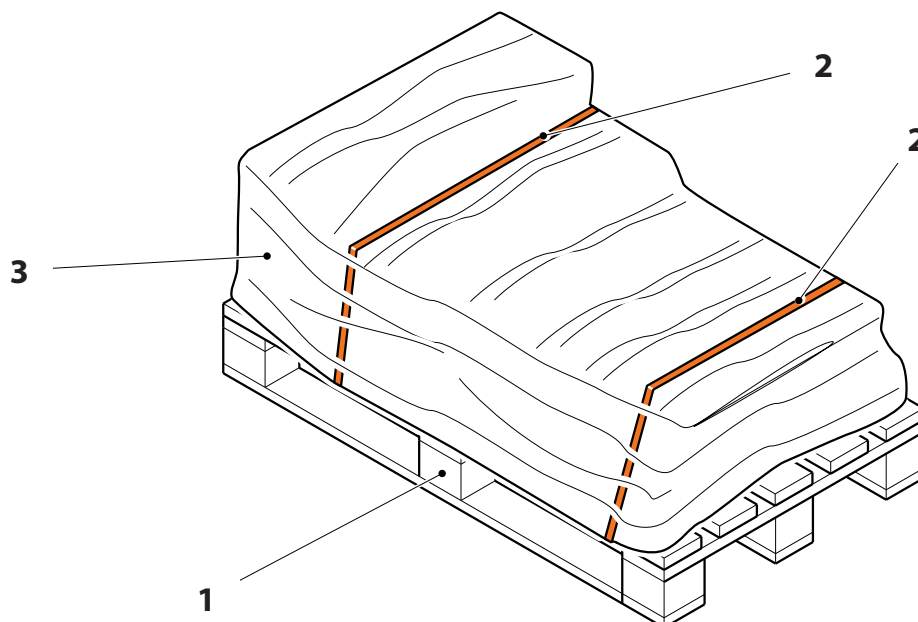

Unpack the tool as follows:

- › Move the package to the designated location, using a forklift **4** of adequate capacity.

## NOTICE

**For the weight of the tool, see the details given on the inside front cover of this manual.**



## CAUTION

**The forks must be of a suitable length to avoid imbalances in the load, which could cause overturning and consequent damage to the tool.**

- › Carefully remove the strapping **2** and protective wrapping **3** with a box cutter.
  - › Avoid damaging the tool components with the box cutter.
- › Bring the machine on which the tool will be installed to the area where the tool is parked (for the procedure, refer to chapter 5 of the manual of the machine on which the tool will be installed).
- › Attach the tool as indicated in paragraph "5.7.1 Attaching the tool".
  - › Ensure that the parking feet are removed.
- › Start the machine on which the tool is installed (see chapter 5 of the manual of the machine on which the tool will be installed for the procedure).
- › Move the machine slowly (see chapter 5 of the manual of the machine on which the tool is installed for the procedure) to remove the tool from the packaging pallet **1**.
- › Park the tool, as indicated in paragraph "5.6 Parking".
  - › The tool is parked and detached from the machine that will use it.

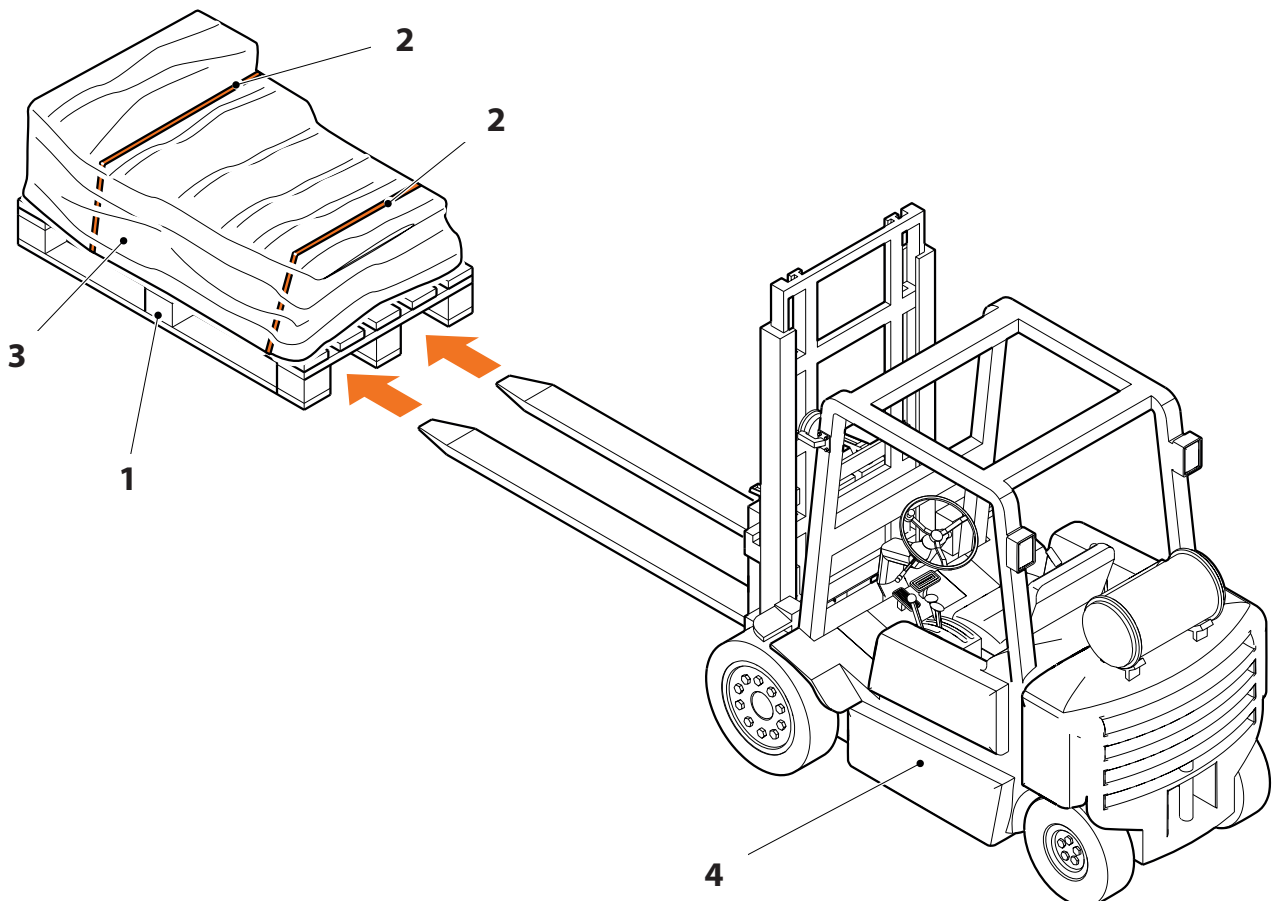



## 4.2 LIFTING

The tool can be lifted using the following methods:

- › Lifting with a crane, hoist or bridge crane



**DANGER**

The above-mentioned method may only be used for lifting the tool onto a suitable means of transport (as indicated in paragraph“4.3 Transport”). No other use is permitted.

Any type of maintenance with the tool raised off the ground is strictly forbidden.

**NOTICE**

For the weight of the tool, see the details given on the inside front cover of this manual.

### 4.2.1 LIFTING WITH A CRANE, HOIST OR BRIDGE CRANE

**CAUTION**



The lifting equipment (ropes or chains) must be adequately sized for the weight of the tool.

Lifting equipment (ropes or chains) is not supplied by MDB

The operator must wear the following personal protective equipment:

- > Safety footwear
- > Protective gloves
- > Safety helmet
- > Protective clothing
- > Safety goggles

Proceed as follows:

- > Connect the shackles **1** to the eyelets **2** on the tool.
  - > The positioning of the eyelets **2** is indicated by special pictograms **3**.
- > Connect the lifting equipment **4** (ropes or chains), to the hook **5** of the chosen lifting device (crane, hoist or bridge crane).
- > Remove the parking feet **6**.
- > Lift the tool and position yourself near the storage area.
- > Fit the parking feet **6**.
- > Lay the tool down in the storage place.

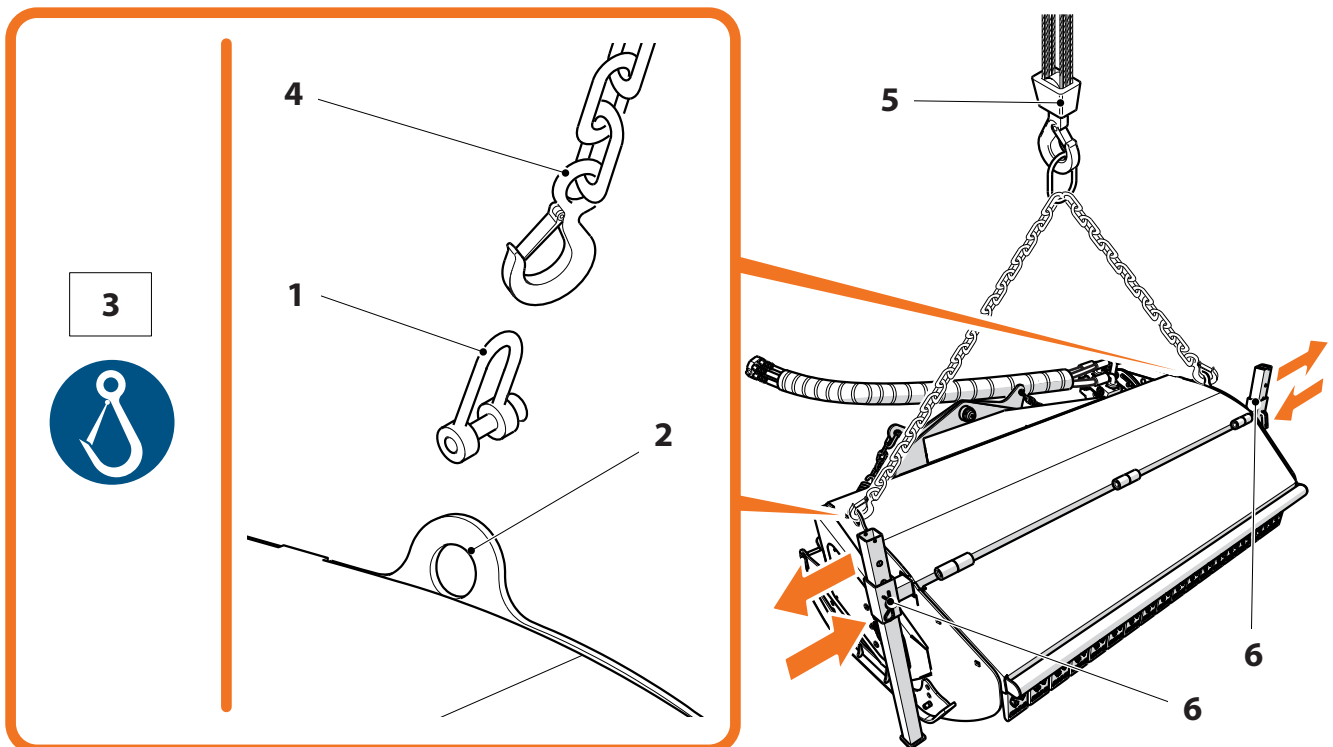



### 4.3 TRANSPORT

If necessary, the tool can be transported on a vehicle.

#### CAUTION

The vehicle must be suitably sized for the weight of the tool.

The operator must wear the following personal protective equipment:



- › Safety footwear
- › Protective gloves
- › Safety helmet
- › Protective clothing
- › Safety goggles

#### DANGER

The tool can also be loaded on/unloaded from a vehicle using the methods explained in paragraphs (“4.2.1 Lifting with a crane, hoist or bridge crane” above).

#### NOTICE

For the weight of the tool, see the details given on the inside front cover of this manual.

To load the tool, proceed as follows:

- › Lift, move and put down the tool as indicated in the previous paragraph.
- › Secure the tool on the vehicle with ropes of suitable size, attached to the eyelets 1.

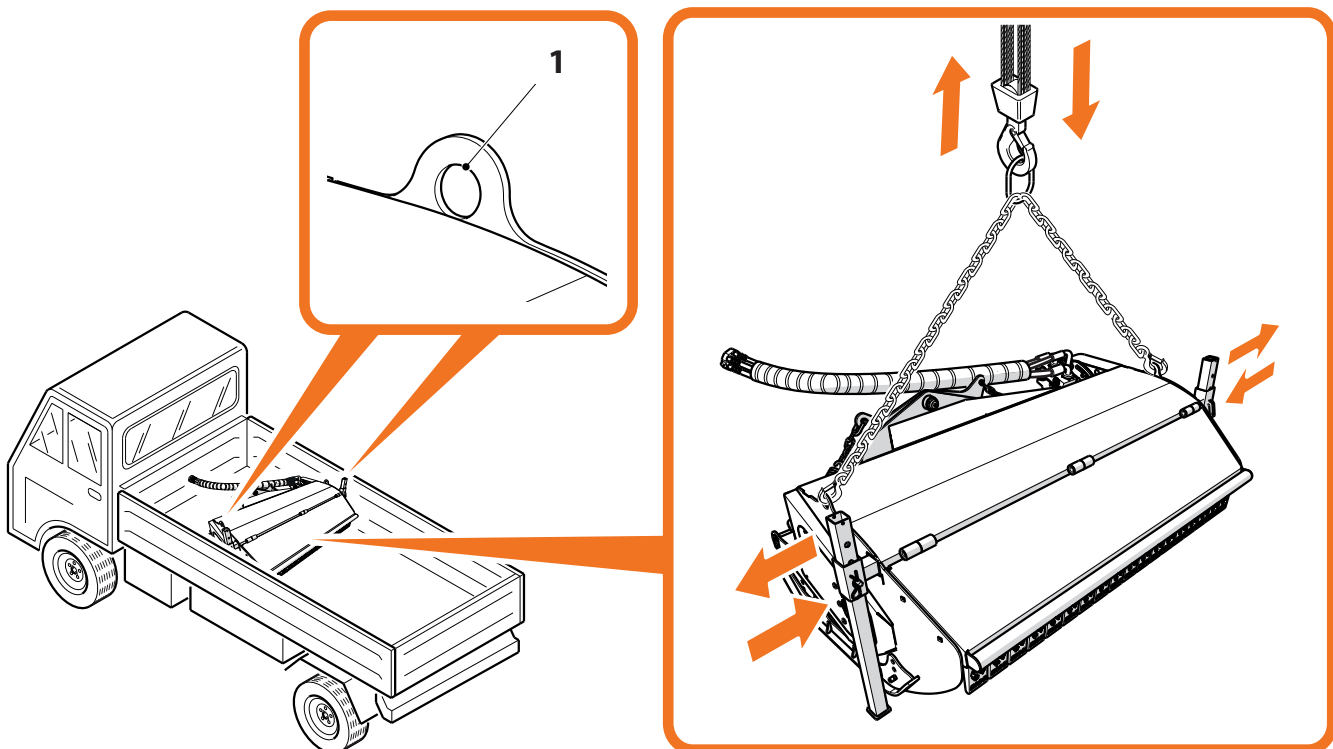

To unload the tool, proceed as follows:

- › Untie the tool from the vehicle, removing the ropes from the eyelets **1**.
- › Lift, move and put down the tool as indicated in the previous paragraph.
- › Use the tool (see chapter 5 of the manual of the machine on which the tool will be installed for the procedure).

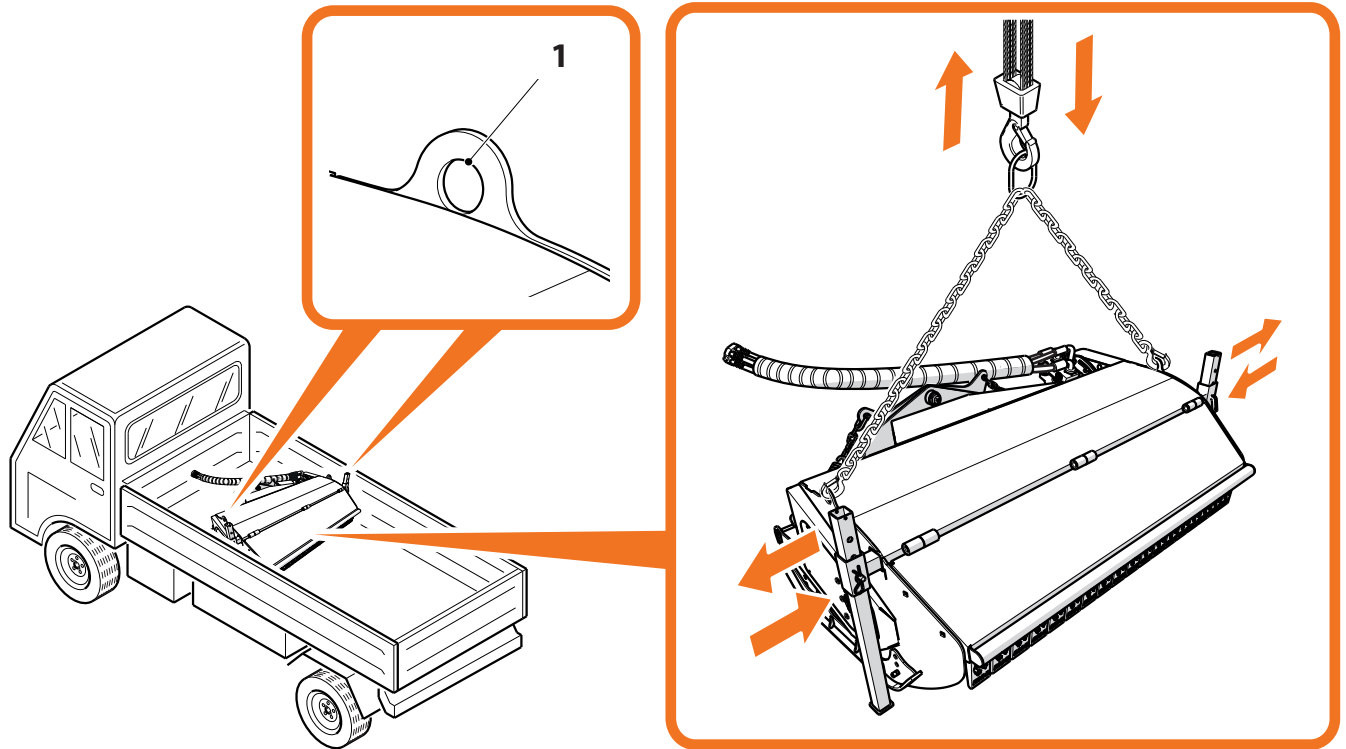





## **5** OPERATION AND USE

### **NOTICE**

Before starting to use the tool, read the following description carefully and follow the given instructions precisely.

### **5.1** CONTROL PANEL

### **NOTICE**

For an explanation of the control panel, see the manual of the machine on which the tool is installed.



## 5.2 REMOTE CONTROL

### NOTICE

This manual only explains the remote control commands specifically for the tool in question.

For all other commands, see the manual of the machine on which the tool is installed.

### 5.2.1 DESCRIPTION OF THE REMOTE CONTROL

Control	Description
L	Yellow LED on yellow background - Rotor start enabled / Rotor start disabled
J2	Open hydraulic front casing (optional) - Close hydraulic front casing (optional)
S12	Turn rotor on / Turn rotor off
S13	Right rotor rotation/ Left rotor rotation

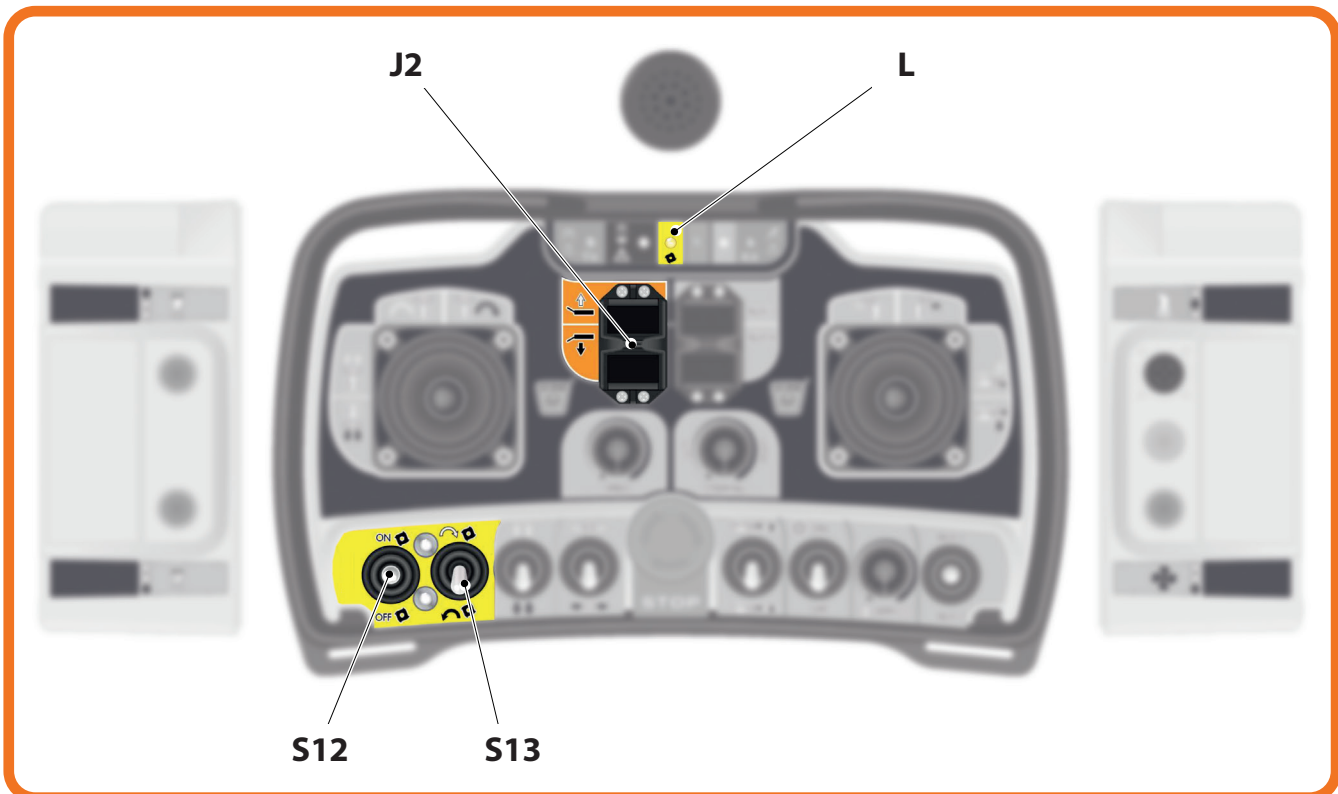



### **5.3 PRE-START CHECKS**

Proceed as follows:

- › Check that the tool is installed on the machine that will control it and that the connection tubes are connected (see paragraph "5.7.1 Attaching the tool").

#### **NOTICE**

**For the remaining information on the pre-start checks, see the manual of the machine on which the tool is installed.**

### **5.4 START-UP**

#### **NOTICE**

**For an explanation of the starting procedure, see the manual of the machine on which the tool is installed.**



## 5.5 USE

### NOTICE

The procedures described below explain the main controls necessary for correct operation of the machine.

Proper understanding of the following procedures is necessary in order to perform the operations correctly and in complete safety.

### 5.5.1 MAIN CONTROLS

### NOTICE

This manual only explains the main commands specifically for the tool in question.

For all other commands, see the manual of the machine on which the tool is installed.

- › Press switch **S12** in the direction indicated by the arrow to turn on rotor.



- › Press switch **S12** in the direction indicated by the arrow to turn off rotor.



- › Press switch **S13** in the direction indicated by the arrow to activate right rotor rotation.

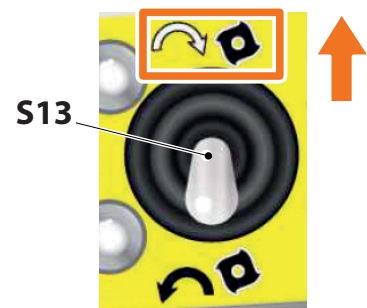



- › Press switch **S13** in the direction indicated by the arrow to activate left rotor rotation.

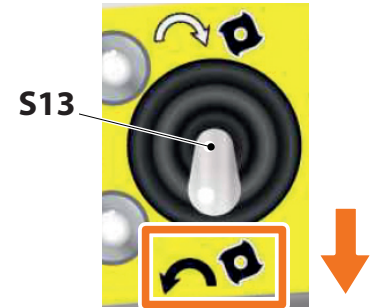

- › Press switch **J2** in the direction indicated by the arrow to activate the hydraulic opening of the front casing (optional).

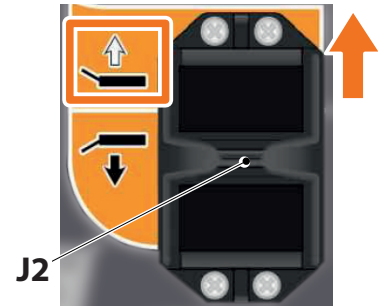

- › Press switch **J2** in the direction indicated by the arrow to activate the hydraulic closing of the front casing (optional).





### 5.5.2 SAFETY GUIDELINES FOR USE



#### **CAUTION**

While the tool is operating, constantly observe the area around it to identify potential hazards.



#### **DANGER**

While the tool is in use, no people must be present within its work area, as indicated in paragraph "3.4 Work area".



#### **CAUTION**

The working speed depends on the type of operation performed, as indicated in paragraph "3.9 Permitted uses".



#### **CAUTION**

Move the controls gradually (see the manual of the machine on which the tool is installed and/or paragraph "5.2.1 Description of the remote control") in order to achieve smooth and constant work and a smooth stop.



#### **DANGER**

Avoid starting, braking and steering abruptly.

#### **NOTICE**

Use the horn to alert any people present in the work area.

### 5.5.3 CUTTING



## WARNING

Use extreme caution during cutting operations.

- › Locate the area where the tool is parked (see paragraph "5.6 Parking").
- › Attach the tool (see the manual of the machine on which the tool is installed and paragraph "5.7.1 Attaching the tool").

- › Approach the work area slowly.

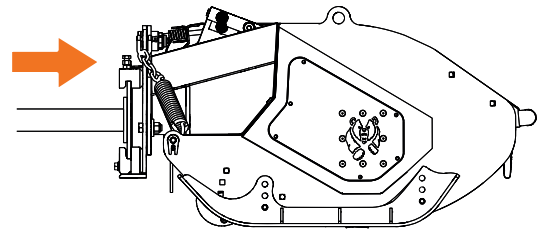

- › Lower the tool close to the ground.
- › Proceed with the cutting.
  - › The connection plate **1** allows the tool to adapt to uneven ground.

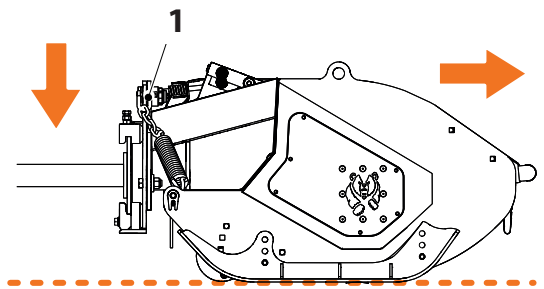

- › After cutting, locate the area where the tool is to be parked and proceed with parking (see the manual of the machine on which the tool is installed and paragraph "5.6 Parking").
- › Detach the tool (see paragraph "5.7.2 Detaching the tool").



### 5.5.4 ADJUSTMENTS

The cutting height can be regulated by adjusting the compactor roller **R** and support runners **S**.

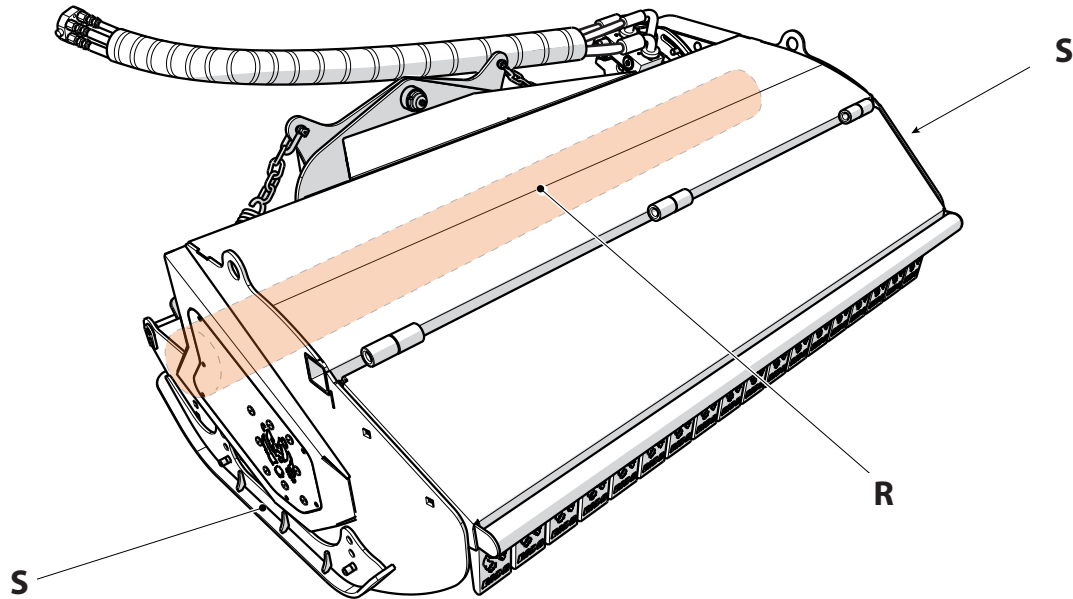

## NOTICE

The compactor roller and support runners must be adjusted in the same manner. For example, if the compactor roller is set to the "fully up" position, the support runners must also be set to the "fully up" position.

To adjust the compactor roller **R**, proceed as follows:

- › Release the support **1** by unscrewing the bolt **2** and nut **3**.
  - › The compactor roller **R** moves together with the support **1**.

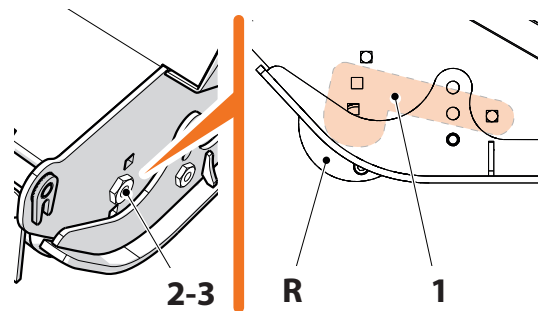

- › Turn the compactor roller **R** in the direction indicated by the arrow.
  - › Identify the adjustment hole (**A-B-C**) in which to insert the bolt **2** and nut **3**.

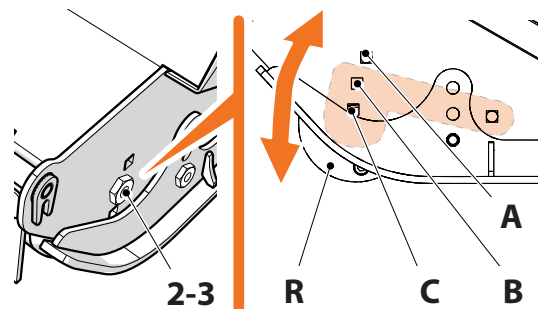

- › Lock the support **1** in place by tightening the bolt **2** and nut **3**.
- › Do the same on both sides of the tool.

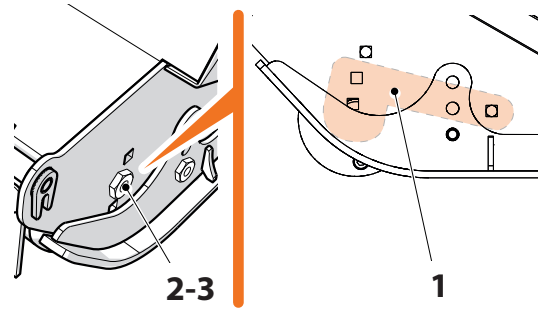

To adjust the support runners **S**, proceed as follows:

- › Release the support runner **1** by unscrewing the bolt **4** and nut **5**.

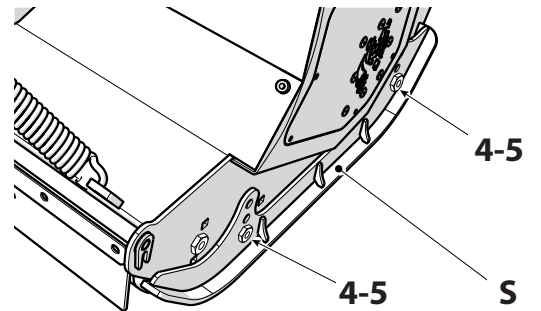

- › Move the support runner **S** in the direction indicated by the arrow.
  - › Identify the adjustment hole (**A-B-C**) in which to insert the bolt **4** and nut **5**.

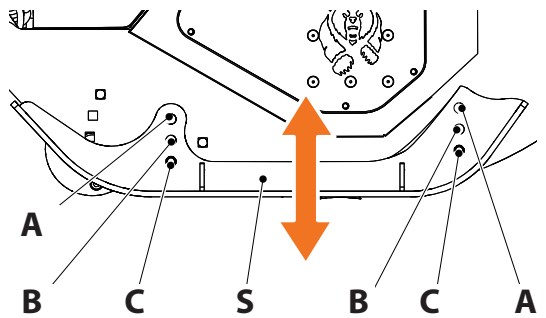

- › Secure the support runner **1** by tightening the bolt **4** and nut **5**.
- › Do the same on both sides of the tool.

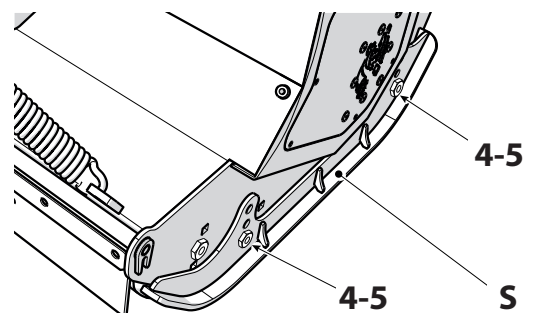
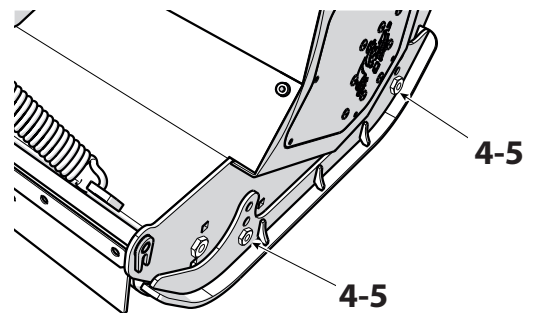



## 5.6 PARKING

The tool must be parked in compliance with the following steps:

- › Place the parking feet **1**, in their housings **2**.
- › Check the height of the parking feet **1** so that the tool, when resting on the ground and detached from the machine on which it was installed (parking condition), remains slightly tilted backwards **3**.

Proceed as follows:

- › Identify the tool parking zone.
- › Manoeuvre the machine to bring the tool to its parking position.

### NOTICE

**For the use of the controls for moving the machine, see the manual of the machine on which the tool is installed.**

- › Proceed as indicated in paragraph "5.7.2 Detaching the tool".

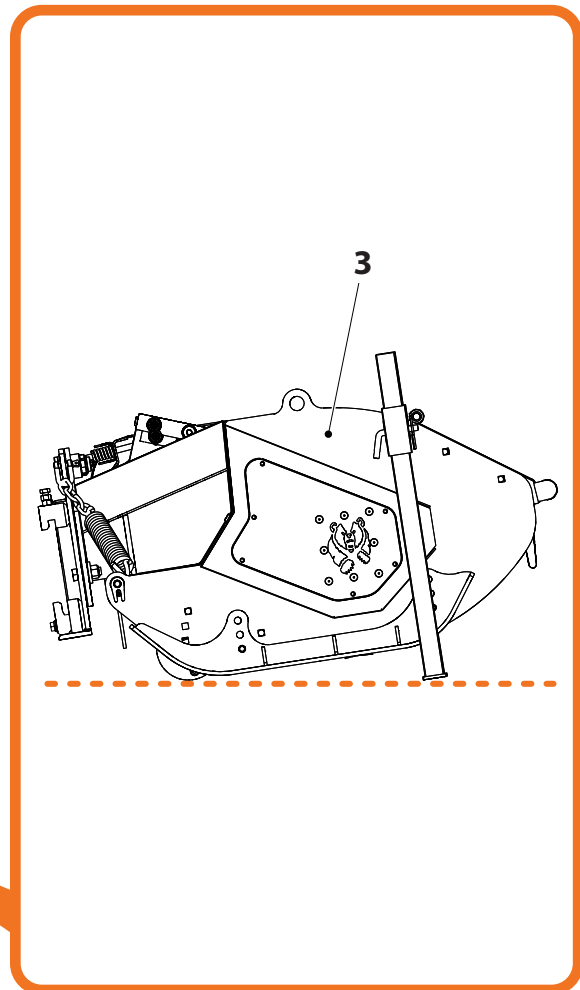
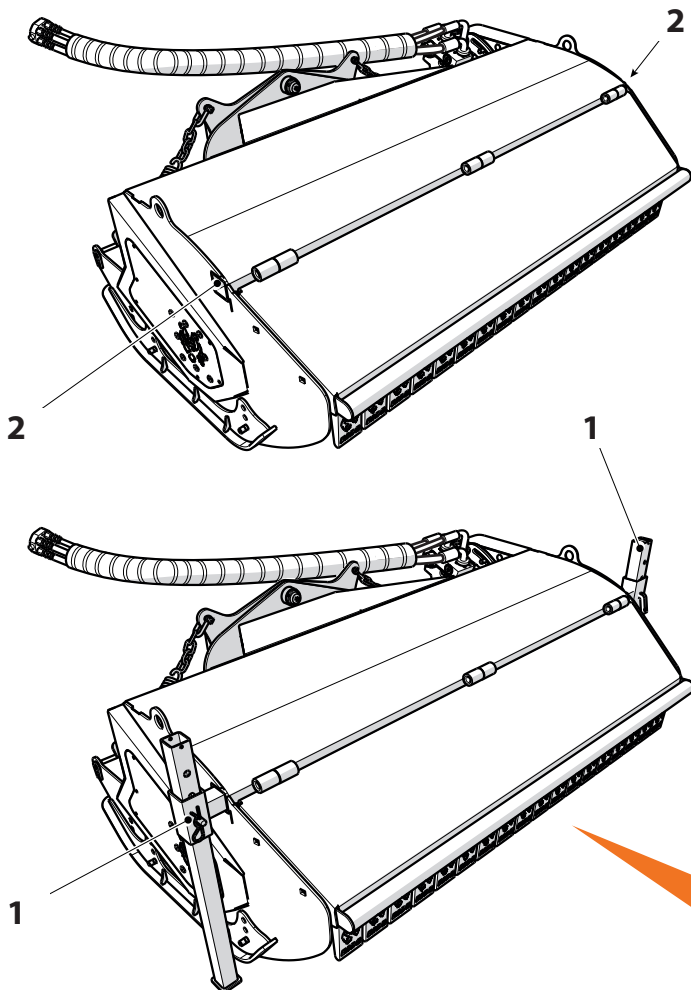

**5.7 ATTACHING/DETACHING THE TOOL**
**NOTICE**

For the use of the controls for moving the machine, see the manual of the machine on which the tool is installed.

**5.7.1 ATTACHING THE TOOL**

- › Slowly bring the machine **1** to where the tool **2** is parked.

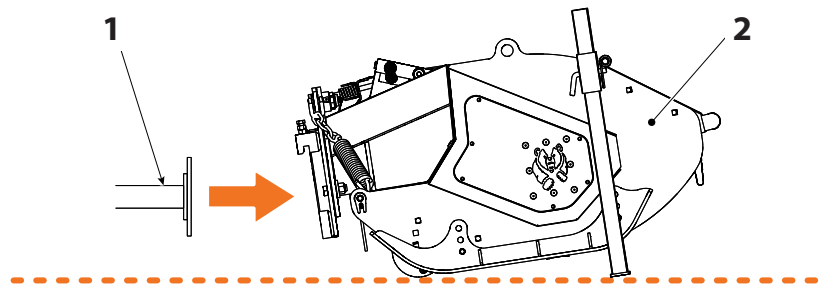

- › Attach the tool **2** to the machine by means of the plate **3**.
  - › Activate the machine support **4**, first moving it forward and then raising it.
  - › Check that the support **4** is properly housed in the seat on the plate **3**.
  - › As the support **4** is raised, the tool **2** will rotate clockwise due to gravity.

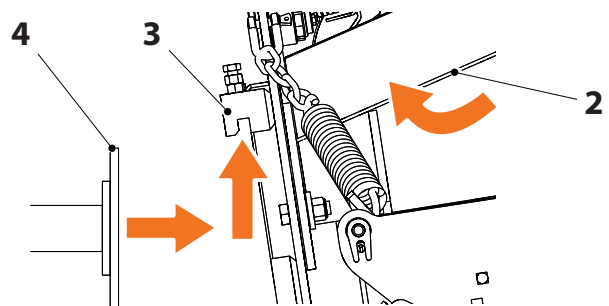

- › Fit the plates **5**, securing them with their bolts **6**.
- › Secure the support **4** with the latch **7**.
- › Lock the support **4** in place by tightening the bolt **8** and nut **9**.

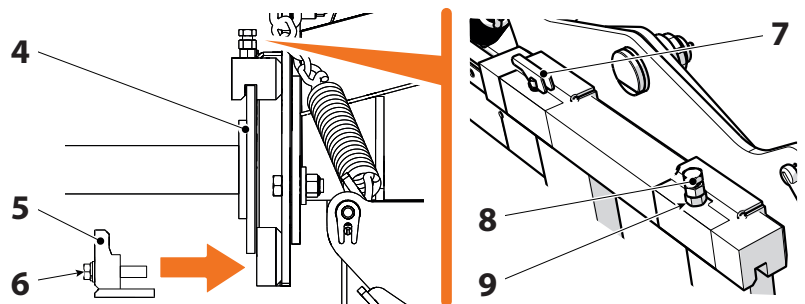



- › Raise the tool **2**.

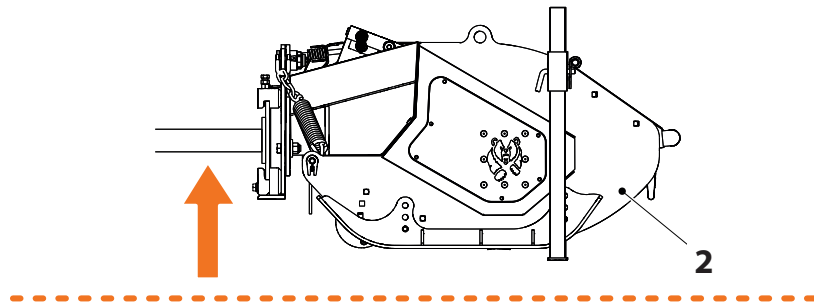

- › Remove the parking feet **10**.

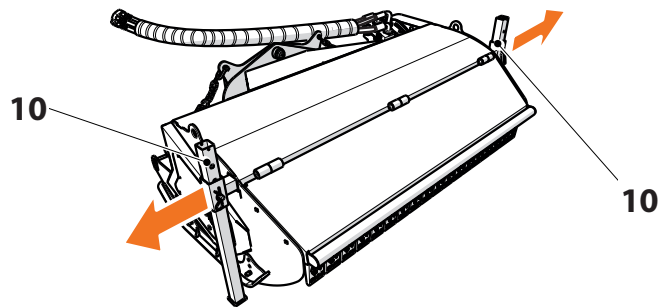

- › Locate the connection tube plate **11** on the tool.
- › Locate the valve **12** on the machine on which the tool will be installed.

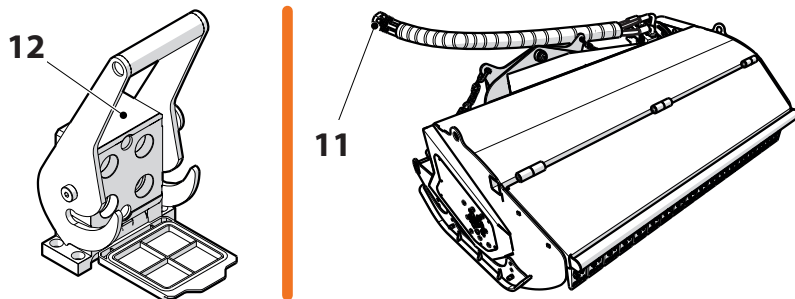

- › Clean the coupling surfaces **13** of the valve and the connection tube plate.
- › Grease the coupling pins **14** on the connection tube plate.
  - › See paragraph "3.3 Technical specifications" for the type of grease to use.

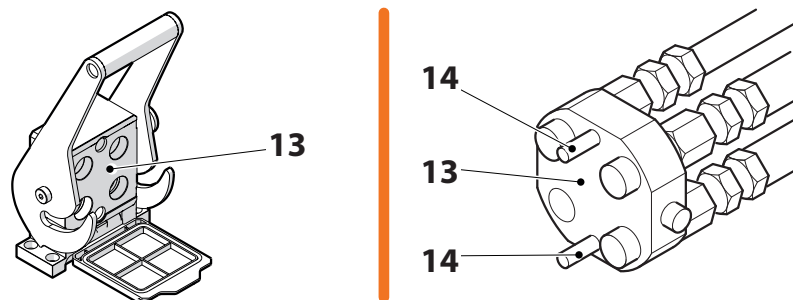

- › Insert the connection tube plate **11** into the valve housing **12**.
  - › Make sure that the pins **15** are housed in the holes.
  - › Make sure that the studs **16** are housed in their slots.
  - › The correct connection side is with the sticker **17** facing upwards.

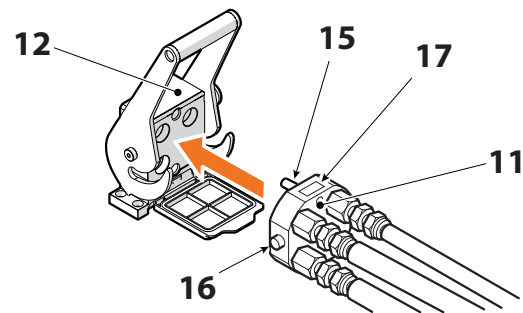

- › Secure the connection tube plate **11**, by turning the lever **18** to the horizontal position **19**.
- › The tool is ready to use.

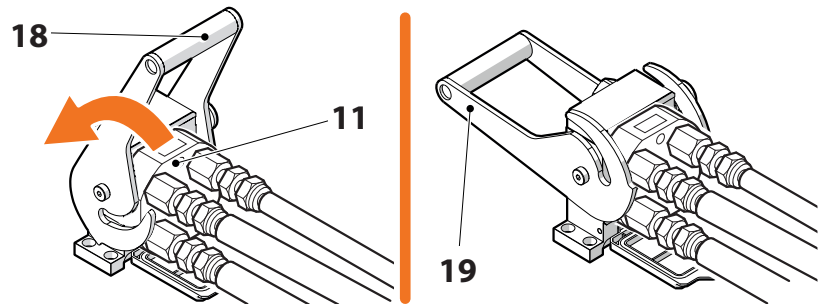



## 5.7.2 DETACHING THE TOOL

- › Slowly bring the machine to where the tool is to be parked.
- › Release the connection tube plate **11** by pressing the button **20** and raising the lever **18** to the vertical position **21**.

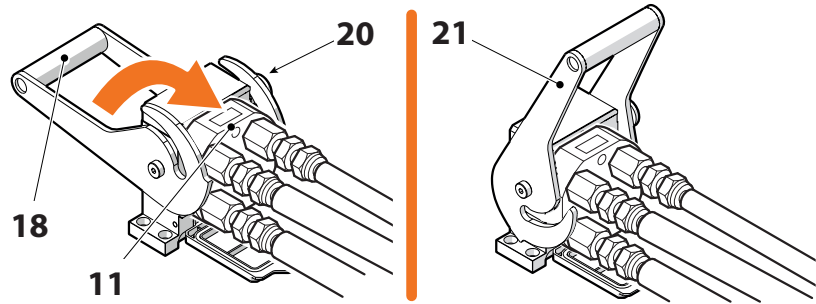

- › Remove the connection tube plate **11** from the valve housing **12** (installed on the machine on which the tool is installed)

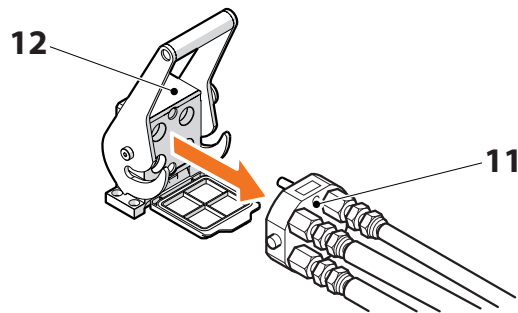

- › Fit the parking feet **10**.

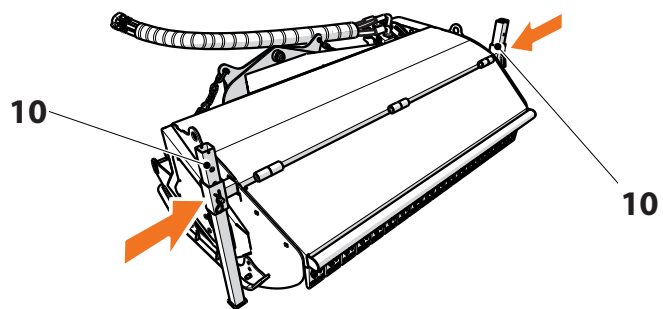

- › Lower the tool **2**.

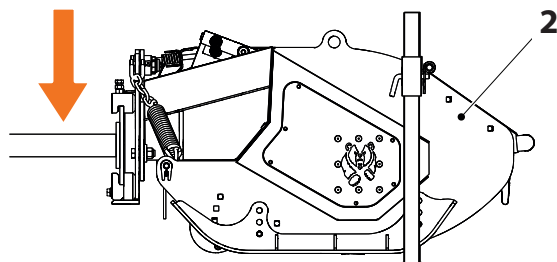

- › Loosen the bolts **6** and remove the plates **5**.
- › Release the support **4** by opening the latch **7**.
- › Release the support **4** by loosening the nut **9** and turning the bolt **8**.

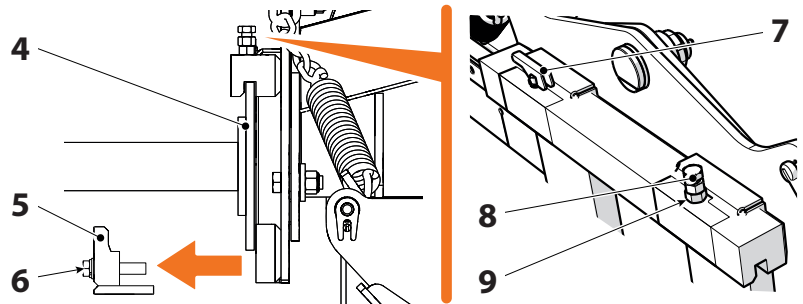

- › Rest the tool **2** on the ground.
  - › As the tool **2** is lowered, it will rotate anticlockwise due to gravity.
- › Note: If the compactor roller needs to be lubricated during maintenance, it should be rotated so that the grease nipples are accessible.

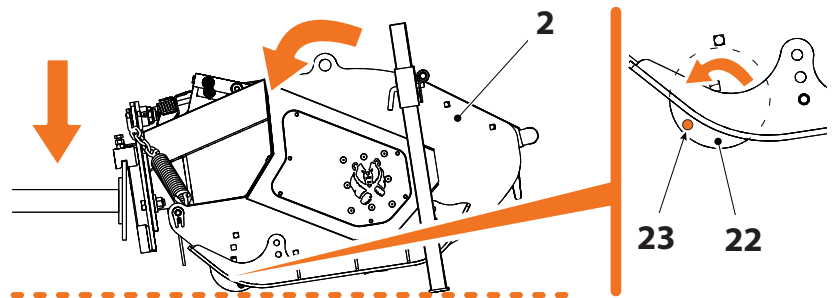

**NOTICE**

If the compactor roller **22** needs to be lubricated during maintenance (see chapter 6), before placing the tool on the ground, the compactor roller **22** must be rotated so that the grease nipples **23** are accessible.

- › Activate the machine support **4**, first lowering it and then slowly moving it back.

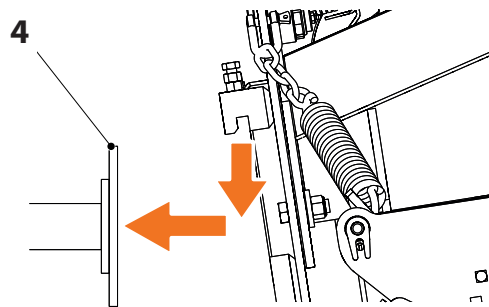

- › Slowly move the machine **1** away from where the tool **2** is parked.

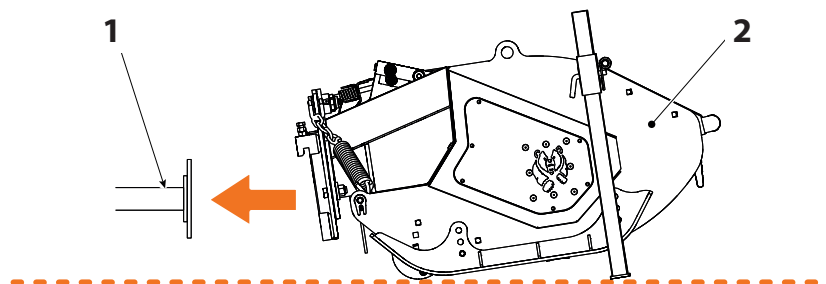



## 5.8 SHUTDOWN

### NOTICE

For an explanation of the shutdown procedure, see the manual of the machine on which the tool is installed.



## 6 MAINTENANCE

Proper maintenance is a key factor in the long working life of the tool.

All maintenance operations must be carried out following the instructions in this manual and in accordance with the laws in force in the country where the tool is used.

MDB assumes no responsibility for damage to the tool or accidents caused by incorrect maintenance.

If parts need to be replaced, this must be done exclusively with original MDB replacement parts.

MDB assumes no responsibility for damage to the tool or for accidents due to the use of non-original parts.

Use of non-original parts leads to immediate forfeiture of the warranty.

Maintenance operations are divided into:

- › Routine maintenance (by the end user's maintenance technicians).
- › Special maintenance (by specialised MDB technicians or authorised personnel).

### 6.1 PREPARING FOR MAINTENANCE

Before starting maintenance work, the tool must be prepared as follows:

- › Locate the area where the tool is parked, see paragraph "5.6 Parking".
- › Detach the tool from the machine, as indicated in paragraph "5.7.2 Detaching the tool".
- › Place a "Do not use" sign on the tool.
- › Prohibit access to the area around the tool by all unauthorised persons.

**Carry out maintenance operations with the engine cold.**

**Before starting any type of maintenance, make sure that the tool is detached from the machine. If necessary, detach it, as indicated in paragraph "5.7.2 Detaching the tool".**



**DANGER**

**During maintenance operations, the parking feet must always be in place, as indicated in paragraph "5.6 Parking" and "5.7.2 Detaching the tool".**



### 6.1.1 FRONT CASING

Some types of maintenance require the front casing **1** to be open.

The front casing **1** is opened as follows:

- › Release the bolts **2** and nuts **3**.
- › Unscrew the nuts **4** and remove the bolts **5**.
- › Open the front casing **1**, rotating it in the direction indicated by the arrow, until it reaches the inspection position **6**.

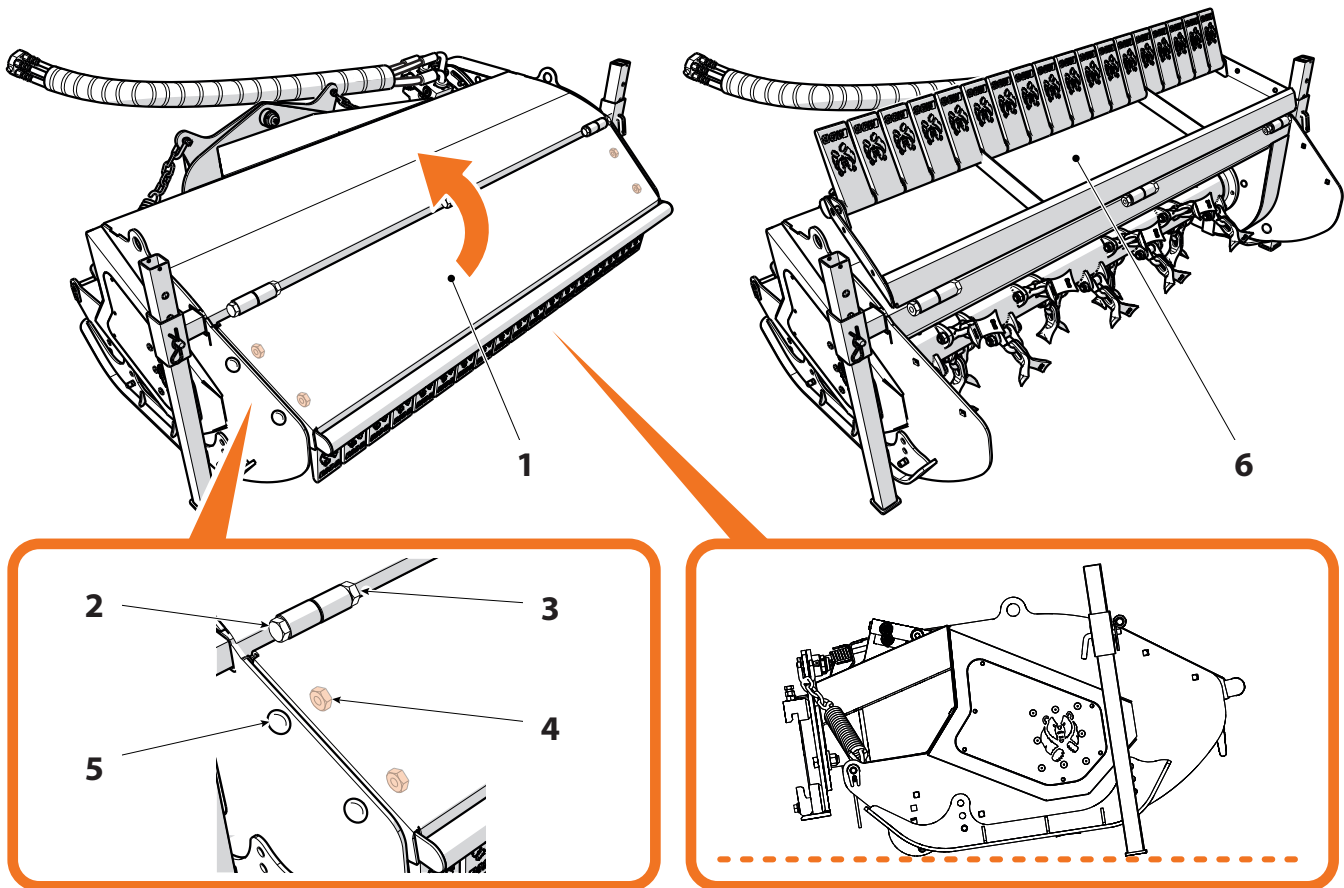

### 6.2 EQUIPMENT SUPPLIED

#### NOTICE

The supplied equipment necessary for carrying out maintenance is indicated in the manual of the machine on which the tool is installed.



### 6.3 SCHEDULED MAINTENANCE TABLE

The information necessary for determining when machine maintenance is required is given below.

Perform maintenance work as scheduled, based on the indications of the hour meter (see chapter 5 of the manual of the machine on which the tool is installed), following the table below.

Time interval (Hours)	Type of maintenance	See paragraph
4	Periodic rotor lubrication	6.4.10
8	General tool cleaning	6.4.2
8	Checking the knives for wear	6.4.7
8	General periodic lubrication	6.4.9
8	Checking tightening elements	6.4.11
8	Checking the hydraulic system	6.4.12
10	Checking transmission belt tension	6.4.4
40	General checks	6.4.1
200	Checking wear on the connection plate spacer	6.4.3
200	Checking transmission belt tension	6.4.4
400	Replacing the knives	6.4.8
1000	Replacing the transmission belts	6.4.6







6.3.1 CHECKLIST

Symbols used	
Description	Symbol
General indication	•
Functional test	
Replacement	
Visual check	
bolt tightness check	
Cleaning	

Type of maintenance	Maintenance intervals						
	4	8	10	40	200	400	1000
Periodic rotor lubrication	•						
General tool cleaning							
Checking the knives for wear							
General periodic lubrication		•					
Checking tightening elements							
Checking the hydraulic system							
Checking transmission belt tension							
General checks							



Type of maintenance	Maintenance intervals						
	4	8	10	40	200	400	1000
Checking wear on the connection plate spacer							
Checking transmission belt tension							
Replacing the knives							
Replacing the transmission belts							



## 6.4 ROUTINE MAINTENANCE

Maintenance must only be carried out by a qualified and authorised person, referred to as the maintenance technician.

### NOTICE

The maintenance technician must be sufficiently skilled and experienced to assess the condition of the tool and the effectiveness of personal protective equipment, based on technical norms.

Routine maintenance is under the responsibility of the end user's maintenance technicians.

### 6.4.1 GENERAL CHECKS

Carry out a general tool integrity check every 40 working hours.

### 6.4.2 GENERAL TOOL CLEANING

Clean the tool thoroughly of all mud and debris every 8 working hours.

The cleaning process can be:

- › Manual (Use a soft cloth dampened with water and/or environmentally friendly detergents)
- › Assisted (Use a pressurised water cleaning device)

### NOTICE

Use only environmentally friendly, neutral pH detergents for cleaning operations.

Do not use cleaning devices that may scratch or scrape.

## USING A PRESSURISED WATER CLEANING DEVICE

### CAUTION

Damage to the tool may occur if the following instructions are not followed.

- › The water and detergent temperature must never exceed 60°C.
- › The nozzle of the cleaning equipment must always be kept at the right distance from the tool. This is to avoid damaging the parts being washed.
- › The water spray must never be pointed towards:
  - › Electrical and electronic components
  - › Plastic components
  - › Bearings
  - › Support points
  - › Plates and stickers

### 6.4.3 CHECKING WEAR ON THE CONNECTION PLATE SPACER

This check should be carried out every 200 working hours.



## CAUTION

The operator must wear the following personal protective equipment:



- › Safety footwear
- › Gloves
- › Protective clothing

Proceed as follows:

- › Check the state of wear of the spacer **1**.
  - › If there is a distance of between 2 and 2.5 mm between the plates **2**, it means that the spacer is worn and should be replaced.

## NOTICE

This replacement must only be carried out by MDB service centre technicians. For this reason, contact the MDB support service.

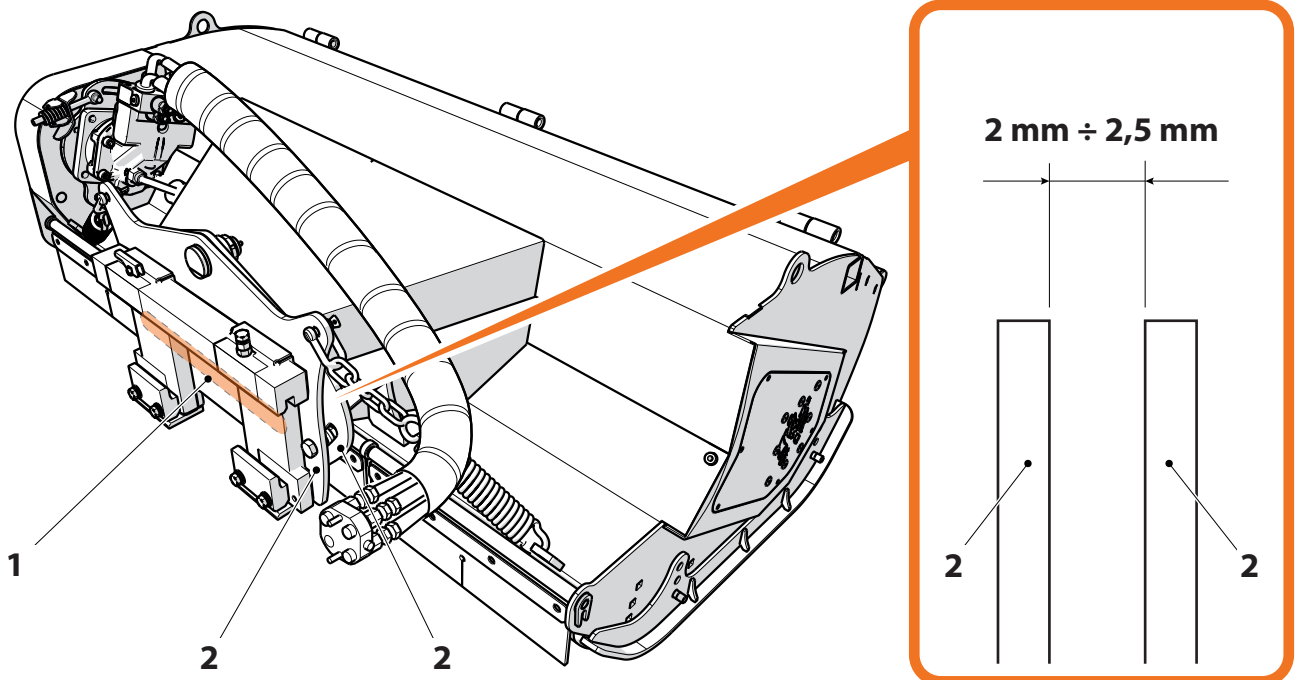



#### 6.4.4 CHECKING TRANSMISSION BELT TENSION

This check must be carried out after the first 10 hours of work.  
The check should then be carried out every 200 working hours.



### CAUTION

The operator must wear the following personal protective equipment:



- › Safety footwear
- › Gloves
- › Protective clothing

Proceed as follows:

- › Check that the end of the spring **1** is aligned with the end of the guide **2**, as shown in figure **A**.
  - › Figure **A** is shown on the nameplate **3**.
- › If the condition is not as shown in figure **A**, proceed as described in the paragraph below.

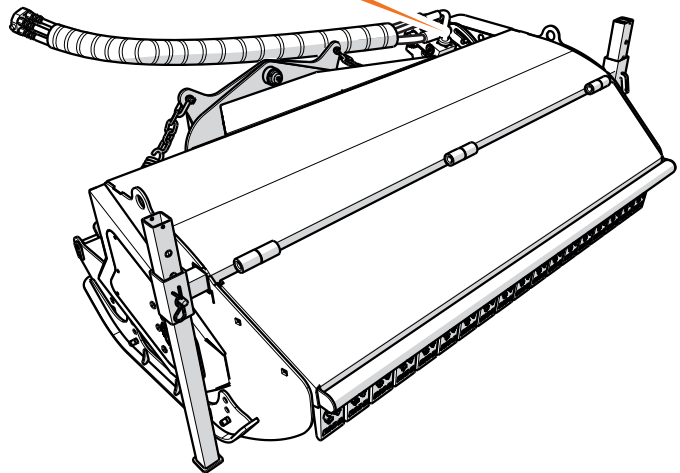
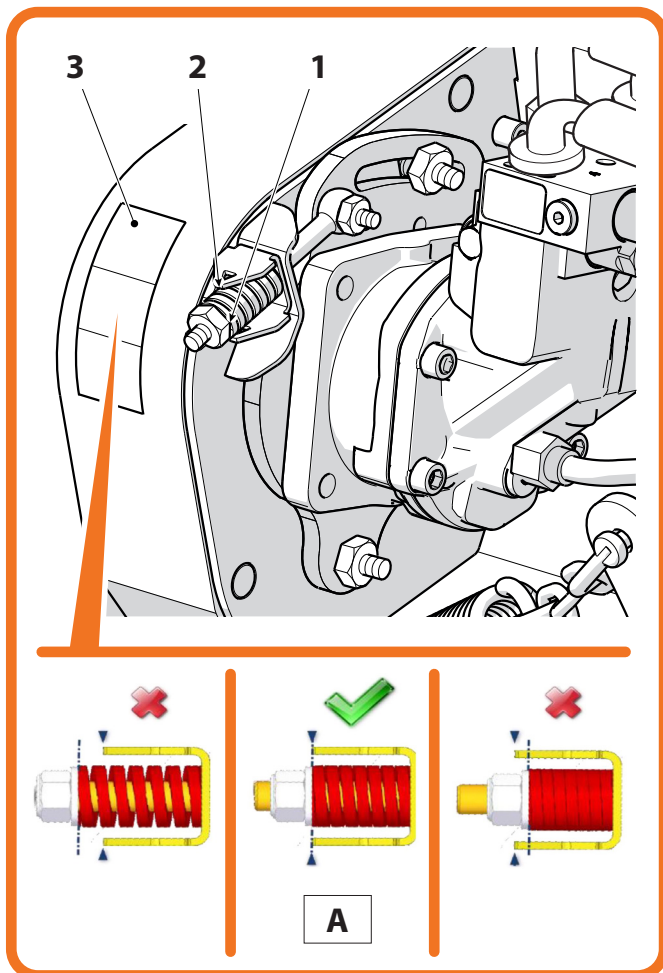

### 6.4.5 ADJUSTING TRANSMISSION BELT TENSION



## CAUTION

The operator must wear the following personal protective equipment:



- > Safety footwear
- > Gloves
- > Protective clothing

Proceed as follows:

- > Loosen the nuts **1**.
- > Turn the nut **2** until the end of the spring **3** is aligned with the end of the guide **4**, as shown in figure **A**.
- > Figure **A** is shown on the nameplate **5**.

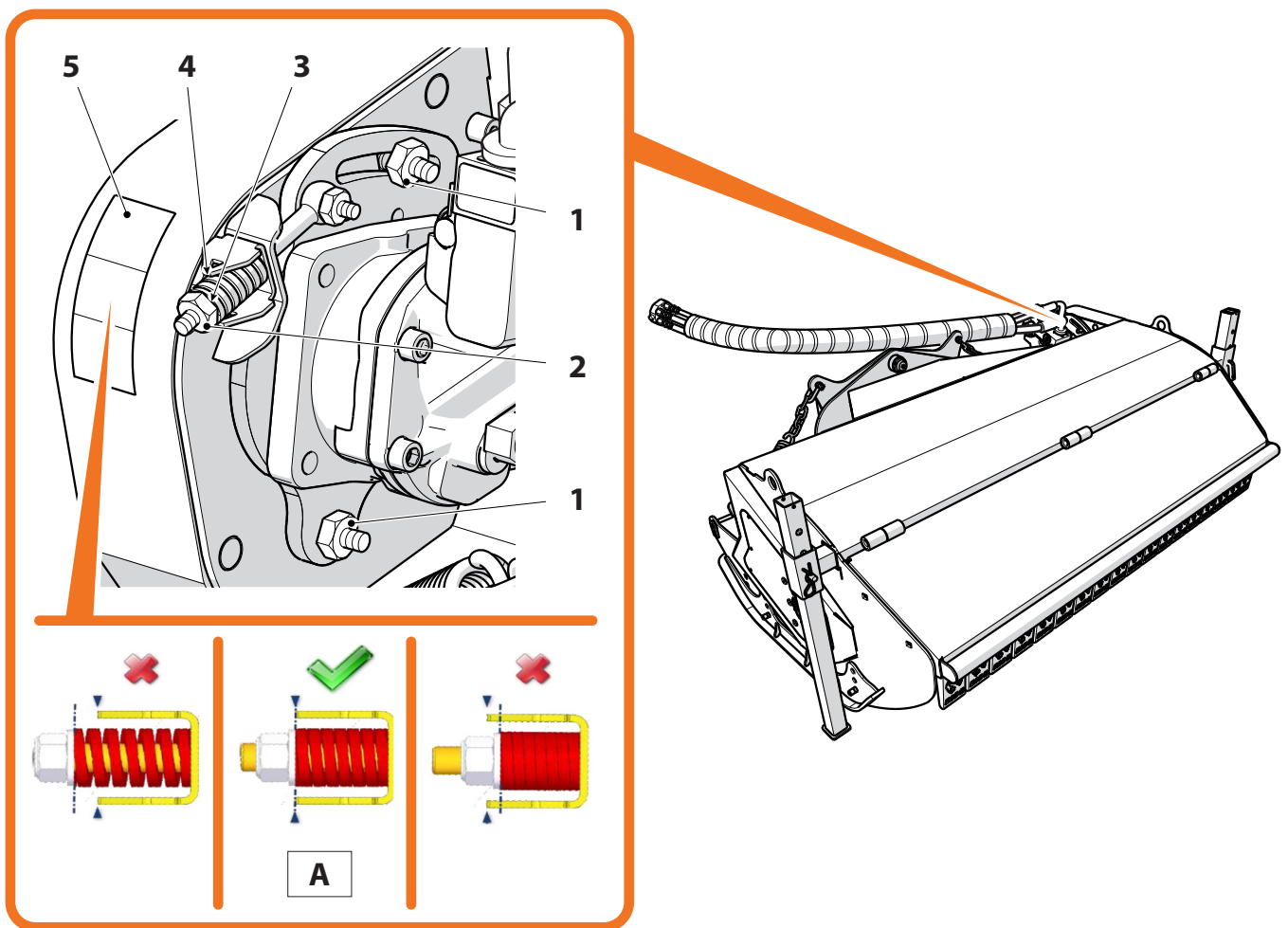



### 6.4.6 REPLACING THE TRANSMISSION BELTS

This should be done every 1000 hours of work.

#### CAUTION

The operator must wear the following personal protective equipment:



- › Safety footwear
- › Gloves
- › Protective clothing

Proceed as follows:

- › Undo the bolts **1** and remove the casing **2**.
- › Loosen the nuts **3** and unscrew nut **4**.
- › Rotate the plate **5** in the direction indicated by the arrow.
  - › The belts **6** will slacken.
- › Remove the worn belts and replace them with new ones.
- › Tension the new belts, as indicated in the previous paragraph.

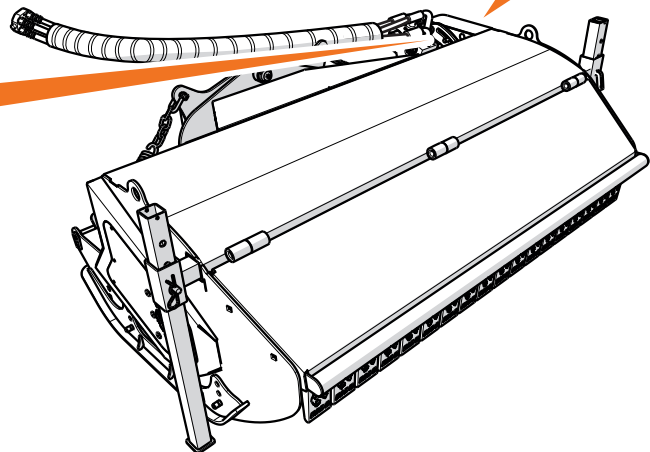
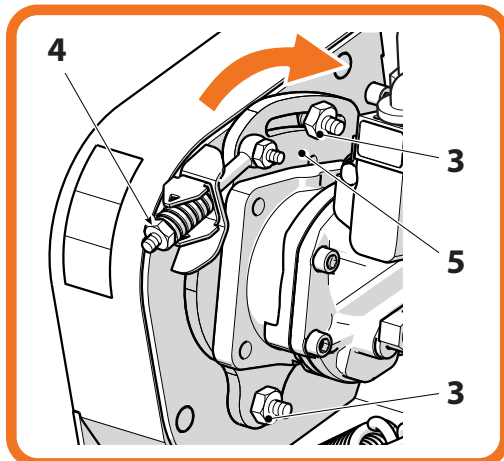
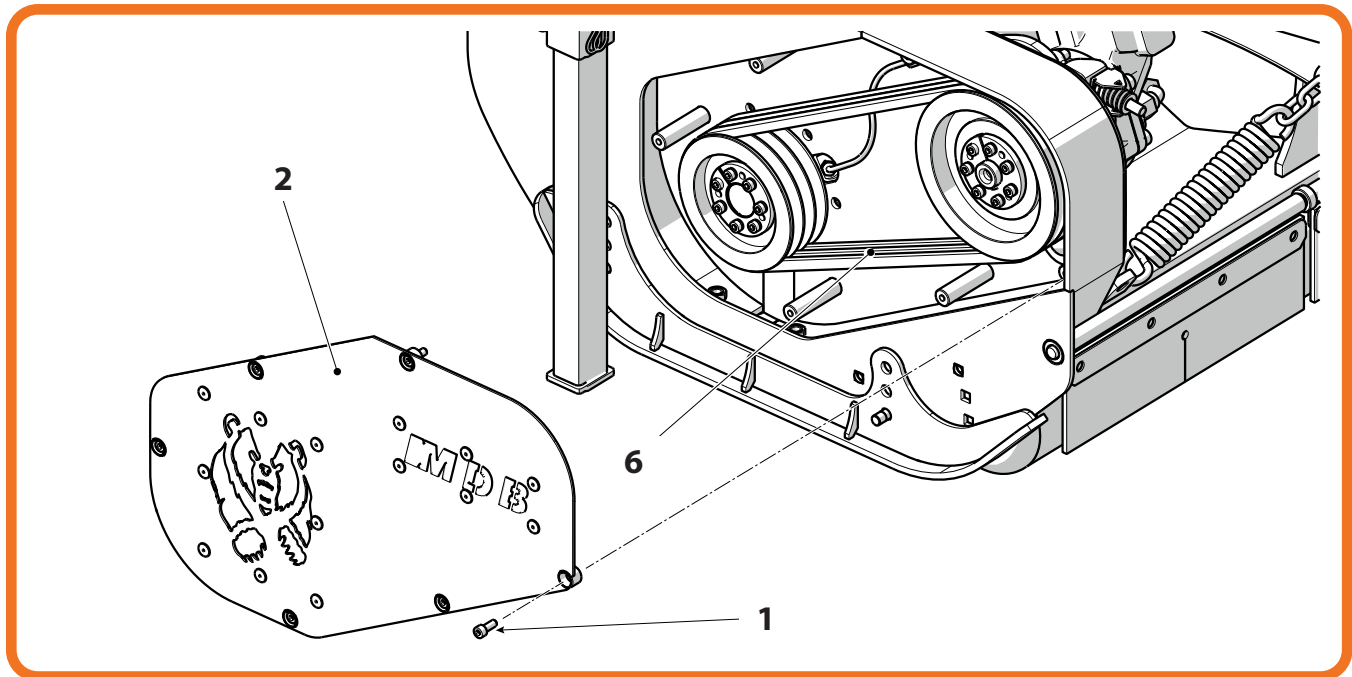

### 6.4.7 CHECKING THE KNIVES FOR WEAR

This check should be carried out every 8 working hours.



## WARNING

### CUT HAZARD

The operator must wear the following personal protective equipment:

- › Safety footwear
- › Gloves
- › Protective clothing



Proceed as follows:

- › Open the front casing (see paragraph "6.1.1 Front casing").
- › Check the sharpness of the knives **1**.
  - › The thickness of the cutting surface **2** must not be more than 2 mm.
  - › If this condition is not satisfactory, proceed as described in the paragraph below.
- › Do the same on all the knives.

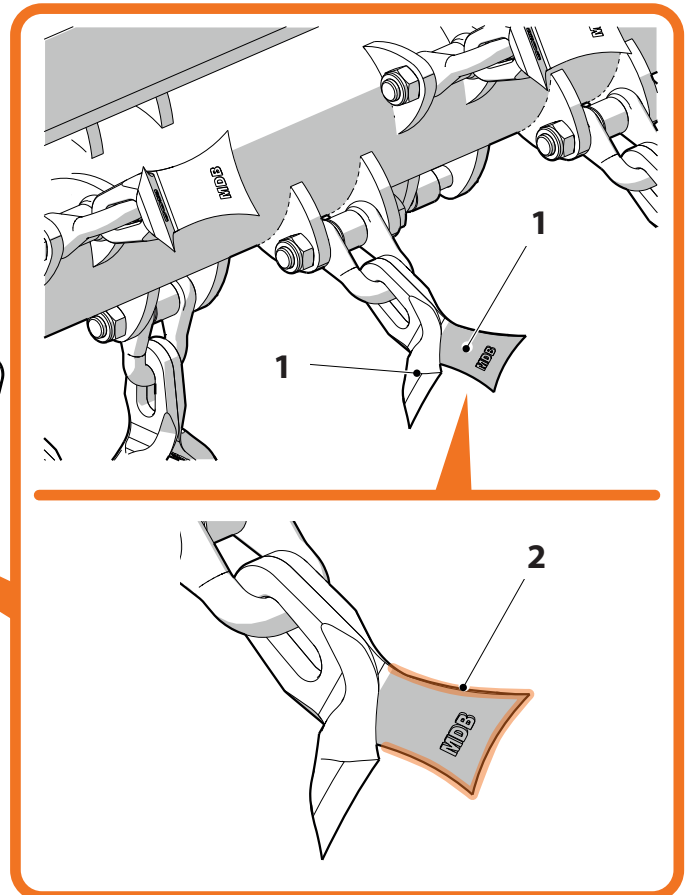
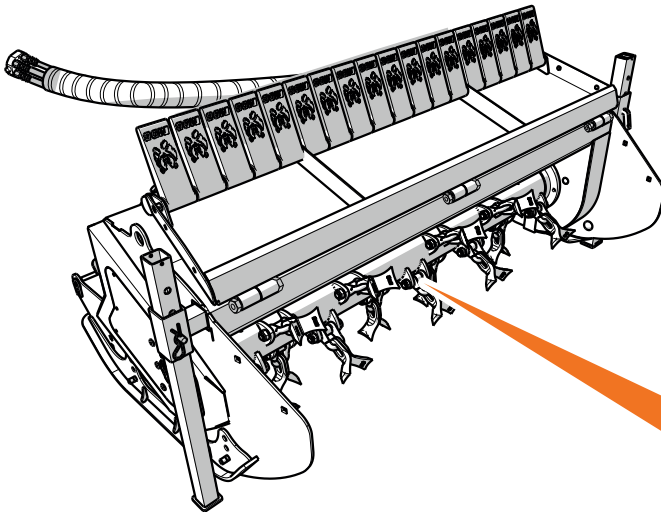



### 6.4.8 REPLACING THE KNIVES

This should be done every 400 hours of work.

## ! WARNING

### CUT HAZARD

The operator must wear the following personal protective equipment:

- › Safety footwear
- › Gloves
- › Protective clothing



Proceed as follows:

- › Open the front casing (see paragraph "6.1.1 Front casing").
- › Unscrew the nut **1** and remove the bolt **2**.
  - › During this operation, support the spacer **3**, clevis **4** and knives **5**.
- › Remove the worn knives and replace them with new ones.
- › Do the same on all the knives.

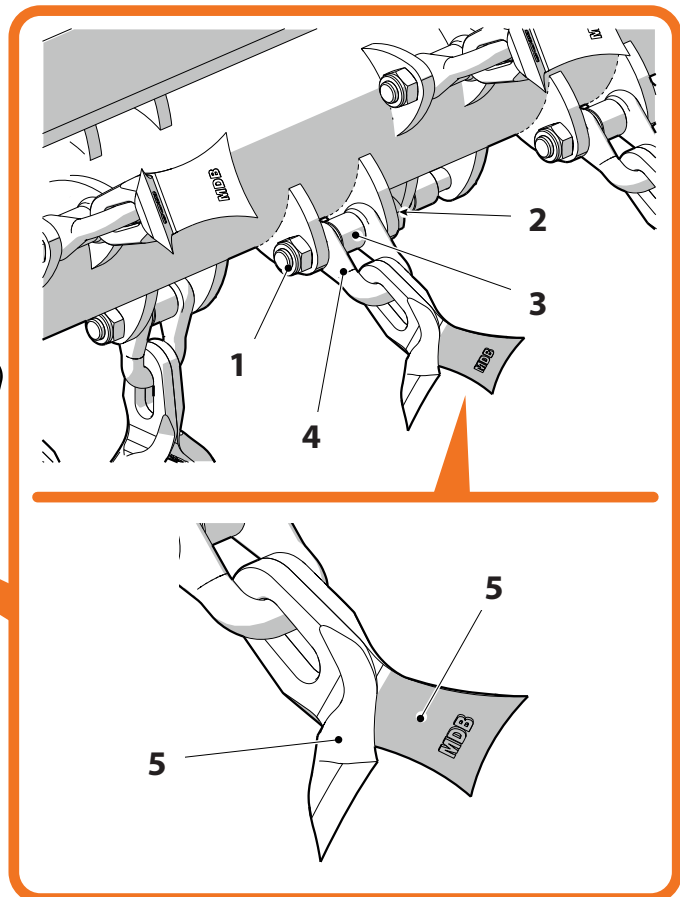
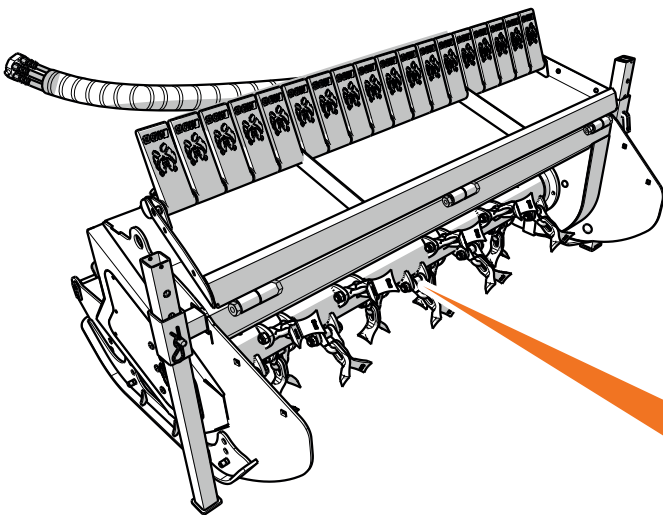

## ! DANGER

It is strictly prohibited to replace the above components with parts other than MDB original parts.

### 6.4.9 GENERAL PERIODIC LUBRICATION

Lubricate the following points every 8 working hours:

- > **IR** Compression roller grease nipples
- > **IP** Connection plate pin grease nipple



## CAUTION

The operator must wear the following personal protective equipment:



- > Safety footwear
- > Gloves
- > Protective clothing

Proceed as follows:

- > Connect the tube **1** to the pump **2**.
- > Connect the fitting **3** to the tube **1**.
- > Connect the fitting **3** to the relevant grease nipples **IR** and **IP**.

## NOTICE

See paragraph "3.3.3 Other technical specifications" for the type of product to use.

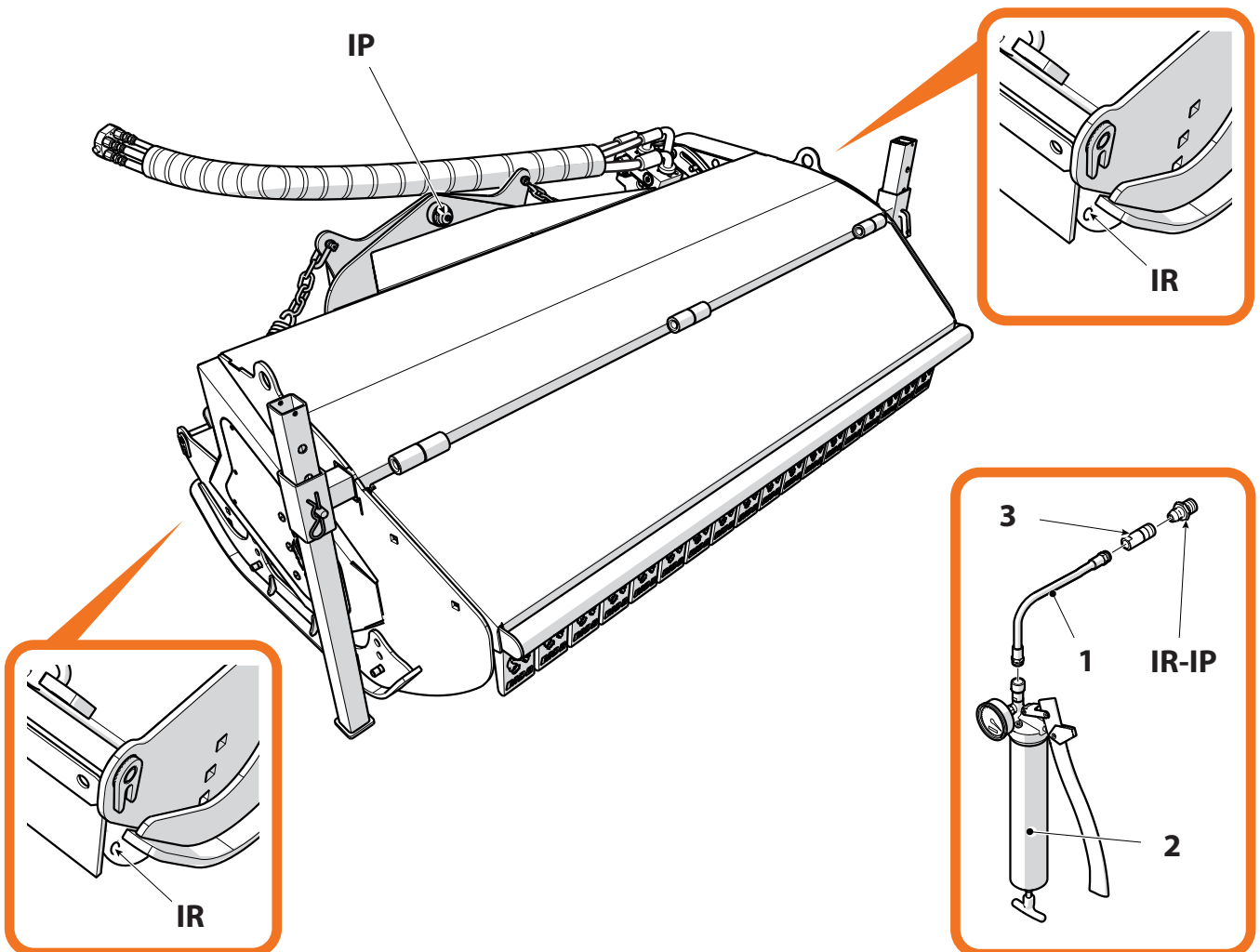



### 6.4.10 PERIODIC ROTOR LUBRICATION

Lubricate the points indicated in the figure every 4 working hours.



## CAUTION



The operator must wear the following personal protective equipment:

- › Safety footwear
- › Gloves
- › Protective clothing

Proceed as follows:

- › Connect the tube **1** to the pump **2**.
- › Connect the fitting **3** to the tube **1**.
- › Connect the fitting **3** to the relevant grease nipple **I**.

## NOTICE

See paragraph "3.3.3 Other technical specifications" for the type of product to use.

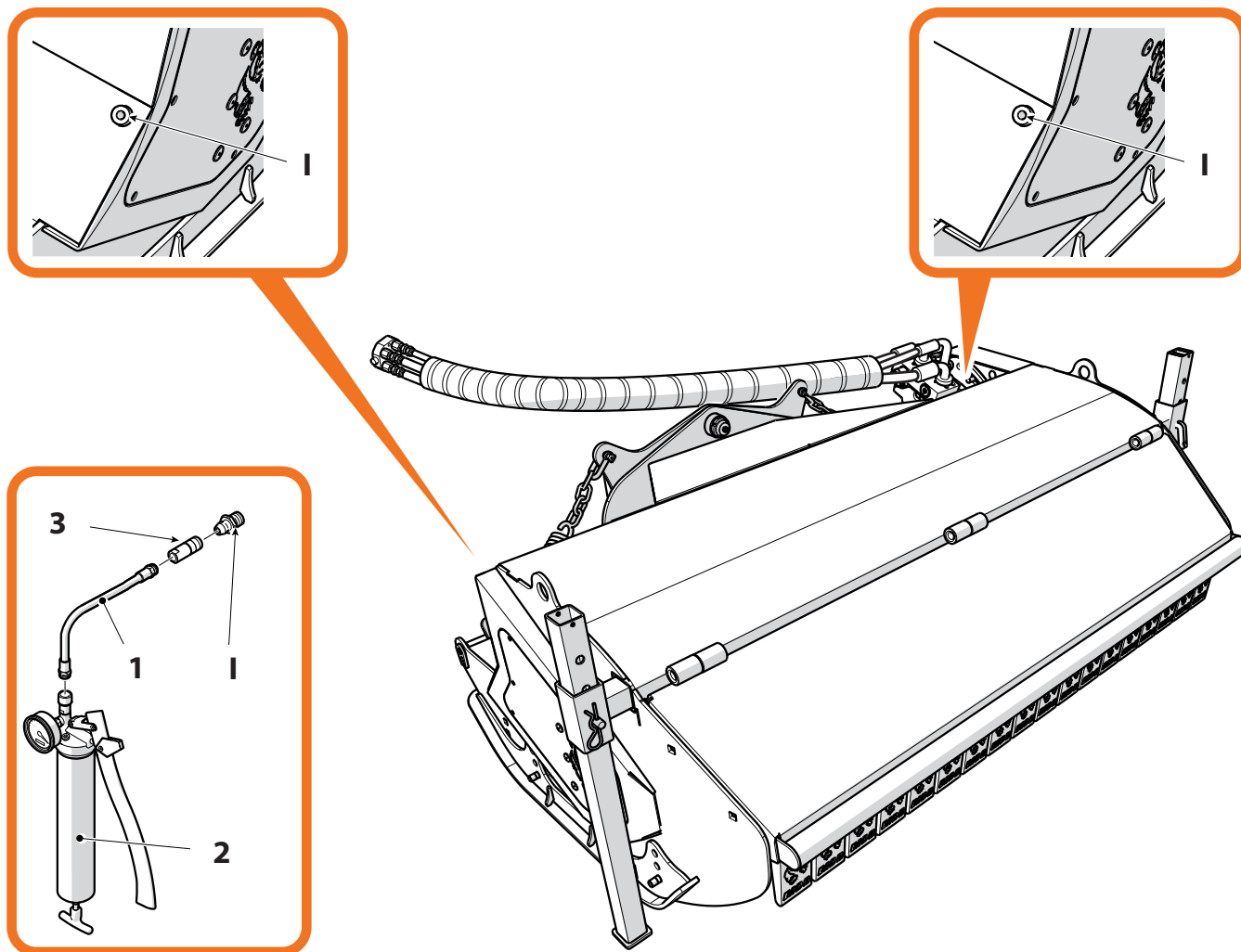



#### 6.4.11 CHECKING TIGHTENING ELEMENTS

Carry out the following checks every 8 working hours.

- › Check the tightness of all bolts.
- › Check the tightness of all nuts.
- › Check all cotter pins.
- › Check all O-rings.
- › Check that all clevis pins are secured with a cotter pin.
- › Check that all clevis pins are secured with an O-ring.

#### 6.4.12 CHECKING THE HYDRAULIC SYSTEM

Carry out the following checks every 8 working hours.

- › Check that all tubes are in a good state of preservation.
- › Check that there are no leaks in the system.

### NOTICE

**For all maintenance regarding the hydraulic oil, see the manual of the machine on which the tool is installed.**



## 6.5 SPECIAL MAINTENANCE

### NOTICE

**Maintenance must only be carried out by a qualified and authorised person, referred to as the maintenance technician.**

**The maintenance technician must be sufficiently skilled and experienced to assess the condition of the tool and the effectiveness of personal protective equipment, based on technical norms.**

**Special maintenance must be carried out by specialised MDB technicians or authorised personnel.**

No special maintenance operations are included.



**6.6 PERIODIC CHECK AND INSPECTION LOG**

Date	Hours of service	Work description	Person in charge	Stamp and signature





## 7 TROUBLESHOOTING

### 7.1 TROUBLESHOOTING GUIDE

The following paragraphs list possible faults or anomalies and identify a correct solution to quickly resolve the problem.

#### NOTICE

**In the event that the problem or its cause is not covered by the cases indicated, contact the authorised MDB dealer.**

**For the resolution of some problems, see chapters 5 and 6.**

#### 7.1.1 ROTOR

Problem	Cause	Solution
<b>The rotor does not turn</b>	The connection tubes are not connected to the machine on which the tool is installed	Connect the tubes
	Damaged motor	Contact the authorised MDB dealer
	Stones and/or debris caught between the rotor and the frame.	Remove the stones and/or debris
	Damaged transmission belts	Replace the belts
	Insufficient hydraulic oil	Top up the oil See the manual of the machine on which the tool is installed.
<b>The rotor turns slowly</b>	Insufficient hydraulic flow	See the manual of the machine on which the tool is installed.
	Damaged motor	Contact the authorised MDB dealer



### 7.1.2 HYDRAULIC SYSTEM

Problem	Cause	Solution
Excessive oil temperature	Operation at high speed for long periods	Reduce the speed See the manual of the machine on which the tool is installed.
	Insufficient hydraulic oil	Top up the oil See the manual of the machine on which the tool is installed.

### 7.1.3 TRANSMISSION

Problem	Cause	Solution
Excessive or irregular transmission belt wear	Incorrect tensioning	Adjust the belt tension
	Stones and/or debris inside the transmission unit	Remove the stones and/or debris

### 7.1.4 WORK DEVICES

Problem	Cause	Solution
Unsatisfactory work height	The support runners and/or compactor roller are not properly adjusted	Adjust the support runners and/or compactor roller
Excessive vibrations	Stones and/or debris caught between the rotor and the frame.	Remove the stones and/or debris



## 8 DISMANTLING



### CAUTION

The work on the tool must be carried out by competent personnel trained in the correct working and handling methods.

### 8.1 TEMPORARY DECOMMISSIONING

In the event that the tool will not be used for an extensive period, it must be made inoperative and stored in a special environment, as follows.

- › Check the hydraulic oil level. Top up the oil, if necessary (See the manual of the machine on which the tool is installed)
- › Store the tool in a dry, clean place, sheltered from frost and well ventilated.
- › Place the tool in the parking area and attach the parking feet (see chapter 5).
- › Detach the tool from the machine on which it is installed (see chapter 5.)
- › Carefully clean the tool with compressed air and soft fabric or microfibre cloths to completely remove any dust, moisture and work residues.
- › Apply a thin layer of oil or grease to all uncoated moving parts.
- › Treat all exposed electrical contacts with a suitable protective spray.
- › Cover the tool to protect it from dust; do not use plastic sheets as they can cause condensation; use sheets made from vapour-permeable material.

### 8.2 PERMANENT DECOMMISSIONING - DISMANTLING

At the end of the tool's working life, dismantle it as follows.

### NOTICE



Dispose of any chemicals, lubricants and used hydraulic oils, in compliance with the regulations in force in the country where the tool is used.

Dispose of the tool so as to allow the recycling of the different materials, in compliance with the regulations in force in the country where it is used.



### CAUTION

The tool contains potentially flammable hydraulic oil.

- › Completely drain the hydraulic oil system.
- › Disassemble all the components, taking care to separate the different materials: steel, non-ferrous metals, fibreglass, plastic, rubber, etc.
- › Dispose of fluids and solid materials with respect for the environment, consigning all the materials to specialised waste facilities.

### NOTICE

If disposal is carried out by a specialised company, this manual must be kept with the machine.

