

UK

03/07



Instruction manual
BIO-SHREDDER
R130 T



Original instructions

| INDEX | PAG. |
|---------------------------------------|-------------|
| Introduction | 4 |
| Machine aim | 4 |
| Warnings and security instructions | 4 |
| Assembly | 5 |
| Transport | 7 |
| Direction for use | 7 |
| Maintenance | 9 |
| Replace | 11 |
| Guarantee | 11 |
| Specifications | 11 |
| Exploded view and corresponding table | 16 |

La ditta NEGRI in qualunque momento si riserva il diritto di apportare alla propria produzione modifiche e miglioramenti ritenuti necessari a suo insindacabile giudizio. / NEGRI reserves the right to make any modifications and improvements to its products that it considers necessary at any time. / La Maison Negri se garde le droit de changer à n'importe quel moment les données, les poids et les mesures. / Negri tiene el derecho de cambiar datos, pesos y medidas en cualquier momento. / Die Firma Negri kann in jedem Moment Daten, Gewichte und Maße ändern. / Negri bedhoud zich het recht voor om gegevens, gewichten en maten te wijzigen zonder aankondiging vooraf.

Le immagini presenti in questo libretto istruzioni hanno scopo puramente illustrativo. / The picture shown in this manual only have an illustrative purpose. / Les photos qui se trouvent dans ce livret d'instructions sont purement illustratifs. / Las imágenes presentes en este manual de instrucciones tienen un fin exclusivamente ilustrativo. / Die in diesen Gebrauchsanweisungen enthaltenen Bilder haben nur einen erläuternden Zweck. / De afbeeldingen in dit instructieboekje hebben alleen maar een illustratieve betekenis.

PRESENTATION

This manual must be considered as part of the machine. The Distributors of new and used machines must prove with a documentation that the manual has been delivered together with the machine. The manual must be read by the operator before every kind of operation on the machine .

AIM OF THE MACHINE

The Bio-shredder R220 is a tool designed to mince all kind of vegetal waste (plants, hedges pruning, fruit and vegetable waste etc.etc.); the dimension, the quantity and the quality of the materials, you want to mince, must be taken into consideration.

SAFETY RULES

Operator's safety.

During the setting in motion, the use and the maintenance of the Bio-Shredder, you have to follow these safety rules:

- people under 16 years old is not allowed to use shredders
- in the working area the user is responsible for any third part
- during the shredding it is absolutely necessary to wear gloves and goggles and since the allowed sound level, during an uninterrupted use, is exceeded, you must wear an ear-protection too.
- While shredding always wear strong shoes and long trousers.
- Hair must be put up .
- Do not use the machine if you are tired , ill , or after the ingestion of alcohol , medicines or drugs .
- Do not set the machine in motion in enclosed spaces , the exhaust gases are lethal.

Machine Safety

Replace the broken or damaged parts before using the machine

- the machine has to be set on a level and steady ground
- before leaving the shredder unattended, it is necessary to stop the diesel or petrol motor following the relative manual instruction. If the Bio-Shredder is equipped with electric motor it is necessary to put the switch in the "0" position and to disconnect

the plug from the network.

-Shredding-machines can be connected to the electric-net only through a protected plug equipped with an automatic security switch (highest impulse = 30 MA).

The norm EN 60204-1 prescribes that for connective-lines you have to use only rubber cables HO5RN-F.

-It is very important to underline that the couplings for the electric-lines must be protected against water-sprays

-during the starting of the Bio-Shredder check carefully if all parts of the machine are correctly assembled.

-Do not insert any materials in the shredder without having turned on and taken to the maximum r.p.m. the motor.

-In any case you have not to use stools or ladders to reach the dragging roller at the bottom of the hopper when the machine is working.

-Do not modify the machine.

-Do not use the machine for works which differ from the ones it was made for.

Shredding safety

-While shredding you have always to stay in front of the hopper in which you introduce the material you have to mince and you have to assure that within a radius of 20 meters nobody is present.

-When the motor is on do not get near any parts of the muffler.

-Do not insert in the main hopper branches bigger than the fixed sizes.

-Do not insert in the Bio-Shredder stones, metals, glasses, plastic, ground, and bundles of newspapers but only vegetable trashes.

-Do not take away any protection guard while the machine is in function.

-Do not take away any protection guard while the machine is in function.

-While shredding the operator has not to stay in front of the discharging pipe.

-Do not introduce any part of your body into the protection guards.

Safety during the use of the fuel

-Smoking is forbidden near the machine during the refuelling .

-Stop the motor before the removal of the tank cap.

-Wait till the muffler gets cold (for it is next to the tank) before refuelling.

-Clean every possible dripping of fuel before starting the motor.

-Before starting the motor , keep at least a 3 meters distance from the refuelling zone

. Maintenance safety

-For the maintenance of the machine follow the procedures mentioned in

MAINTENANCE

-Use only original spare parts .

-During the change of the hammers and cleaning-works you have to take care not to cut yourself. "Cutting-tools are very dangerous!"

-Do not carry out maintenance before having worn protection-gloves and having stopped the motor; wait until the rotor has completely stopped.

Transport and replace safety

- Make sure that all the parts of the Bio-Shredder are well steady to the machine in order to avoid the unfastening of some pieces during the transport .
- The machine must be transported with care and the motor must be stopped.
- Empty the fuel tank before replacing the machine.

ASSEMBLY

The Bio-Shredder R220 is supplied disassembled for problems of packing. Only in particular cases it can be delivered completely assembled and so ready to be used . When a disassembled machine is bought , the exploded view (Fig.1), the bill of materials and the indications concerning the correct assembly of the machine must be followed. It is very important that only expert and authorized staff put into practice the assembly of the machine .

Bill of materials

- 2 galvanised washer 8
- 4 self-locking galvanised screw nut M8
- 10 screw 8x20 with hexagonal galvanised top
- 17 hopper
- 30 machine body

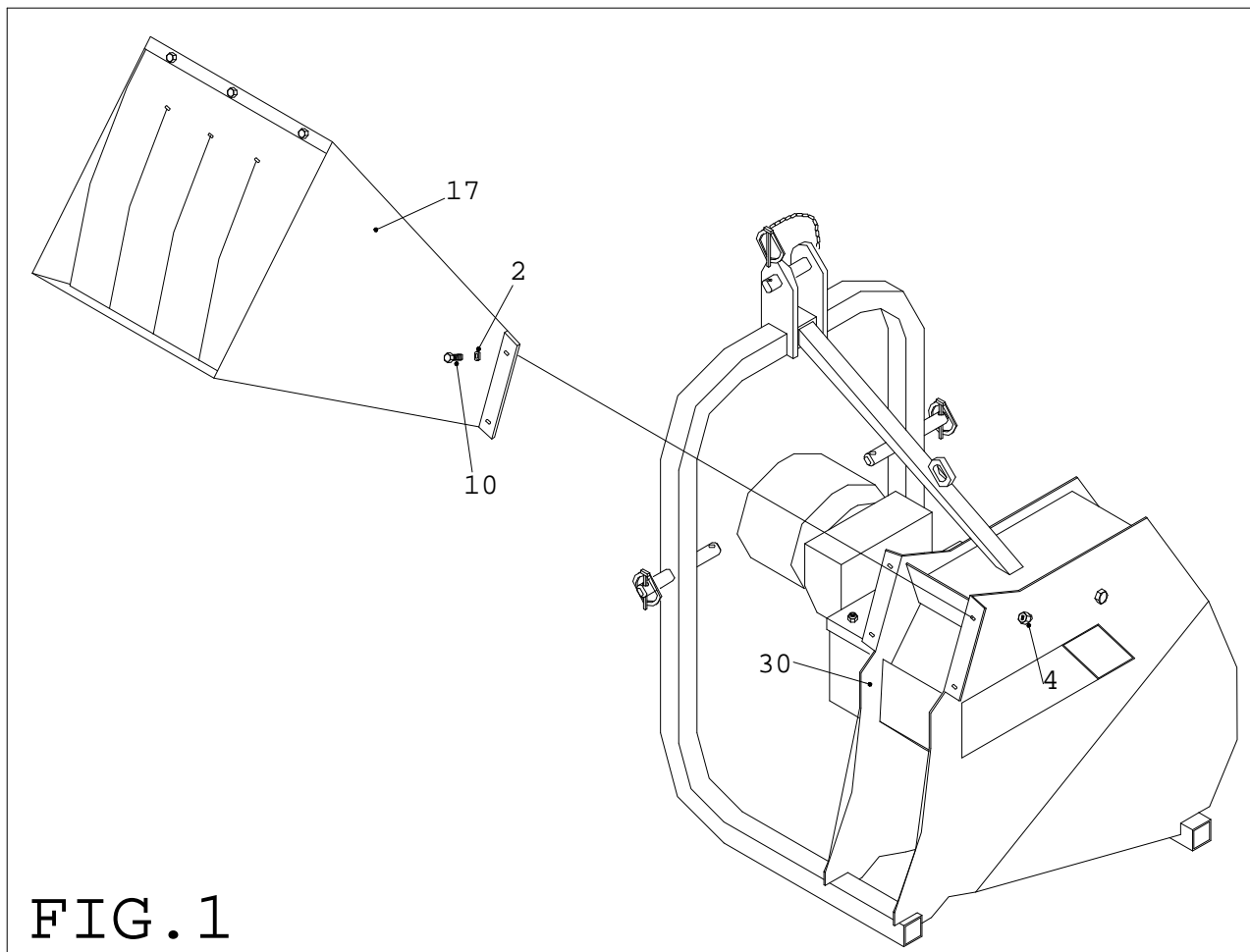

FIG. 1

Instruction for the assembly of R130:

Wear gloves .

Place the machine on a steady and level ground.

Take the hopper (17) and trying to fit together its holes with the ones of the machine body (30), fix the two parts with the 4 screws (10), 4 washers (2) and 4 screw nuts (4), see FIGURE 1.

TRANSPORT/TOW

Only authorised means of transport can transport or tow this Bio-Shredder. In both case, make sure that the Bio-Shredder is OFF . During the transport, fix as well as you can the machine to the mean of transport taking care that the Bio-Shredder does not jut out further the allowed limits of the machine’s overall.

USE INFORMATION

ALLOWED HOURS FOR THE USE OF THE BIOSHREDDER

According to the rules for the protection against noise, Bio-Shredders have not to be used at the following hours: working days from 13.00 to 15.00 and from 19.00 to 7.00 of the following day, holidays from 13.00 to 15.00 and from 22.00 to 7.00 of the following day .

SETTING AT WORK

Wear working gloves. Put the machine on a level and steady ground. Be sure that all the guards are well fixed. Be sure that the engine oil level (see the engine manual)

and the hydraulic oil (see the “maintenance” paragraph) are not under the allowed limit. Check the oil level of the overgear group (see the paragraph about maintenance), because it has not to be under the limit allowed. Turn the discharging hopper to the wanted direction. If the machine has an explosion engine, idle the engine, following the relative instructions manual and let it warm up for about 2 minutes. Move the accelerator level to the position where the engine’s speed is at its highest (the machine functions only with the motor at maximum RPM). If the machine has a three-phase 380/400volt tension electric engine, ignite the engine putting the switch in the first position (star) and wait about 2/5 seconds ,then turn the switch in the second position (triangle), in this way the engine achieves the peak RPM without havin a great absorption. Do not start the electric engine putting the switch in the last position at once, it will cause an interruption of the electric line.

USE

Use the machine at an ambient temperature between -15°C and 40°C.

After having put into operation the machine, it is important not only to dress protective gloves and glasses, but also to use auricular protection.

Introduce into the main hopper leaves, chopped-off branches and branches, with a diameter that has not to be bigger than 3 cm and with their bigger extremity towards the hopper.

The branches bigger than 3 cm, till at maximum of 6 cm of diameter, have to be inserted into the pipe for stubs with their bigger extremity towards the blade for stubs. In order to obtain the best operation of the machine, with the best conditions of the triturating process, it is necessary to seize the branch with both hands and introduce it into the hopper accompanying it gradually towards the cutting group.

When it becomes impossible keeping the material with the hands, it is necessary to let it go into the rotor. If a lot of leaves are introduced, without being intercalated by little branches, the material descent towards the cutting instrument could be difficult. For this reason, it can be helpful pushing the material left, using a branch with a diameter not bigger than 3 cm.

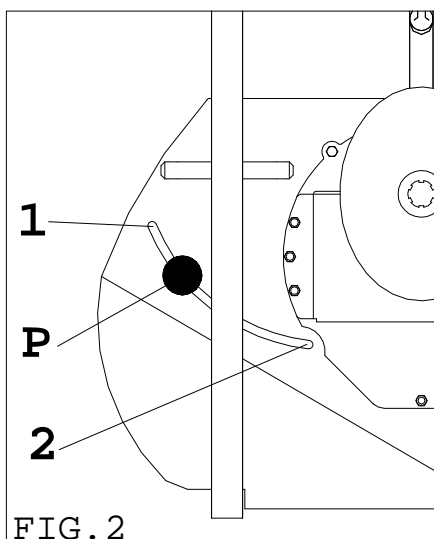

The triturating machine R130T is provided with a mobile screen that guarantees the refining of the triturated material both humid and dry. It is necessary to move the screen head (P) towards position “1”, if you do not want to obtain a fine triturated result or if you have to grind humid or wet material. On the contrary, in order to obtain a fine triturated result or if you have to triturate dry material, move the screen head towards position “2” (see FIGURE 2).

In order to obtain a good operation of the machine use a material introducing speed that allows the

tractor engine to work always over its maximum torque.

If you have to triturate wet or fibrous material, such as linden tree, pine tree and palm, it is important to reduce the introducing speed in order to prevent the machine clogging.

ACCIDENTAL CASES AND RELATIVE BEHAVIOURS TO FOLLOW THE BIOSHREDDER DOES NOT IDLE

Follow the instruction manual of the engine and if the Bio-Shredder doesn't still idle call the nearest Honda or Robin Assistance Centre. The addresses and telephone numbers are inside the Manual called SERVICE delivered with the engine and operator's manual.

RECOILING EFFECT ON THE HAMMERS

During the material descent, there could be a recoiling effect on the hammers.

In order to avoid it, it is important to introduce the material keeping it very well with both hands and accompanying its descent towards the cutting instrument gradually.

LOCKING OF THE CUTTING GROUPE BECAUSE OF THE TOO MUCH MATERIAL INSERTED OR THE ACCIDENTAL DESCENT OF BIG STONES OR METALS

(Use the exploded view and the bill of materials at the end of the manual)

The triturating group has to be stopped. Open the screen "P" in position "1" (FIGURE 2) and clean the triturating group from the exceeding material. Now, it is possible to move the screen towards its original position ("2" in FIGURE 2) and ignite the triturating machine. Each time that the machine stalls, before igniting the unit, it is important to check the condition of the triturating group (hammers, blades, pivots).

LOCKING OF THE BIOSHREDDER DUE TO THE LACK OF FUEL

In this case you have to fill the tank but you must not re-start the machine because you could cause the braking for overheating of the clutch and the belts. Before igniting the triturating machine, it is important that the cutting group is free from any material; in order to do this, it is necessary to open the screen and clean it, as it is described in the previous paragraph "TRITURATING GROUP LOCKING".

EXCESSIVE VIBRATIONS

The reasons could be: unbalance of the cutting group caused by the inclination of one or more shafts that support the hammers; breakage of one or more hammers or blades; loosen transmission parts. Find out the source of the problem and call the technician.

MAINTENANCE

Before every control or maintenance or cleaning-work you have to switch off the motor, in the case of an electric engine machine disconnect the feeding rope. Wear working gloves.

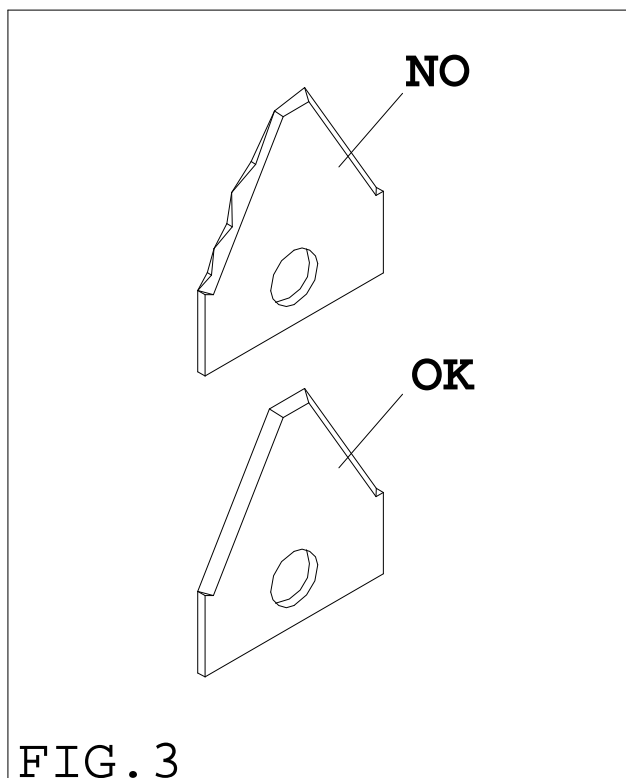

FIG. 3

Cleaning of the Bio-Shredder: take off the tube as described in the previous paragraph *Accidental Cases* and take out the possible tailings of vegetable trashes remained inside taking care not to cut yourself: "the cutting-tools are dangerous". Reassemble everything.

Control, rotation and change of the hammers: check periodically about every 50 working-hours the wear of the hammers' teeth (Fig.3).

In order to do this, it is necessary to open the screen putting it in position "1".

If the hammer were deteriorated or chipped, it has to be turned towards that part in which the cutting instrument is still complete or it is possible to substitute it if it cannot be used.

If some hammers break, they have to be substituted if the left ones remain complete, on the contrary they can be substitute in order to prevent any vibration during their use. In order to substitute the hammers (use TABLE 44) open the screen no. 35 using the screen head no. 33, take away the cover no. 6 unscrewing the 4 nuts no. 4 and disassemble the rest group no. 7 unscrewing the 6 nuts no. 4 using the wrench no. 13. Take away the covers no. 20 and no. 37 with a wrench no. 13. From the two openings, thread both a socket screw NO. 5 and a bush no. 30 and unscrew the screws no. 29. After this, it is necessary to pull out the rotor pivots no. 21, only after this operation the hammers and its spacers will fall down. Pay attention while assembling

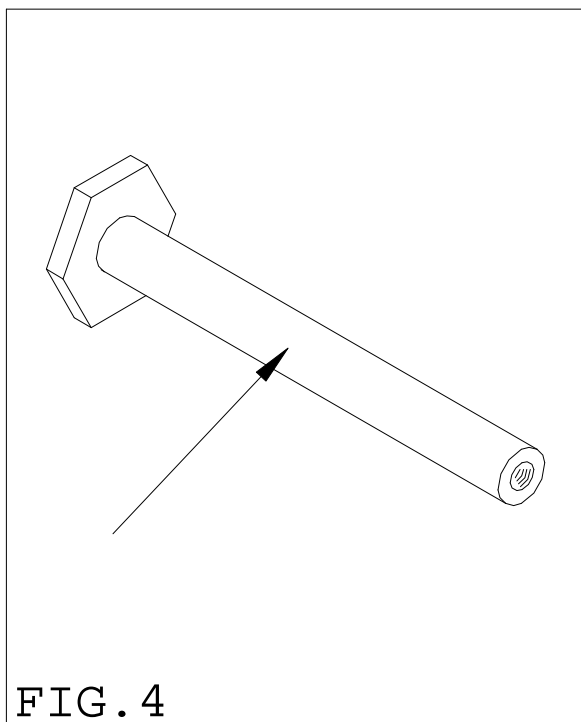

FIG. 4

the gudgeon, the distance rings and the hammers, as they were at the beginning. A wrong assembly of the hammers and of the distance rings, will cause dangerous vibrations to the machine. The substitution or the rotation of the cutting instrument has to be effected only if there is a wear, as it is shown in FIGURE 3, using original spare parts belonging to NEGRI SRL's firm.

Check also the condition of the pivots, as it is indicated in FIGURE 4.

The substitution has to be effected when the pivot diameter suffers a reduction of 4/5 mm.

Also in this case, it is important that the spare parts used are the original ones belonging to NEGRI SRL's firm.

Control, sharpening and change of the blades: control every 50 hour's work the usury of the blades points (fig.5). In order to do this it is necessary to disassemble the cover no. 37 with a wrench no. 13 and open the screen no. 35 using the head screen no. 33 (TABLE 44).

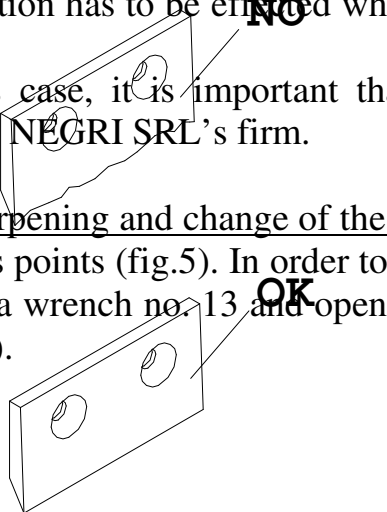

FIG. 5

To take away the blade, you have to use a socket screw no. 6 and a wrench no. 17 for the respective nut (TABLE 44, no. 28 and no. 26). During the sharpening keep the blade wet in order to avoid its softening, sharp only the raking side . Substitute the blades after twice sharpening. Use VSP and new nuts when assembling the blades. Carry out this operation for both blades. A wrong assembly will cause harmful vibrations.

During the replacing you have to use only original spare parts marked with the name of the manufacturer. The operator will easily find these original spare parts by the builder firm NEGRI SRL. In case they have been subjected to heavy impacts or blows, a technician must test them.

Elastic joint check (see TABLE 44)

In order to check the joint wear (12) disassemble the cover for the rest group (6) unscrewing the 4 nuts (4). Moving the joint with both hands check that there is no clearance. If it is present it is necessary to substitute it. In order to substitute the joint you have to disassemble the rest group (7), unscrewing the 6 nuts (4), loosen the 2-security dowels (11) and pull out the 2 joints (12). Substitute the complete joint assembling every piece following the contrary process.

Lubricating level

Group oil: unhook the casing for the cardan joint (3) unscrewing the 4 fixing screw (1) with a wrench-bush no. 13, and check the oil level.

If the lubricant is substituted, the quantity has to be of 0,5 litres. Oil type SAE 80W-90.

Daily Maintenance

Clean the machine externally.

The nuts and the screws must be tightened

The protections mustn't be defective and they must be well fixed to the machine.

Extraordinary Maintenance

Control the blades state (27) every 50 hours.

Control the hammers state (24) every 50 hours.

Verify the rotor gudgeons (21) state every changing of the hammers .

Verify the usury and the play and the wear of the joint (12) every 100h/1year

Every 600 hours/2 years change the hydraulic oil (SAE 80W-90).

REPLACE

At the end of every use stop the tractor . Clean the cutting group . Replace the Bio-Shredder under cover .

WARRANTY

NEGRI SRL's firm guarantees this machine, against defects of manufacture and the ones related to the materials, for a period of 2 years starting from the date in which the machine has been bought. The guarantee is valid for every person who acts according to purposes that do not form part of its commercial or professional activity. The conditions of guarantee are in conformity with the European Directive 1999/44/CE.

For people who use the product for a professional use, the guarantee is valid only if accompanied by the check or the guarantee certificate (attached to this booklet), filled by the seller and sent within 10 days from the purchase date.

As regards the internal combustion engines and the electrical ones is valid the guarantee given by the engine builders, that is to say 1 year.

The guarantee excludes every responsibility related to direct or indirect damages to people or things and its effect ends if the pieces returned were stripped down, tampered or repaired by no authorised centres. The damages caused by the non-respect of the instruction use are not recognised.

The parts that are used a lot and for this reason get consumed, such as for example, gaskets, chains, belts, valves, bearings, hydraulic pipes, blades, etc., are excluded by the guarantee.

EMISSION OF NOISE

The acoustic pressure to the operator's ear is in conformity with EN ISO 11201 modified by the rules relating to the machine: 100-dB (A).

TECHNICAL DATA

Total length: 1157 mm

Total width: 768 mm

Total height: 1459 mm

Introduction height of the main hopper: 1230 mm

Introduction height of the stub pipe: 496 mm

Opening of the introduction-funnel: 403x403 mm

Weight: 81,5 Kg.





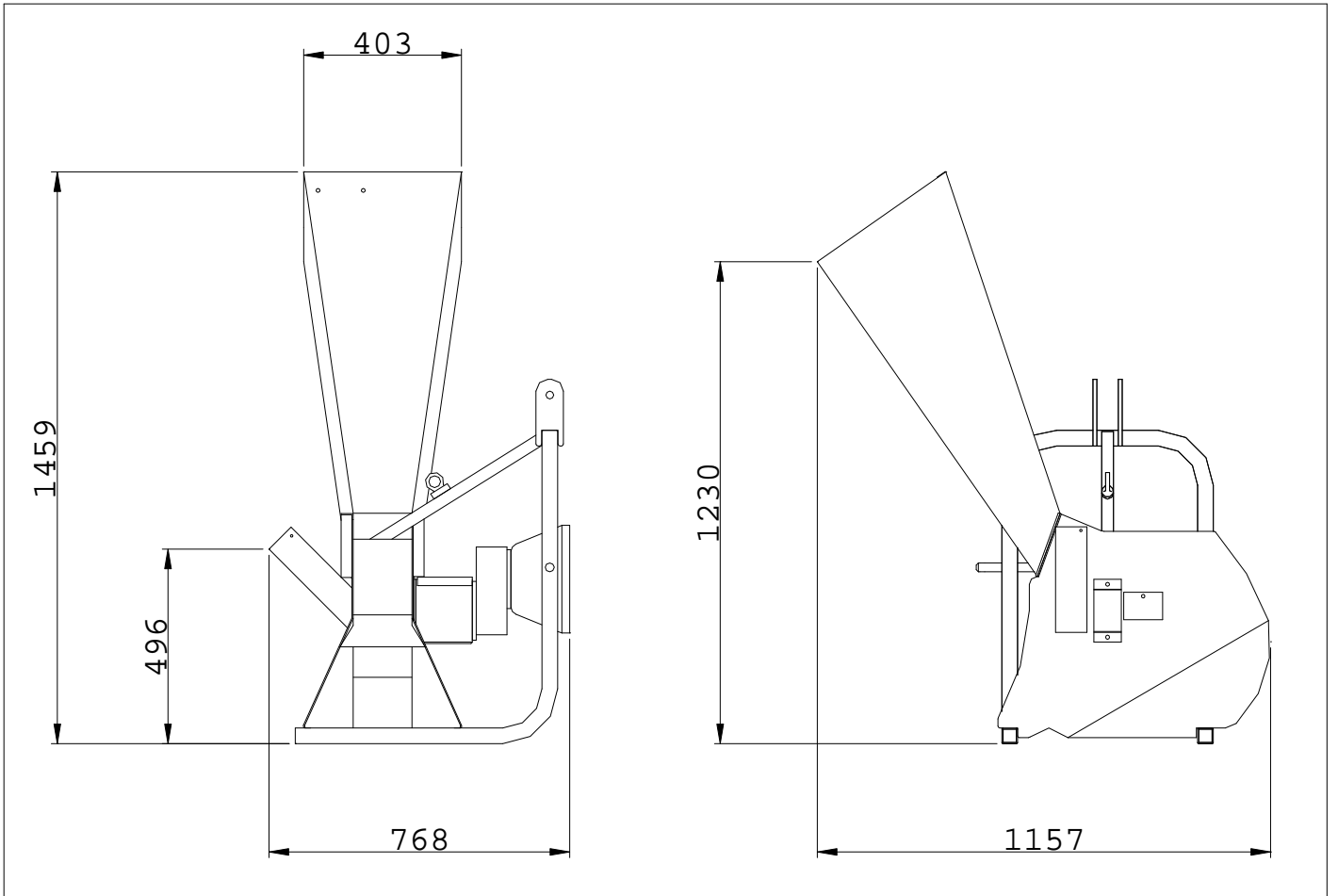

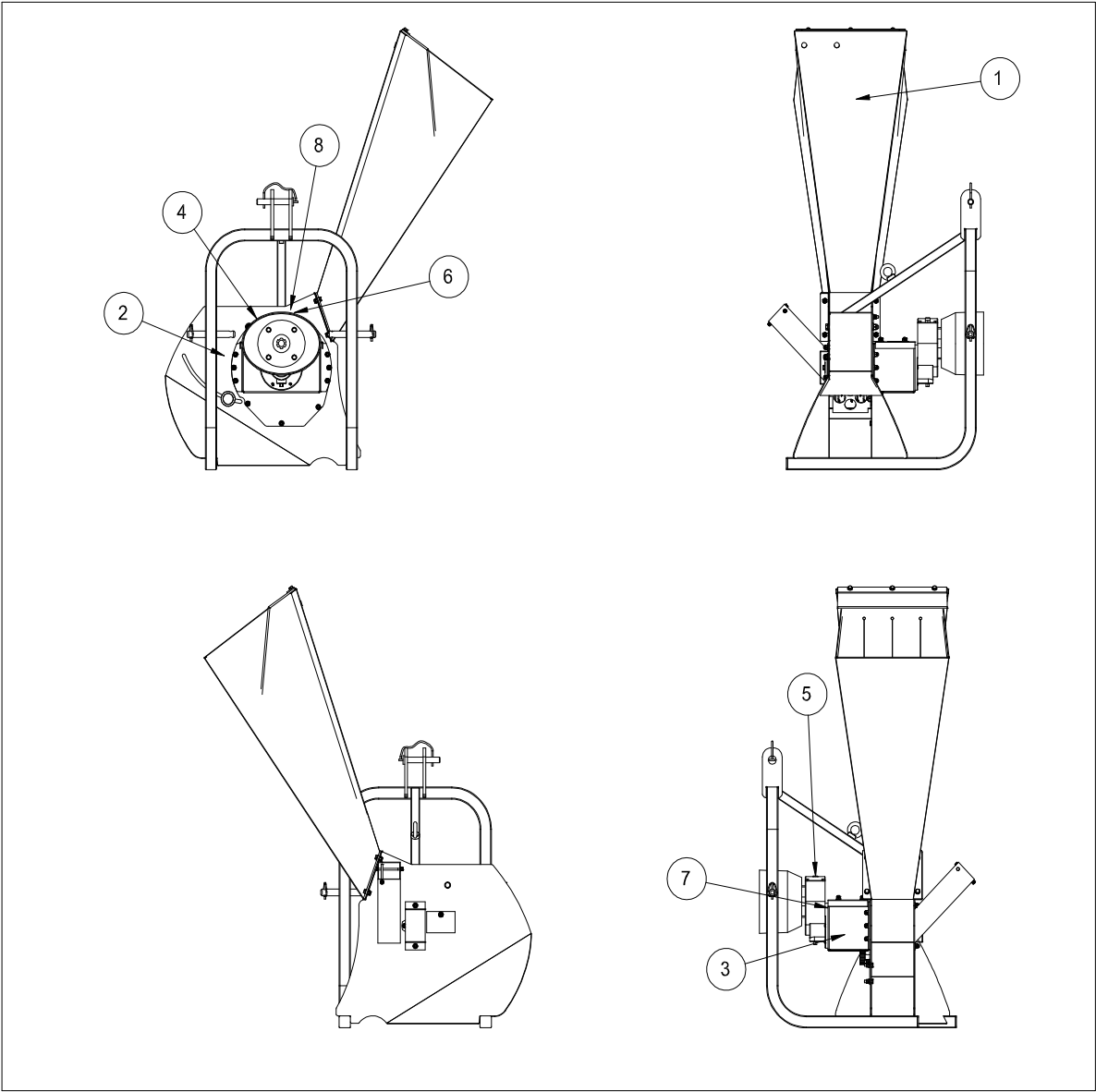

Power : minimum HP15

Power takeoff revolutions : 540 r.p.m.



Warnings and security instruction



| N° | CODE | PICTURE | DESCRIPTION |
|----|--------|---|------------------------------|
| 1 | AD0093 |  | Complete sticker R130 |
| 2 | AD0084 |  | Attention – Rotating rollers |
| 3 | AD0028 |  | Identification plate |
| 4 | AD0024 |  | Direction of rotation |
| 5 | AD0025 |  | Oil gearbox |
| 6 | AD0022 |  | Maximum speed PTO 540 rpm |
| 7 | AD0025 |  | Oil level |
| 8 | AD0062 |  | Hook |

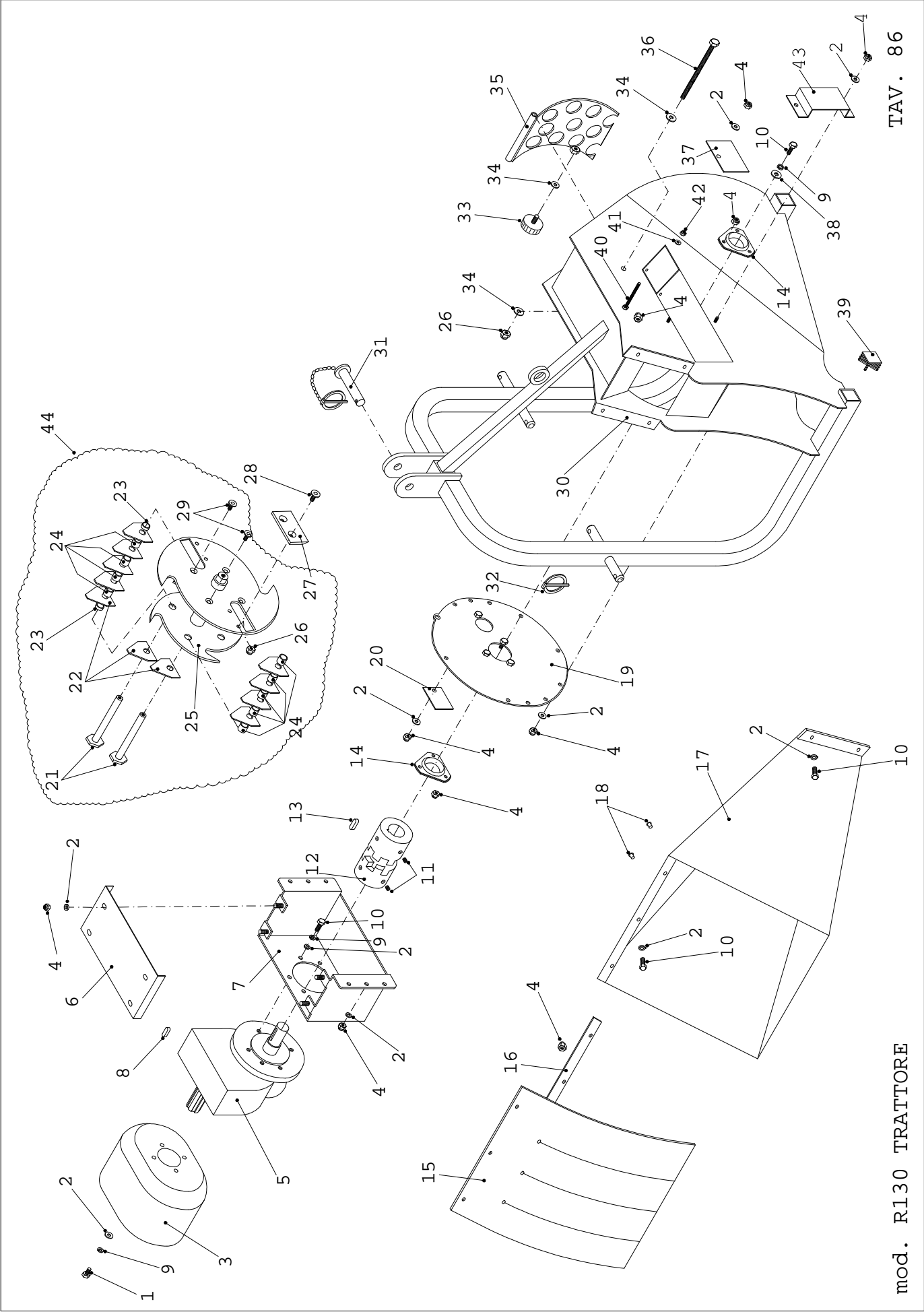

TAV. 86

mod. R130 TRATTORE

Bio-shredder R130T

| Nr. | Code | Description | | | Qt. |
|------------|---------------|--|--|--|------------|
| 1 | V815Z | VITE 8X15 ZINC. VIS 8X15 | SCREW 8X15 SCHRAUBE 8X15 | TORNILLO 8X15 BOUT 8x15 | 4 |
| 2 | RP8Z | RONDELLA PIANA 8 ZINCATA RONDELLE PLAINE 8 | PLAIN WASHER 8 SHEIBE 8 | ARANDELA 8 VLAKKE RING 8 VERZINKT | 35 |
| 3 | R220737 | CUFFIA PER CARDANO PROTECTION | PROTECTION SCHUTZ | PROTECCION AFSCHERMING | 1 |
| 4 | M8AUTZ | DADO M8 AUTOBL. ZINCATO ECROU M8 | NUT M8 MUTTER M8 | TUERCA M8 ZELFBORGENDE MOER M8 VERZINKT | 31 |
| 5 | A-1A | GRUPPO MOLTIPLICATORE COD 600.315 MULTIPLICATEUR DE VITESSE COD 600.315 | OVERDRIVE COD 600.315 UBERSETZUNGSGETRIEBE COD 600.315 | APARATO MULTIPLICADOR CD 600.315 | 1 |
| 6 | R130800 | COPERCHIO SUPPORTO COUVERCLE SUPPORT | SUPPORT-COVER DECKSEL FUR HALTER | TAPADERA PARA SOSTEGNO DEKSEL | 1 |
| 7 | R130799 | SUPPORTO GRUPPO SUPPORT | SUPPORT HALTER | SOSTEN STEUN | 1 |
| 8 | 091540 | LINGUETTA 1/4" 1"1/2 CLAVETTE 1/4" 1"1/2 | KEY 1/4" 1"1/2 HOHLKEIL 1/4" 1"1/2 | CHAVETA 1/4" 1"1/2 SPIE 1/4" 1"1/2 | 1 |
| 9 | RE8Z | RONDELLA ELAST. 8 ZINCATA RONDELLE ELASTIQUE | FLEXIBLE WASHER ELASTISCHE SCHEIBE | ARANDELA ELASTICA GETANDE RING | 7 |
| 10 | V820Z | VITE 8X20 ZINC. VIS 8X20 | SCREW 8X20 SCHRAUBE 8X20 | TORNILLO 8X20 BOUT 8X20 | 14 |
| 11 | GRANO M810 | GRANO M8x10 UNI5927 VIS M8x10 UNI5927 | STOP DOWEL M8x10 UNI5927 STELLSCHRAUB M8x10 UNI5927 | TORNILLO M8x10 UNI5927 DRAADSTUCKJE M8x10 UNI5927 | 4 |
| 12 | R130798 | GIUNTO 42/55A PER R130T JOINT | JOINT KUPPLUNGSTUCK | JUNTA VERBINDING | 1 |
| 13 | B8730 | LINGUETTA 8X7X30 CLAVETTE 8X7X30 | KEY 8x7x30 HOHLKEIL 8x7x30 | CHAVETA 8x7x30 SPIE 8x7x30 | 1 |
| 14 | 205NPPB | CUSCINETTO TRIANGOLARE 205NPPB COUSSINET | BEARING LAGER | COJINETE LAGER | 2 |
| 15 | 150.0026.97 | GOMMA DI PROTEZIONE PROTECTION EN CAOUTCH. | PROTECTION OF RUBBER GUMMISCHUTZ | GOMA VULCANIZADA PARA PROTECCION- RUBBERSTRIP | 1 |

| | | | | | |
|----|----------|---|---|---|----|
| 16 | R10155 | PIATTO DI SOSTEGNO APPUIE CAOUTCHOUC | SUPPORT FOR RUBBER LAGER FUR GUMMI | SOSTEN PARA GOMA VULCANIZADA-STEUN VOOR RUBBERSTRIP | 1 |
| 17 | R130801 | TRAMOGGIA TREMIE | HOPPER TRICHTER | TOLVA DE CARGA INVOERTRECHTER | 1 |
| 18 | TAPPO10 | TAPPO BOUCHON | PLUG PFROPFEN | TAPA STOP | 2 |
| 19 | R130797 | COPERCHIO FLANGIA COUVERCLE POUR BRIDAGE | COVER FOR FLANGE FLANSCHDEKSEL | TAPADERA POR ARANDELA DEKSEL VOOR FLENS | 1 |
| 20 | R20126 | COPERCHIO FORO PERNO COUVERCLE TROU DU GOUJON | COVER FOR GUDGEON'S HOLE DECKEL FUR GELENKZAPFENLOCH | TAPADERA PARA ORIFICIO DE PERNO DEKSEL | 1 |
| 21 | IR10096 | PERNO ROTORE GOUJON DU ROTOR | GUDGEON FOR ROTOR GELENKZAPFEN FUR ROTOR | PERNO PARA ROTOR PEN VOOR ROTOR | 4 |
| 22 | R180610 | MARTELLO MARTEAU | HAMMER HAMMER | MARTILLO HAMER | 22 |
| 23 | R10159 | DISTANZIALE 8 PIECE D'ENTRETOISEMENT | DISTANCE RING ABSTANDSTUCK | ESPESOR AFSTANDSRING | 2 |
| 24 | R10171 | DISTANZIALE D25X3 L.19.3 PIECE D'ENTRETOISEMENT | DISTANCE RING ABSTANDSTUCK | ESPESOR AFSTANDSRING | 16 |
| 25 | IR130088 | ROTORE ROTOR | ROTOR ROTOR | ROTOR ROTOR | 1 |
| 26 | M10AUTZ | DADO M10 AUTOBL. ZINCATO ECROU M10 | NUT M10 MUTTER M10 | TUERCA M10 ZELFBORGENDE MOER M10 VERZINKT | 5 |
| 27 | R10091 | LAMA COUTEAU | CUTTER MESSER | REGADERAS SNIJMES | 2 |
| 28 | VSP1025 | VITE VSP 10X25 VIS VSP10X25 | SCREW VSP 10X25 SCHRAUBE VSP 10X25 | TORNILLO VSP 10X25 BOUT VSP 10X25 | 4 |
| 29 | VSP820 | VITE VSP 8X20 VIS VSP 8X20 | SCREW VSP 8X20 SCHRAUBE VSP 8X20 | TORNILLO VSP 8X20 BOUT VSP 8X20 | 4 |
| 30 | R130796 | CORPO MACCHINA FOND | BOTTOM GRUND | CUERPO CHASSIS | 1 |
| 31 | 33456E | PERNO PER ATT. 3P D19 GOUJON | GUDGEON GELENKZAPFEN | PERNO PERN | 1 |

| | | | | | |
|----|------------|--|--|---|---|
| 32 | SP.SC.6 | SPINE A SCATTO GOUPILLE | PIN STIFT | ESPINE VEERPENNEN | 2 |
| 33 | D501020 | VOLANTINO 50 M10X20 VOLANT A MAIN | KNOB KNOPF | POMITO HANDWIEL | 1 |
| 34 | RP10Z | RONDELLA PIANA 10 ZINCATA RONDELLE PLAINE 10 | PLAIN WASHER 10 SCHEIBE 10 | ARANDELA 10 VLAKKE RING 10 VERZINKT | 3 |
| 35 | R130622 | VAGLIO GRILLE | GRILLE GITTER | CRIBA ROOSTER | 1 |
| 36 | V10180Z | VITE 10X180 T.E.ZINCATA VIS 10X180 | SCREW 10X180 SCHRAUBE 10X180 | TORNILLO 10X180 BOUT 10X180 | 1 |
| 37 | R10088 | COPERCHIO FORO LAMA COUVERCLE | COVER DECKEL | TAPADERA BOVENSTE DEKSEL | 1 |
| 38 | RP832Z | RONDELLA PIANA 8X32 ZINC. RONDELLE PLAINE | PLAIN WASHER 8X32 SCHEIBE | ARANDELA 8X32 RING 8X32 | 1 |
| 39 | PUNT.40X40 | PUNTALE ALETTATO QUADRO 40X40 BOUCHON 40X40 | RUBBER CAP 40X40 GUMMISTOPFEN 40X40 | TAPON EN GOMA 40X40 RUBBERSTOP 40X40 | 2 |
| 40 | V690Z | VITE T.E. M6X90 ZINC. VIS M6X90 | SCREW M6X90 SCHRAUBE M6X90 | TORNILLO M6X90 BOUT M6X90 | 2 |
| 41 | RP6Z | RONDELLA PIANA 6 ZINCATA RONDELLE PLAINE 6 | PLAIN WASHER 6 SCHEIBE 6 | ARANDELA 6 VLAKKE RING 6 VERZINKT | 2 |
| 42 | M6AUTZ | DADO M6 AUTOBL. ZINCATO ECROU M6 | NUT M6 MUTTER M6 | TUERCA M6 ZELFBORGENDE MOER M6 VERZINKT | 2 |
| 43 | R10516 | COPRICUSCINETTO PROTECTION COUSSINET | PROTECTION FOR BEARING SCHUTZ FUR LAGER | PROTECCION PARA COJINETE LAGERBESCHERMING | 1 |
| 44 | R130088 | ROTORE COMPLETO SENZA LAME ROTEUR | ROTOR ROTOR | ROTOR ROTOR | 1 |

CERTIFICATO DI GARANZIA

DA COMPILARE DA PARTE DEL RIVENDITORE
A REMPLIR PAR LE DÉTAILLANT
TO FILL BY THE SUPPLIER
FÜR DEN VERKÄUFER: BITTE, FULLEN SIE DAS AUS
VOOR DE VERKOPER: GELIEVE DIT IN TE VULLEN

NOME E INDIRIZZO DEL RIVENDITORE
NOM ET ADRESSE DU DÉTAILLANT
NAME AND ADDRESS OF SUPPLIER
NAME UND ADRESSE DES VERKÄUFERS
NOMBRE Y SEÑAS DEL REVENDEDOR
NAAM EN ADRES VAN DE DEALER

NOME E INDIRIZZO DEL CLIENTE
NOM ET ADRESSE DU CLIENT
CUSTOMER'S NAME AND ADDRESS
NAME UND ADRESSE DES KUNDEN
NOMBRE Y SEÑAS DEL CLIENTE
NAAM EN ADRES VAN DE KLANT

DATA DI VENDITA
DATE DE VENTE
DATE OF PURCHASE
VERKAUFSDATUM
DATA DE VENTA
DATUM VAN DE VERKOOP

MODELLO
MODÉLE
MODEL
MODELL
MODELO
MODEL

TIMBRO E FIRMA DEL RIVENDITORE
TIMBRE ET SIGNATURE DU DÉTAILLANT
STAMP AND SIGNATURE OF SUPPLIER
FIRMENSTEMPEL UND UNTERSCHRIFT DES VERKÄUFERS
SELLO Y FIRMA DEL REVENDEDOR
STEMPEL EN HANDTEKENING VAN DE DEALER



Via Motella 33 – Campitello(MN) Italia
Tel.0376/926162-Fax 0376/925329
Email: info@negri-bio.com
www.negri-bio.com