



INTERMAC srl

Via Vegri, 271 – 45036 Ficarolo (RO)

C.F./ P.I. IT00756310298 Registro Imprese Rovigo Nr. 00756310298 C.Sociale I.V. €46.800,00

Tel. +39 0425 727016 Fax +39 0425 727253

laea@procomas.it www.intermacsrl.it



MANUAL CE
SWEEPER MACHINE
ST120-150-180C

Work book for use and maintenance of machines type

ST120 - ST150 - ST180

INTRODUCTION



For a better use and for conserve for a long time these machine our company INTERMAC S.r.l. give you some practical advices to avoid unpleasant drawback. We advice you to read carfully the instructions of this manual. This manual should be considered a permanent part of your machine and should remain with the machine when you sell it.

If you don't understand some part of this manual and you need assistance, contact your dealer or the manufacturer .

INDEX

INTRODUCTION ON MANUAL CE.....	PAG. 2
IDENTIFICATION OF MACHINE.....	PAG. 3
SPECIFICATIONS OF MACHINE.....	PAG. 3
LUBRICATION POINTS	PAG. 4
CHECK CHAIN PULL.....	PAG. 4
INSTRUCTIONS FOR USE OF THE MACHINE.....	PAG. 4
DANGER SIGNS.....	PAG. 5
ADJUSTING WORKING HEIGHT.....	PAG. 5
UNLOADING WITH HYDRAULIC DRIVE	PAG. 6
MANUAL UNLOADING.....	PAG. 6
REPLACING OF BRUSH.....	PAG. 6
CAUTION WORKING CYCLE.....	PAG. 7
WASHING OF THE MACHINE.....	PAG. 7
REST OF MACHINE.....	PAG. 7
SAFETY REGULATIONS	PAG. 7
WARRANTY CONDITIONS AND SPARE PARTS.....	PAG. 8
SPARE PARTS LIST N° 20.....	PAG. 9
LEGEND SPARE PARTS LIST N° 20.....	PAG. 10
SPARE PARTS LIST N° 21 AND RELATIVE LEGEND.....	PAG. 11
SPARE PARTS LIST N° 23 AND RELATIVE LEGEND.....	PAG. 12
SPARE PARTS LIST N° 24 AND RELATIVE LEGEND.....	PAG. 13
SPARE PARTS LIST N° 25 AND RELATIVE LEGEND.....	PAG. 14
	PAG. 15

IDENTIFICATION OF MACHINE

	ntermac S.r.l.	Via Vegri 271 Ficarolo (RO)	
MOD.	ST120/C	MADE IN ITALY	CE
MATR.	100		
P.D.F. g/min	540	Massa Kg	147
		Anno	1995
Lubrificazione			
Comando oleodinamico	AGIP OSO 46		
Scatola Ingranaggi	AGIP ROTRAMP80W90		
Lubrificazione a grasso	AGIP GRMU EP 2		

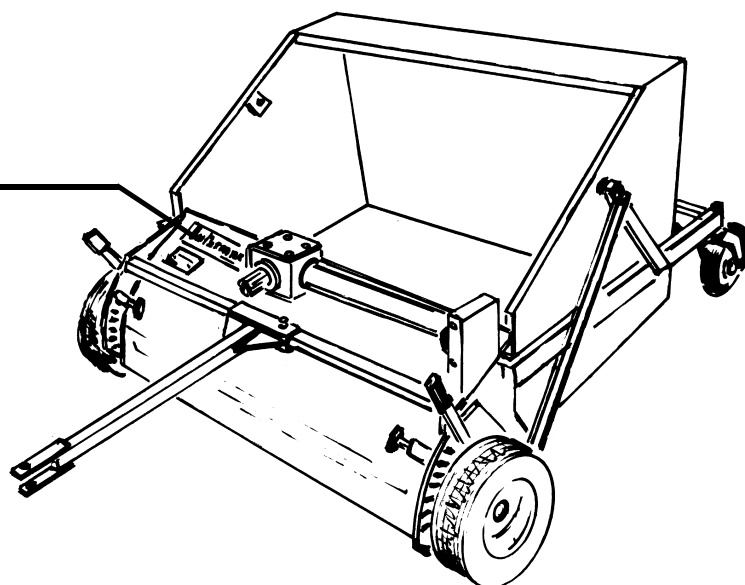

Identification plate machine: with the following informations:

- Name and address of building company.
- Year of sale and CE mark.
- Model of machine and number of registration for the identification.
- P.T.O./r.p.m. of mini-tractor
- Weight of machine.
- Lubrication: types of lubricating oil.

TECHNICAL SPECIFICATIONS OF MACHINE

MODEL	ST120	ST120C ST120MI	ST120MT	ST150C ST150MI	ST150MT	ST180C ST180MI	ST180MT
WORKING WIDTH	120	120	120	150	150	180	180
BASKET CAPACITY MC	0,6	0,6	0,6	0,75	0,75	0,9	0,9
BASKET CAPACITY KG.	100	100	100	125	125	150	150
POWER REQUEST	3-4 CV	3-4 CV	3-4 CV	4-5 CV	4-5 CV	4-5 CV	4-5 CV
DIMENSIONS							
MAXIMUM WIDTH MC.	156	156	156	186	186	216	216
MAXIMUM HEIGHT MC	86	86	86	86	86	86	86
MAX. LENGHT MC.	225	225	225	225	225	225	225
MINIMUM LENGHT MC.	168	168	168	168	168	168	168
TARE WEIGHT KG.	140	147	163	170	185	210	225

LUBRICATION POINTS

GREASE LUBRICATION
GR MU EP2

A - Back wheels: lubricate
every 10 hours of work

B - Chain drive: lubricate
every 50 hours of work

C - Angle gear lubricated with oil
AGIP ROTRA MP 80W90
(replacing every 200 hours of work)

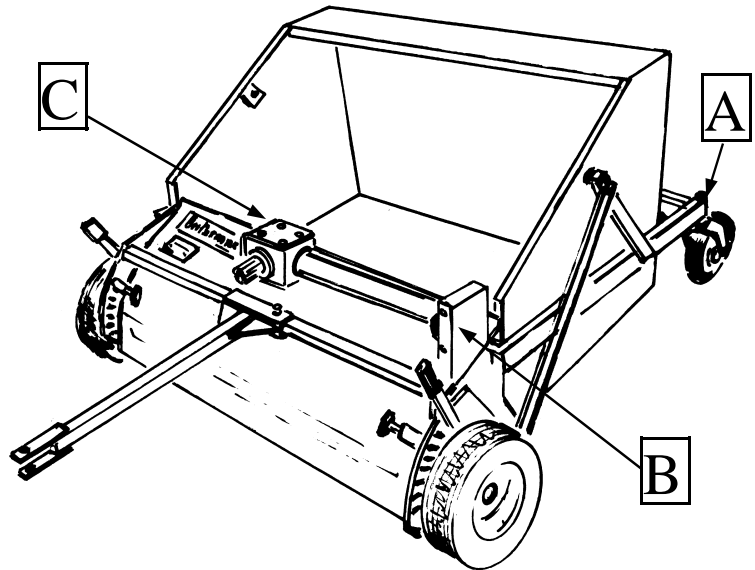

CHECK CHAIN PULL - LUBRICATION

The lubrication of chain drive must be effected every **50 hours of work** as follows:

- 1) Remove the upper protection casing unscrewing the four screws.
- 2) **CLEANING:** effect a careful cleaning of the chain, of the gears and relatives protection casing.
- 3) If the chain and the gears are worn out, proceed to the replacing.
- 4) **CHECK CHAIN PULL**, pressing in the middle of two gears, it must flex of approximately 3/5 mm. If necessary to proceed with adjusting as follows:

4/1) to loosen the 2 nuts (pos. A).

4/2) to loosen the lock nut (pos.B), and adjust the screw (pos.C) so that the chain may be taut.

4/3) To screw the lock nut (pos. B) and two nuts (pos. A).

5) To mount again the protection casing remove on the point 1).

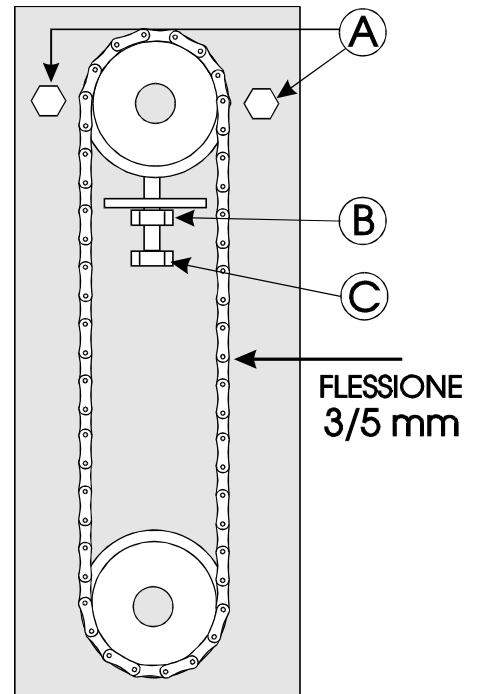

INSTRUCTIONS FOR USE OF THE MACHINE

The **brushing machine** must be use only applied on the back PTO of little and middling tractor; it's possible to have brushing machine working by wheels, by cardan and by hydraulic engine.

During the displacement period is of obligation to stop all members in movement of machine, disconnecting the PTO.

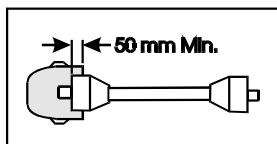
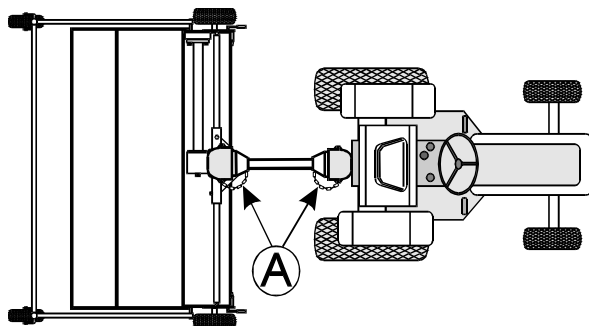

TO PAY ATTENTION: always fix the safety-device of cardan shaft by special chains (pos. A) for not permit the rotation.



NOT WORK in the land where there are stones, branches, bottles or other foreign bodies cumbersomes that could damage the system collector. Not put the hands and the feet near the rotation points.

STICKER WITH DANGER SIGNS

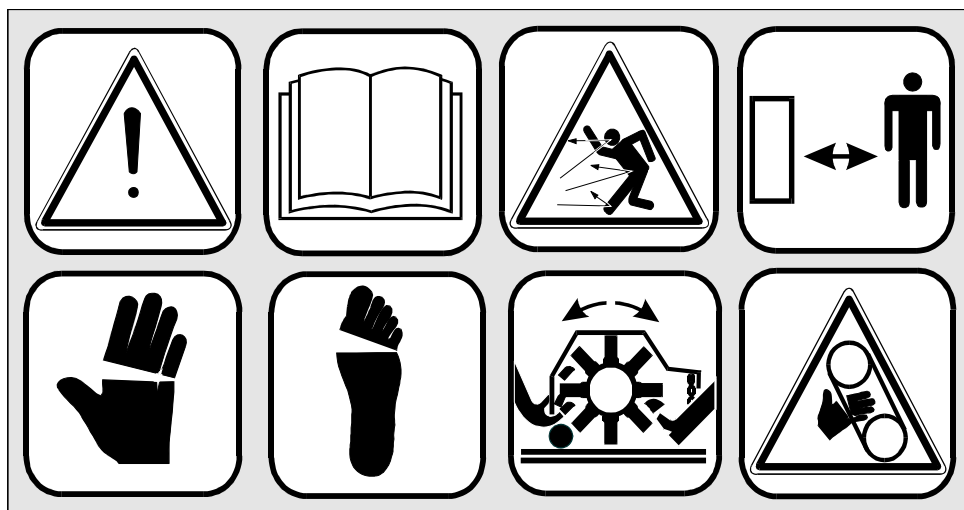

- **GENERIC DANGER**
- **TO READ WORK BOOK FOR USE AND MAINTENANCE**
- **DANGER FLINGING FORIEIGN BODIES**
- **TO KEEP THE SAFETY DISTANCE**
- **CRUSHING DANGER**
- **MEMBERS ON ROTATION**
- **CHAINS ON THE ROTATION UNDER THE CASINGS**

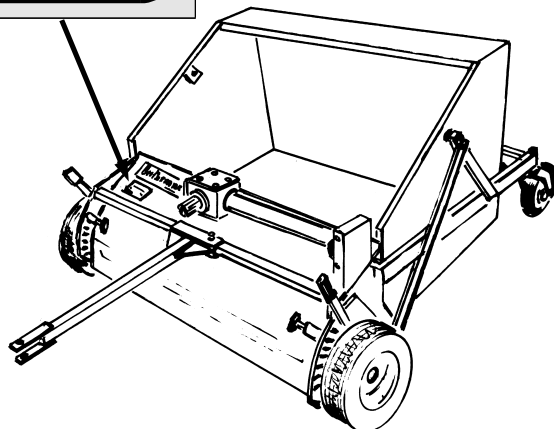

ADJUSTING WORKING HEIGHT

To effect the following operations with stationary motor-tractor, switched off engine, and P.T.O. disconnected; to pay attention to not crush the hands and the feet and always use the safety gloves.



- 1) To hitch up the obturator pos.D, to push the level pos.C in the direction (A) for to lift the brushes or in thr direction (B) for let them down.
- 2) To effect the operation indicated on the point 1) also on the opposite side
- 3) Advice for a suitable working height for collecting the grass on the grass land: to put the brushing machine on the square, adjust the brushes approximately 20/25 mm more hight of the floor.

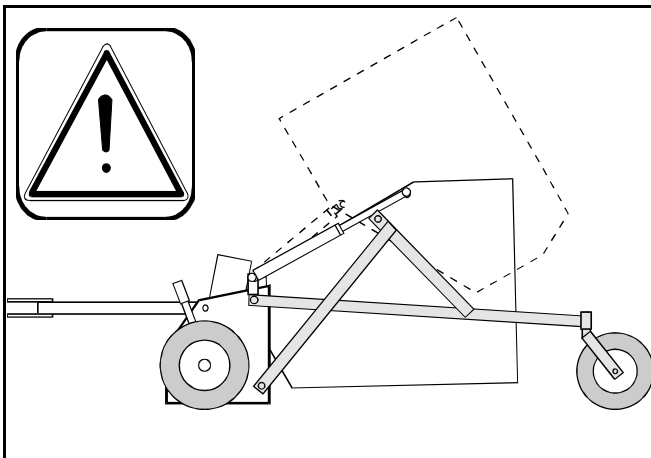
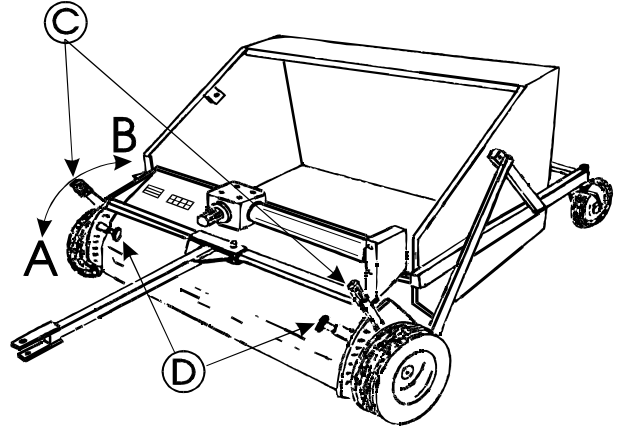

UNLOADING WITH HYDRAULIC DRIVE

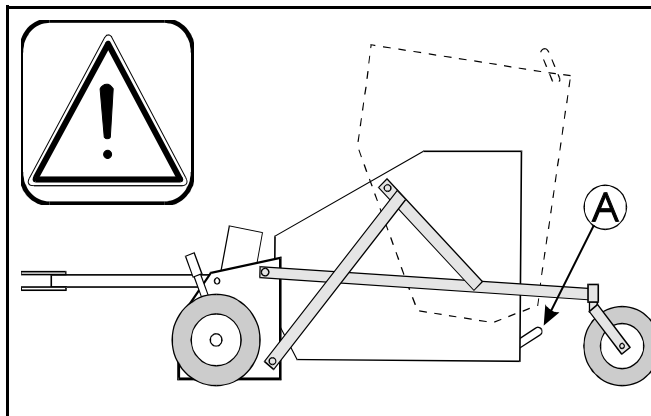

The unloading with hydraulic drive is controled by the double acting distributor present on the tractor.

To connect the rapid clutchs present on the brushing machine to the tractor.

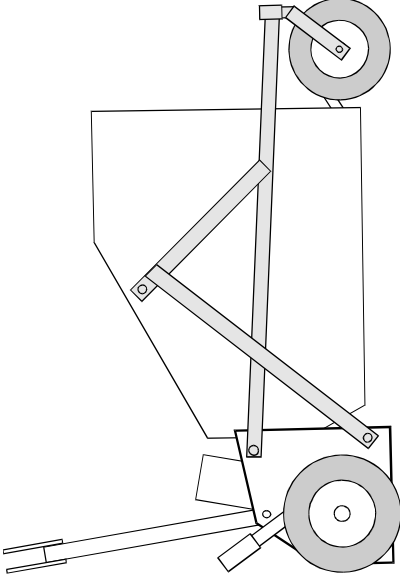

MANUALE UNLOADING

With the manual unloading, is necessary to get down from the tractor, after to have stopped all members in movement , by the handle Pos. A to turn round the collector until is empty.

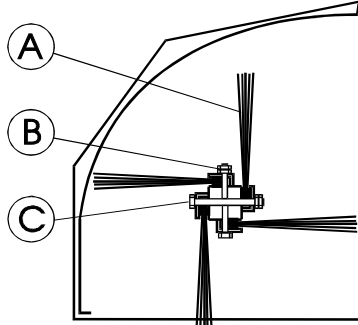



REPLACING BRUSHS

- 1) For the replacing of brushes, to arrange the brushing machine in the position indicated on the side.
- 2) To loosen all nuts and lock nuts (pos. B) locking the nuts pos. C.
- 3) To take all the brushes pos. A and to mount again the new brushes.
- 4) To grip all nuts and lock nuts loosened on the point 2.

DURING THE WORKING STROKE DISCONNECTE THE P.T.O.
On the working cycle, and during the manoeuvres, to pay attention that the cardan shaft not exceed an angulation of 35°.

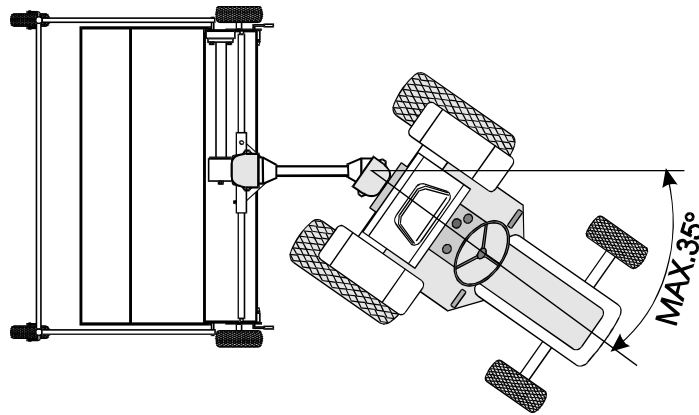
READ carefully the instructions indicated on manual CE consigned with the cardan shaft.

WASHING MACHINE

After every working day, is better to make a careful cleaning of the machine. We suggest to wash the brushing machine with a water jet for to remove the grass, the earth... and so on. These operation must be effected with the p.t.o. disconnected, stationary motor-tractor and switched off engine.

STORAGE OF THE MACHINE

If the machine don't work for a long time, we suggest you to place this in a protected and dry place, cover this with a tarpaulin.

SAFETY REGULATION

- 1) Before to start a work **read carefully** the various work book for use and maintenance supplied from the manufacturers of brushing machine, of mini tractor and of the engine.
- 2) **Always use** suitable clothes and safety gloves.
- 3) **Never touch** any mowing part.
- 4) **Never leave** the brushing machine on stop with the engine running.
- 5) **Only** expert and authorized people must use the machine.
- 6) **Never use** the machine near people and animals; pay attention during the working.
- 7) **Never remove and change** the safety devices.
- 8) **Never put** the hands and the feet near the rotation points.
- 9) **Keep safety signs in good condition, replace missing or damaged safety signs.**
- 10) **Not work** where there are stones, branch, bottles or other foreign bodies that could damage the machine and to make dangerous the work.
- 11) **To keep** to the rules in force for the traffic.
- 12) We suggest to use a slow feed.
- 13) **Not work** on the land that could make the skidding or overturning of machine.
- 14) **Not remove** the stickers and plate on the machine.
- 15) During the displacement period is of obligation **to stop** all members in movement of machine, disconnecting the p.t.o.
- 16) Before starting work become familiar with the controls and their operation.
- 17) If you don't understand any parts of this manual and need assistance **contact your dealer or the manufacturer.**

ATTENTION: not carry out these operations could be cause damages to the machine and danger for the operator.

WARRANTY CONDITIONS

The company Intermac Srl warrant the machines of own manufacturing, supplied now, a period of warranty of one year from date of delivery on faulty material, labour and shipping costs excepted.

- Any claims following the receipt of damaged goods shall be presented within 8 days from receipt of goods.
- Any damage which may be caused to persons or property is not covered by the warranty.
- The warranty is limited to the repair or replacement of definitive parts. Repair or replacement shall take place according to the manufacturer's instructions and at no charge to the customer.

THE WARRANTY DECLINE:

- When the user not read this work book.
- When the buyer introduce changes on the brushing machine.
- When there isn't a correct maintenance, use of unsuitable lubricating, replacing with not original spare parts.

SPARE PARTS

We exhort you to mount always original spare parts.

Not wait that the parts of the machine wears out from the use before to proceede of replacing; to replace a component on the opportune moment mean a better working of the machine and at the same time there is a labour saving.

Please the orders of spare parts must be passed with the following informations:

TYPE AND MODEL OF MACHINE _____ REGISTRATION NUMBER _____
(See on the identification plate present on the machine)
INVOICE N° _____ OF _____

Spare Parts List N.	Position N. on spare parts list	Description	Code on our spare parts list	Quantity

COMPLETE ADDRESS _____

WAY OF TRANSPORT _____

Our company Intermac Srl is at your disposal for any further informations regarding the use of this manual.

SPARE PARTS LIST N°20

ST120 - ST120/C-ST150/C-ST180/C

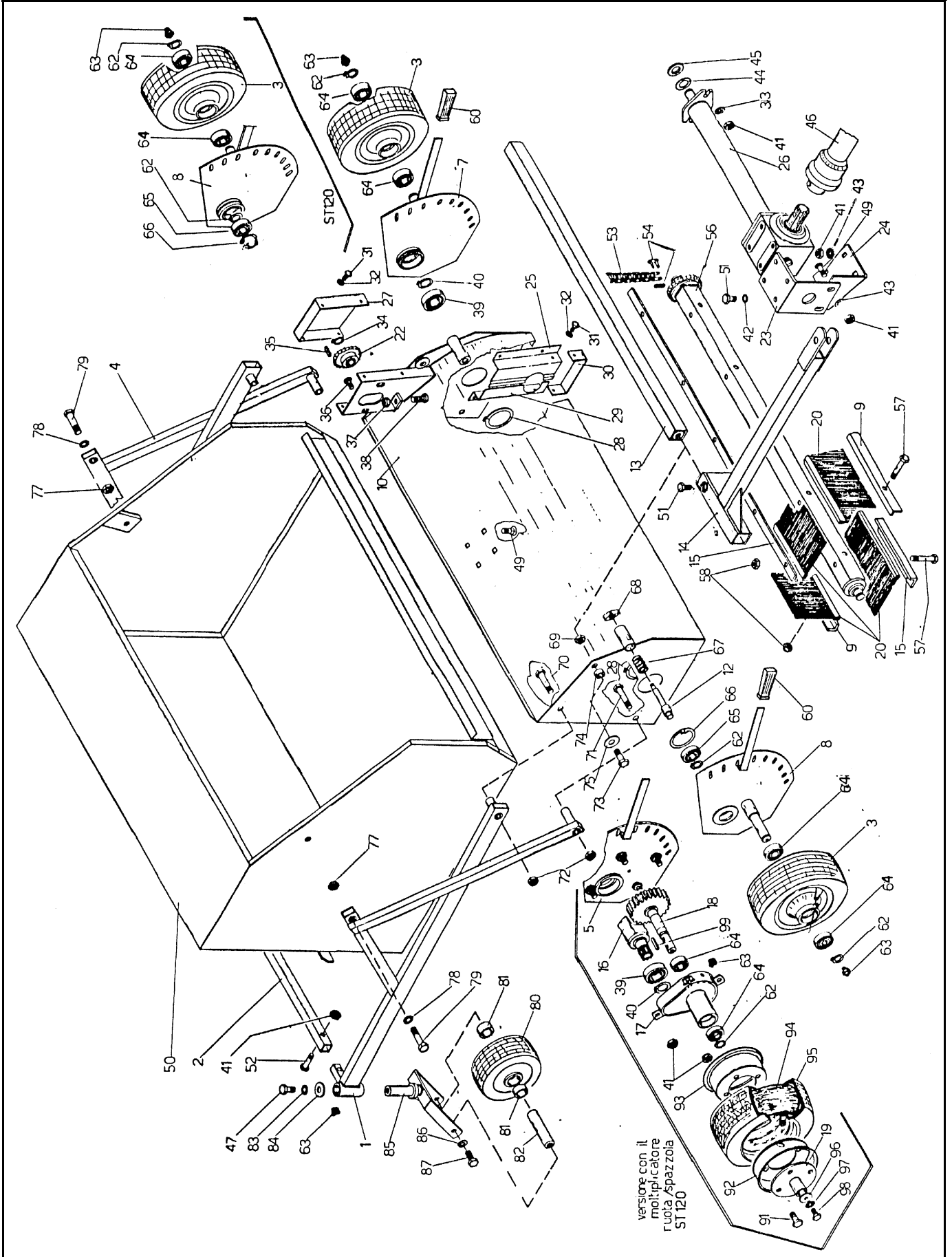

SPARE PARTS LIST N°20

ST120 - ST120/C-ST150/C-ST180/C

		ST	ST	ST	ST				ST	ST	ST	ST	
		120	120C	150C	180C				120	120C	150C	180C	
POS.	DENOMINAZIONE	Q	Q	Q	Q	CODICE ARTICOLO	POS.	DENOMINAZIONE	Q	Q	Q	Q	CODICE ARTICOLO
1	Telaio destro	1	1	1	1	03 ST120.01	47	Vite	2	2	2	2	41 TEM12X20ZN
2	Tubolare	1	1	-	-	01 ST120.02	49	Vite	-	6	6	6	41 TTQSTM10X25
2\1	Tubolare	-	-	1	-	01 ST150.02	50	Cestello	1	1	-	-	03 ST120.30/1
2\2	Tubolare	-	-	-	1	01 ST180.02	50\1	Cestello	-	-	1	-	03 ST150.30/1
3	Ruota anteriore	1	2	2	2	44 RG13X5.00-6	50\2	Cestello	-	-	-	1	03 ST180.30/1
4	Telaio sinistro	1	1	1	1	03 ST120.01/1	51	Vite	1	5	5	5	41 TEM10X20ZN
5	Supporto ruota	1	-	-	-	03 ST120.05	52	Vite	2	2	2	2	41 TEM10X45ZN
7	Supporto ruota	-	1	1	1	03 ST120.05/4	53	Catena	-	1	-	-	31 CAT38S
8	Supporto ruota	1	1	1	1	03 ST120.05/3	53\1	Catena	-	-	1	1	31 CAT12S
9	Asta ST120C	2	2	-	-	01 ST120.15	54	Maglia catena	-	1	-	-	31 GCAT38S
9\1	Asta ST150C	-	-	1	-	01 ST150.15	54\1	Maglia catena	-	-	1	1	31 GCAT12S
9\2	Asta ST180C	-	-	-	1	01 ST180.15	56	Albero porta strip	-	1	-	-	03 ST120.16/2
10	Carter ST120	1	-	-	-	03 ST120.11	56\1	Albero porta strip	-	-	1	-	03 ST150.16/2
10\1	Carter ST120C	-	1	-	-	03 ST120.11/1	56\2	Albero porta strip	-	-	-	1	03 ST180.16/2
10\2	Carter ST150C	-	-	1	-	03 ST150.11/1	57	Vite	10	10	10	-	41 TEM8X100ZN
10\3	Carter ST180C	-	-	-	1	03 ST180.11/1	57\1	Vite	-	-	-	14	41 TEM8X110ZN
12	Perno otturatore	2	2	2	2	01 ST120.12	58	Dado	10	10	10	14	42 DM8ZN
13	Traversa	1	1	-	-	02 ST120.13	60	Manopola gomma	2	2	2	2	45 MAN25X10
13\1	Traversa	-	-	1	-	02 ST150.13	62	Anello seeger	2	3	3	3	26 SDE25
13\2	Traversa	-	-	-	1	02 ST180.13	63	Ingrassatore	4	4	4	4	43 INGR6D
14	Timone traino	1	1	1	-	03 ST120.14	64	Cuscinetto	4	4	4	4	22 6205 RS
15	Asta ST120C	2	2	-	-	01 ST120.15/1	65	Cuscinetto	4	4	4	4	22 6205 2RS
15\1	Asta ST150C	-	-	2	-	01 ST150.15/1	66	Anello seeger	1	1	1	1	26 SDI52
15\2	Asta ST180C	-	-	-	2	01 ST180.15/1	67	Molla otturatore	2	2	2	2	01 U135.07
16	Albero	1	-	-	-	03 ST120.16	68	Maniglia	2	2	2	2	45 MANM6
17	Scatola ruota	1	-	-	-	03 ST120.17	69	Dado	2	2	2	2	42 DM16ZN
18	Albero	1	-	-	-	03 ST120.18	70	Vite	2	2	2	2	41 TEM12X90ZN
19	Flangia	1	-	-	-	02 ST120.19	71	Vite	2	2	2	2	41 TEM12X110ZN
20	Strip ST120C	4	4	-	-	48 ST120.20	72	Dado autobl.	4	4	4	4	42 DAUTM12
20\1	Strip ST150C	-	-	4	-	48 ST150.20	73	Vite	2	2	2	2	41 TEM16X60ZN
20\2	Strip ST180C	-	-	-	4	48 ST180.20	74	Distanziale	2	2	2	2	01 U125.25.17.8
22	Pignone	-	1	-	-	01 ST120.22	75	Rondella piana	2	2	2	2	40 RP16/50ZN
22\1	Pignone	-	-	1	1	01 ST180.22	77	Dado	2	2	2	2	42 DM14ZN
23	Staffa	-	1	-	-	01 ST120.23/1	78	Rondella piana	2	2	2	2	40 RP14ZN
23\2	Staffa	-	-	1	1	01 ST120.23/2	79	Vite	2	2	2	2	41 TEM14X60ZN
24	Staffa inferiore	-	1	1	1	01 ST120.24/1	80	Ruota pneumatica	2	2	2	2	44 RG260X80
25	Carter anteriore	-	1	1	1	01 ST120.25.01/1	81	Distanziale	4	4	4	4	01 RF150.14
26	Rinvio per ST120C	-	1	-	-	09 ST120.26D	82	Perno assale	2	2	2	2	01 RF150.13
26\1	Rinvio per ST150C	-	-	1	-	09 ST150.26D	83	Rondella grover	6	6	6	6	40 RG12ZN
26\2	Rinvio per ST180C	-	-	-	1	09 ST180.26D	84	Rondella piana	2	2	2	2	40 RP12/36ZN
27	Carter superiore	-	1	1	1	01 ST120.27/1	85	Forcella ruotino	2	2	2	2	02 RF150.12
28	Anello seeger	2	2	2	2	26 SDE75	87	Vite	4	4	4	4	41 TEM12X30
29	Carter posteriore	-	1	1	1	01 ST120.25.02/1							
30	Carter inferiore	-	1	1	1	01 ST120.25.03/1	92	Semicerchio	1	-	-	-	44 CER6SV
31	Vite	-	10	10	10	41 TEM6X11ZN	93	Semicerchio	1	-	-	-	44 CER6S
32	Rondella grover	-	10	10	10	40 RG6ZN	94	Camera d'aria	2	2	2	2	44 CAR13X5.00-6
33	Rondella	1	2	2	2	40 RP10X30ZN	95	Copertura ruota	2	2	2	2	44 COP13X5.00-6
34	Anello seeger	-	1	1	1	26 SDE22	96	Rondella piana	1	-	-	-	40 RP8/32ZN
35	Linguetta	-	1	1	1	43 L6X6X25	97	Rondella grover	1	-	-	-	40 RG8ZN
36	Vite	-	2	2	2	41 TTQSTM10X40ZN	98	Vite	1	-	-	-	41 TEM8X25
37	Dado	-	1	1	1	42 DM10B	99	Linguetta	1	-	-	-	43 L6X6X35
38	Vite	-	1	1	1	41 TEM10X60ZN							
39	Cuscinetto	1	1	1	1	22 60007RS							
40	Anello seeger	1	1	1	1	26 SDE35							
41	Dado autobl.	6	10	10	10	42 DAUM10							
42	Rondella grover	-	4	4	4	40 RG10							
43	Rondella piana	-	6	6	6	40 RP10							
44	Spessore	-	1	1	1	43 SP2232025							
45	Spessore	-	1	1	1	43 SP223205							
46	Albero cardanico	-	1	1	1	32 A01700Z							

SPARE PARTS LIST N°21

GEAR BOX RATIO 1:1 - INPUT 1 3/8" Z6

gruppo destro					gruppo sinistro						
ST	ST	ST			ST	ST	ST				
120C	150C	180C			120C	150C	180C				
POS.	DENOMINAZIONE	Q	Q	Q	CODICE ARTICOLO	POS.	DENOMINAZIONE	Q	Q	Q	CODICE ARTICOLO
1	Scatola quadra	1	1	1	09 ST120.26.08						
3	Linguetta	1	1	1	43 L8X7X25						
4	Albero uscita	1	-	-	09 ST120.26.02/1						
4/1	Albero uscita	-	1	-	09 ST150.26.02/1						
4/2	Albero uscita	-	-	1	09 ST180.26.02/1						
5	Spessore	2	2	2	43 SP2535025						
6	Rondella grover	4	4	4	40 RG10						
7	Canotto prolunga	1	-	-	09 ST120.26.01						
7/1	Canotto prolunga	-	1	-	09 ST150.26.01						
7/2	Canotto prolunga	-	-	1	09 ST180.26.01						
8	Spessore	2	2	2	43 SP253505						
9	Corona z 17 r.1/1	2	2	2	09 ST120.26.07	9	Corona z 17 r.1/1	1	1	1	09 ST120.26.07
						12S	Corona z 17 r.1/1S	1	1	1	09 ST120.26.07/1
15	Albero entrata D	1	1	1	09 ST120.26.06						
16	Paraolio	1	1	1	24 PAR35477						
27	Cuscinetto	2	2	2	22 6205						
28	Paraolio	1	1	1	24 PAR25527						
29	Seeger	1	1	1	26 SDI52						
30	seeger	4	4	4	26 SDE25						
31	Tappo olio	1	1	1	70 TFM38C						
32	Linguetta	1	1	1	43 L6X6X25						
						36	Albero entrata S	1	1	1	09 ST120.26.06/1
39	Vite	4	4	4	41 TEM10x25						
55	Guarnizione	1	1	1	09 U140.01						
57	Cuscinetto	2	2	2	22 6005						
59	Seeger	1	1	1	26 SDI47						
gruppi destri completi (standard)					gruppi sinistri completi (speciali)						
26	Rinvio per ST120C	1	-	-	09 ST120.26D	26	Rinvio per ST120C	1	-	-	09 ST120.26S
26/1	Rinvio per ST150C	-	1	-	09 ST150.26D	26/1	Rinvio per ST150C	-	1	-	09 ST150.26S
26/2	Rinvio per ST180C	-	-	1	09 ST180.26D	26/2	Rinvio per ST180C	-	-	1	09 ST180.26S

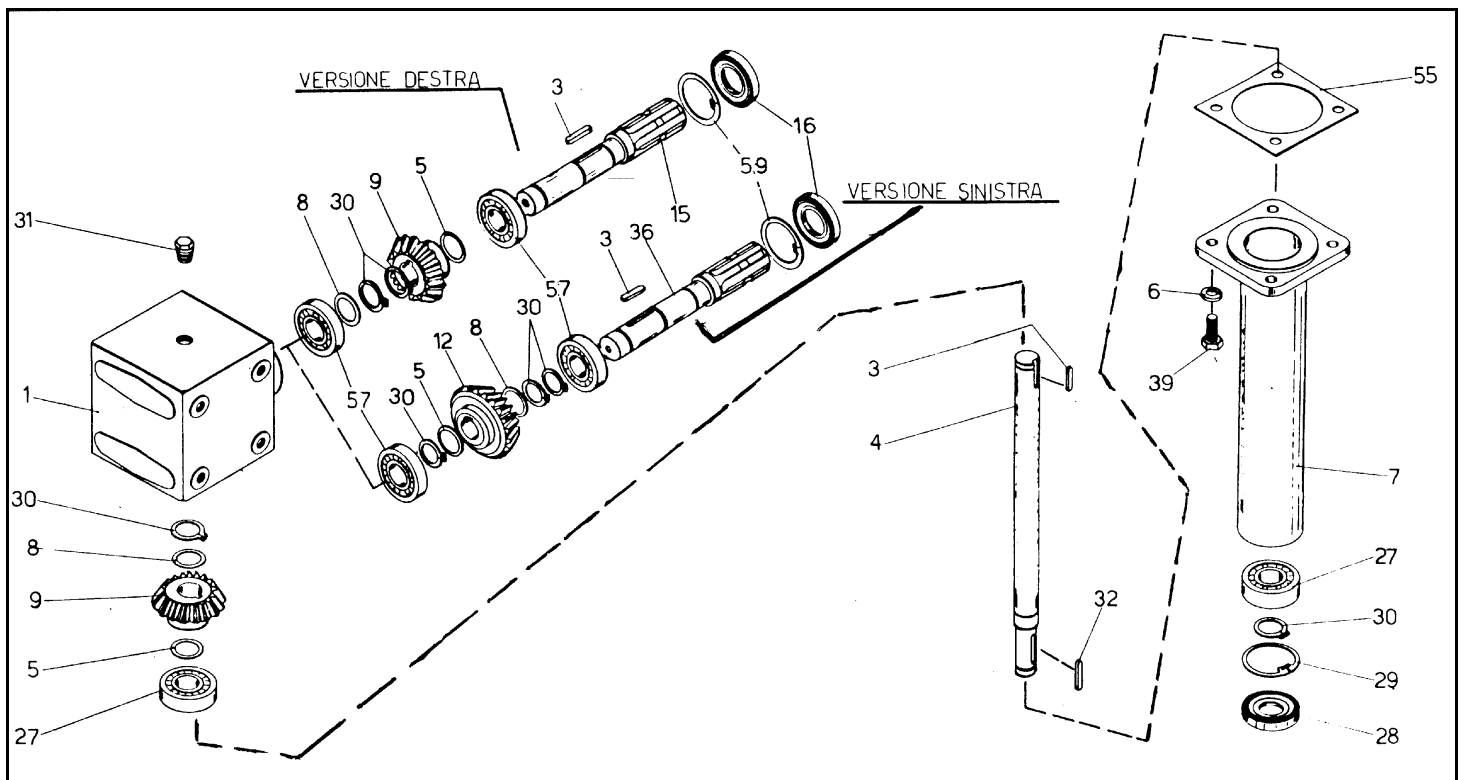

SPARE PARTS LIST N°23

WITH AUXILIARY ENGINE

POS.	DENOMINAZIONE	PEZZI		CODICE ARTICOLO	POS.	DENOMINAZIONE	PEZZI		CODICE ARTICOLO
		B&S	IH222				B&S	IH222	
1	Motore a benzina B&S 5 hp cod.132.232 avv.autoavvolgente	1	-	36 BS5AA	10\2	Carter spazzola ST180/MT	1*	1*	03 ST180.11/2
1\1	Motore a benzina 5 cv INTERMOTOR	-	1	36 IH222	11	Riduttore rapp. 1/7	1	1	09 ST120.54
2	Chiavetta per motore B&S	1	-	43 L316316112	14	Spessore	2	2	43 SP22321
2\1	Chiavetta a disco per motore IH	-	1	43 L4X9	15	Vite T.E.5/16"x 1" UNF	4	-	41 TEUNF5161
3	Campana per motore B&S	1	-	03 ST120.52	15\1	Vite T.E.	-	6	41 TEM8X30
3\1	Campana per motore IH	-	1	03 ST120.57	16	Vite T.E.5/16"x 3/4" UNF	1	-	41 TEUNF51634
4	Distanziale su motore B&S	1	-	01 ST120.55	16\1	Vite T.E.	-	1	41 TEM8X25
5	Giunto lato motore B&S	1	-	01 ST120.53	17	Vite T.E.	4	4	41 TEM8X35
5\1	Giunto lato motore IH	-	1	01 ST120.53/1	18	Rondella piana	2	2	40 RP8/32
6	Vite T.E.	7	7	41 TEM8X25ZN	22	Pignone catena per ST120MT	1	1	01 ST120.22
7	Rondella grover	16	18	40 RG8ZN	22\1	Pignone x ST150MT-ST180MT	1	1	01 ST180.22
8	Rondella piana	6	6	40 RP8ZN	27	Carter protez.catena	1	1	01 ST120.27/1
9	Giunto lato riduttore foro conico	1	1	01 ST120.53/1	34	Seeger	1	1	26 SDE22
10	Carter spazzola ST120/MT	1*	1*	03 ST120.11/2	35	Linguetta	1	1	43 L6X6X25
10\1	Carter spazzola ST150/MT	1*	1*	03 ST150.11/2	37	Dado basso	1	1	42 DM10B
					38	vite T.E.	1	1	41 TEM10X60

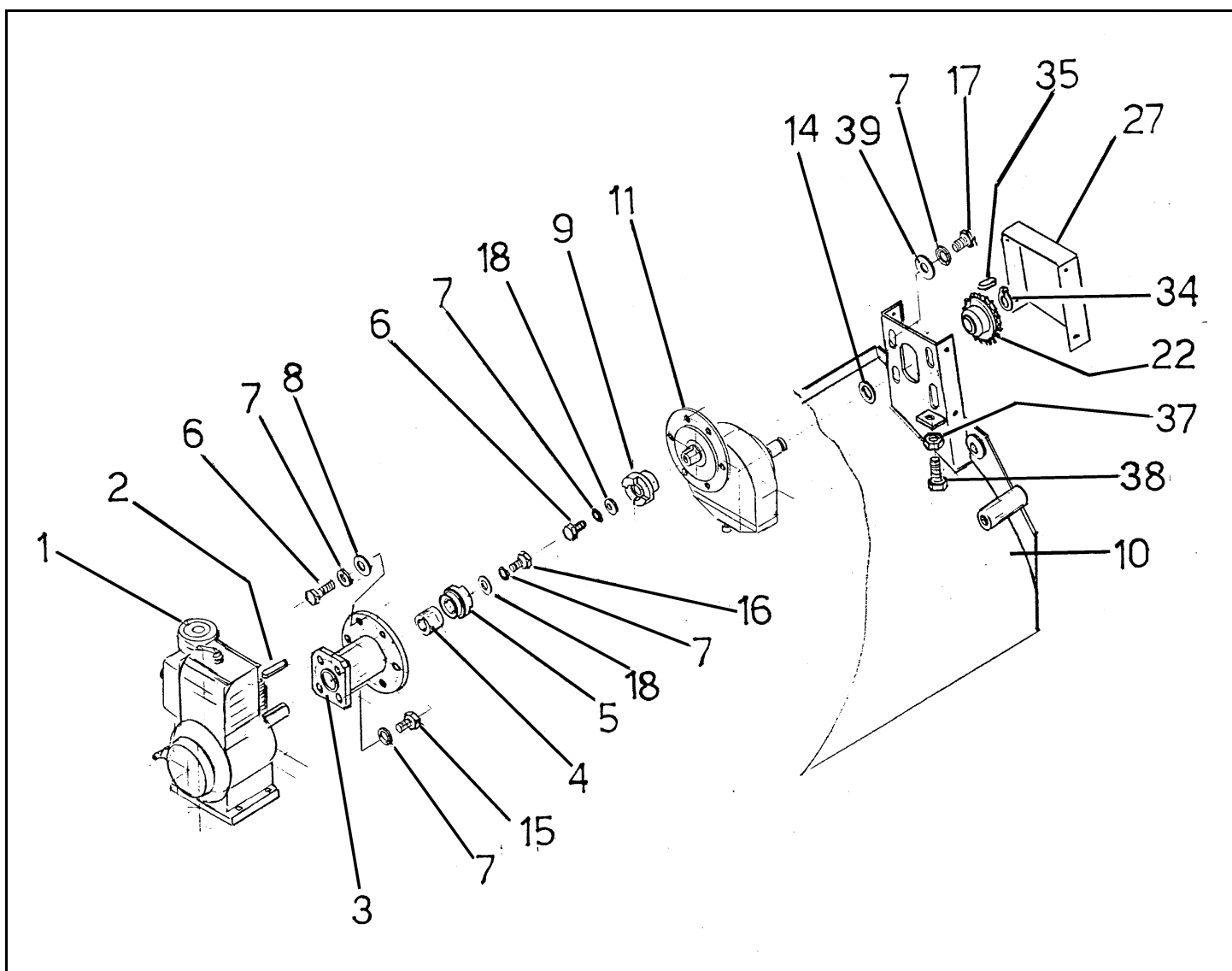

SPARE PARTS LIST N°24

WITH HYDRAULIC UNLOADING

WITH HYDRAULIC ENGINE

POS.	DENOMINAZIONE	ST	ST	ST	CODICE ARTICOLO	POS.	DENOMINAZIONE	ST	ST	ST	CODICE ARTICOLO
		120	150	180				120	150	180	
1	Telaio destro	1	1	1	03 ST120.01/8	60	Motore idraulico	1	1	1	74 BG50NC25
4	Telaio sinistro	1	1	1	03 ST120.01/8/1	61	Linguetta	1	1	1	43 L8X7X30
36	Nipplo doppio	2	2	2	70 NM14	62	Piastra attacco mot.	1	1	1	01 ST120.62
37	Tubo flessibile	2	2	2	73 T63B	63	Spessore	1	1	1	43 SP25351
38	Tubo acciaio	1	-	-	03 ST120.73	64	Rondella piana	2	2	2	40 RP10ZN
38\1	Tubo acciaio	-	1	-	03 ST150.73	65	Rondella grover	2	2	2	40 RG10ZN
38\2	Tubo acciaio	-	-	1	03 ST180.73	66	Vite T.E.	2	2	2	41 TEM10X55ZN
39	Rondella piana	2	2	2	40 RP8ZN	67	Pignone su motore	1	-	-	01 ST120.22/1
40	Dado autobloccante	2	2	2	42 DAUTM8	67\1	Pignone su motore	-	1	1	01 ST180.22/1
41	Vite T.E.	2	2	2	41 TEM8X20ZN	68	Rondella piana	1	1	1	40 RP10/40ZN
42	Perno attacco cilindro	2	2	2	01 U119.18.103	69	Carter catena	1	1	1	01 ST120.27/1
43	Copiglia a molla	4	4	4	43 C4X50	70	Carter spazzola	1	-	-	03 ST120.11/3
44	Tubo flessibile	4	4	4	73 T63A	70\1	Carter spazzola	-	1	-	03 ST150.11/3
45	Cilindro idraulico	2	2	2	10 U155.35	70\2	Carter spazzola	-	-	1	03 ST180.11/3
	vedi tavola 135					71	Vite T.E.	1	1	1	41 TEM10X60ZN
46	Rondella rame	8	8	8	70 RR14	72	Dado	1	1	1	42 DM10BZN
47	Vite per occhio	4	4	4	70 VPO14	73	Rondella piana	1	1	1	40 RP8/32ZN
48	Vite T.E.	2	2	2	41 TEM18X80	74	Rondella grover	1	1	1	40 RG8ZN
49	Dado	2	2	2	42 DM18	75	Vite T.C.E.I.	1	1	1	41 TCEIM8X30ZN
50	Cestello	1	-	-	03 ST120.30/8	76	Rondella grover	2	2	2	40 RG12ZN
50\1	Cestello	-	1	-	03 ST150.30/8	77	Dado autobloccante	2	2	2	42 DAUTM12
50\2	Cestello	-	-	1	03 ST180.30/8	78	Nipplo doppio	2	2	2	70 NRM12M38
						79	Rondella rame	2	2	2	70 RR12
						80	Tubi flessibili	2	2	2	73 T63/2C

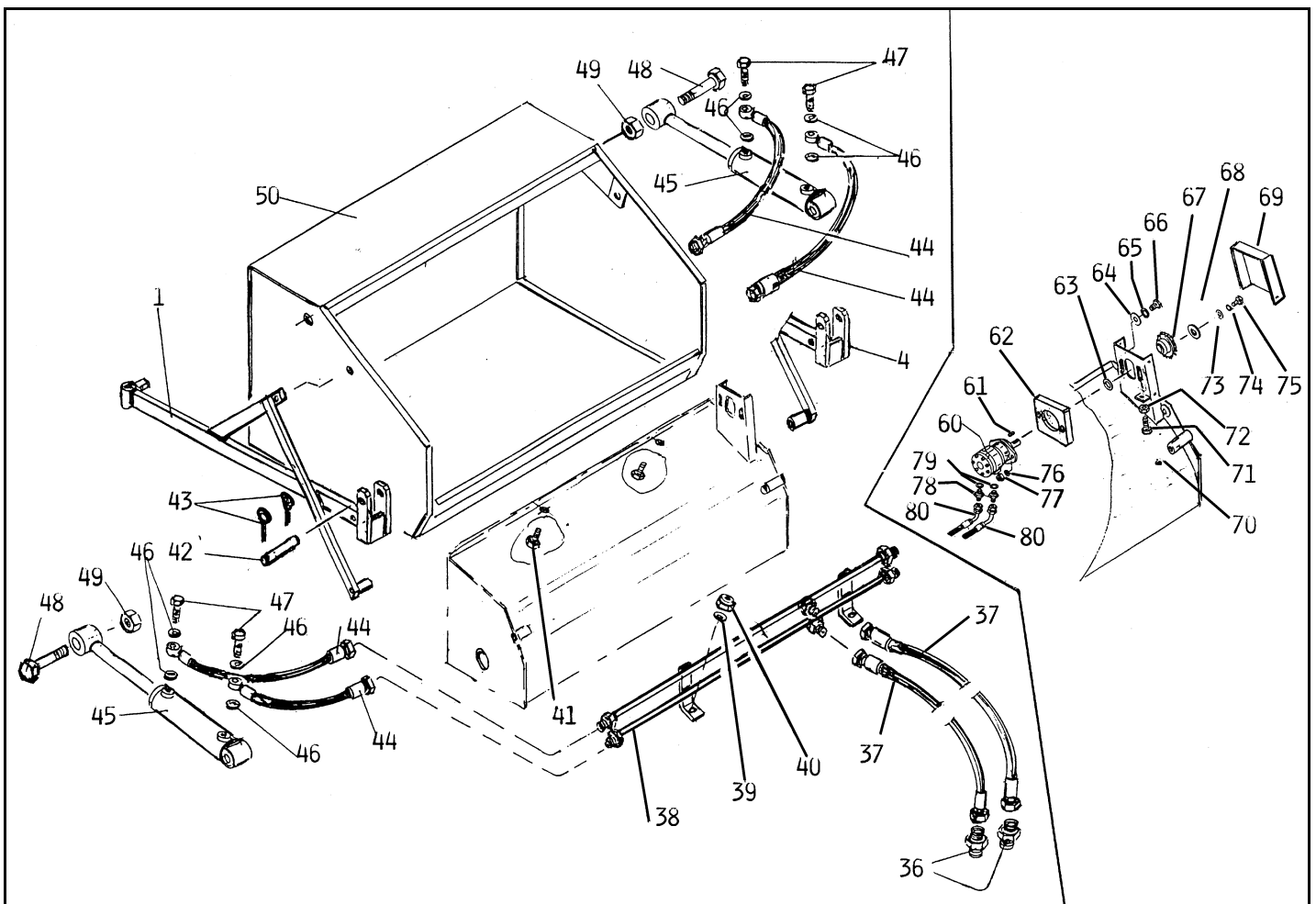

SPARE PARTS LIST N°135

CYLINDER FOR HYDRAULIC UNLOADING

POS.	DENOMINAZIONE	PEZZI	CODICE ARTICOLO
1	Camicia per cilindro ales.diam.40x corsa 245	1	10 U154.02/35
2	Stelo diam.25 per cilindro corsa 245	1	10 U154.01/35
3	Anello raschiapolvere per stelo diam.25 (*RIF.POLYPAC WRM)	1	24 WRM098129*
4	Guarnizione su testina di guida (*RIF.POLYPAC B/NEI)	1	24 B/NEI129098/1*
5	Testina di guida per stelo diam.25 /ales.40	1	10 U153/40/25
6	Guarnizione per testina di guida(**rif."A+P") (*RIF.POLYPAC OR 221)	1	24 OR4143**
8	Guarnizione tra pistone e stelo (**rif."A+P") (*RIF.POLYPAC OR 016)	1	24 OR2062**
9	Pistone per cilindro ales. diam.40	1	10 U152/40/25
10	Guarnizione su pistone diam.40 (*RIF.POLYPAC DBM)	1	24 DBM157118*
11	Dado autobloccante MB16 x 1,5	1	42 DAUTMB16X1,5
SG	Serie completa di guarnizioni per cilindro	1	24 U155/40/25
CL	Cilindro completo ales.40-st.25-corsa 245	1	10 U155.35

